

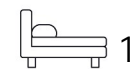

Living
made
better

Colne Road
Twickenham, TW2 6QF



Asking Price £425,000

Colne Road, Twickenham, TW2 6QF

Madison Brook

Property Summary

Set within a striking modern development on Colne Road, this stylish one-bedroom duplex spans approx. 686 sq. ft. over three levels. The ground-floor entrance leads to a first-floor bedroom with bespoke wardrobes and a sleek, fully tiled bathroom. The entire top floor is dedicated to an open-plan kitchen, living, and dining space, featuring a bespoke navy kitchen with brushed brass details, quartz worktops, and access to a private terrace. With secure gated entry, immaculate communal areas, and a prime location near transport, shops, and green spaces, this is a superb home or investment.

Service charge: £650 pa | Ground rent: £250 pa | Lease: 117 years remaining

Floorplan

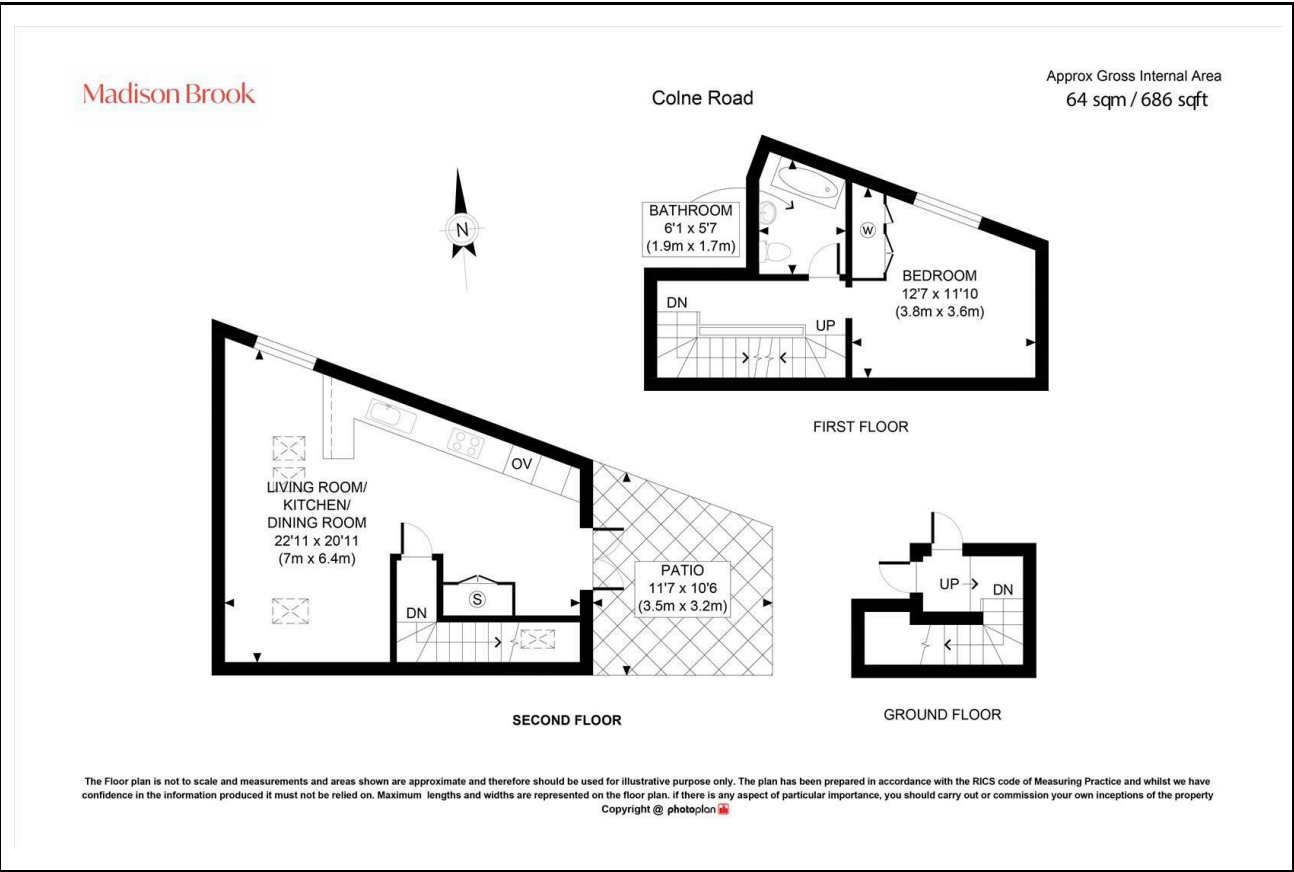

Area Map



Energy Efficiency Graph

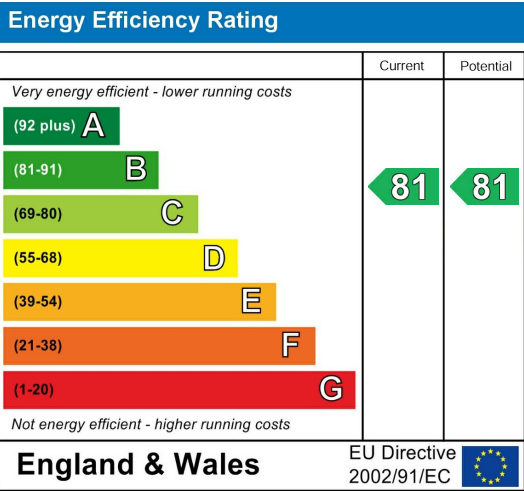

16 Church Street, Twickenham, TW1 3NJ
Tel: 020 3946 6400 Email:
twickenham@madisonbrook.com
<https://madisonbrook.com/>

These particulars, whilst believed to be accurate are set out as a general outline only for guidance and do not constitute any part of an offer or contract. Intending purchasers should not rely on them as statements of representation of fact, but must satisfy themselves by inspection or otherwise as to their accuracy. No person in this firm's employment has the authority to make or give any representation or warranty in respect of the property.