



Living
made
better

Craneford House
Twickenham, TW2 7SL



Asking Price £650,000

Craneford House, Twickenham, TW2 7SL

Madison Brook

Property Summary

Set within the upcoming Twickenham Square development and completing in early 2027, this stylish two-bedroom, two-bathroom apartment will provide approximately 757 sqft of well-appointed living space to include a bright open-plan kitchen/living area with a private balcony, en-suite to the principal bedroom, a family bathroom, and built-in hallway storage.

The apartment will also benefit from a private parking space and be ideally located within walking distance of Twickenham Station and a short cycle from Richmond Park.

Floorplan

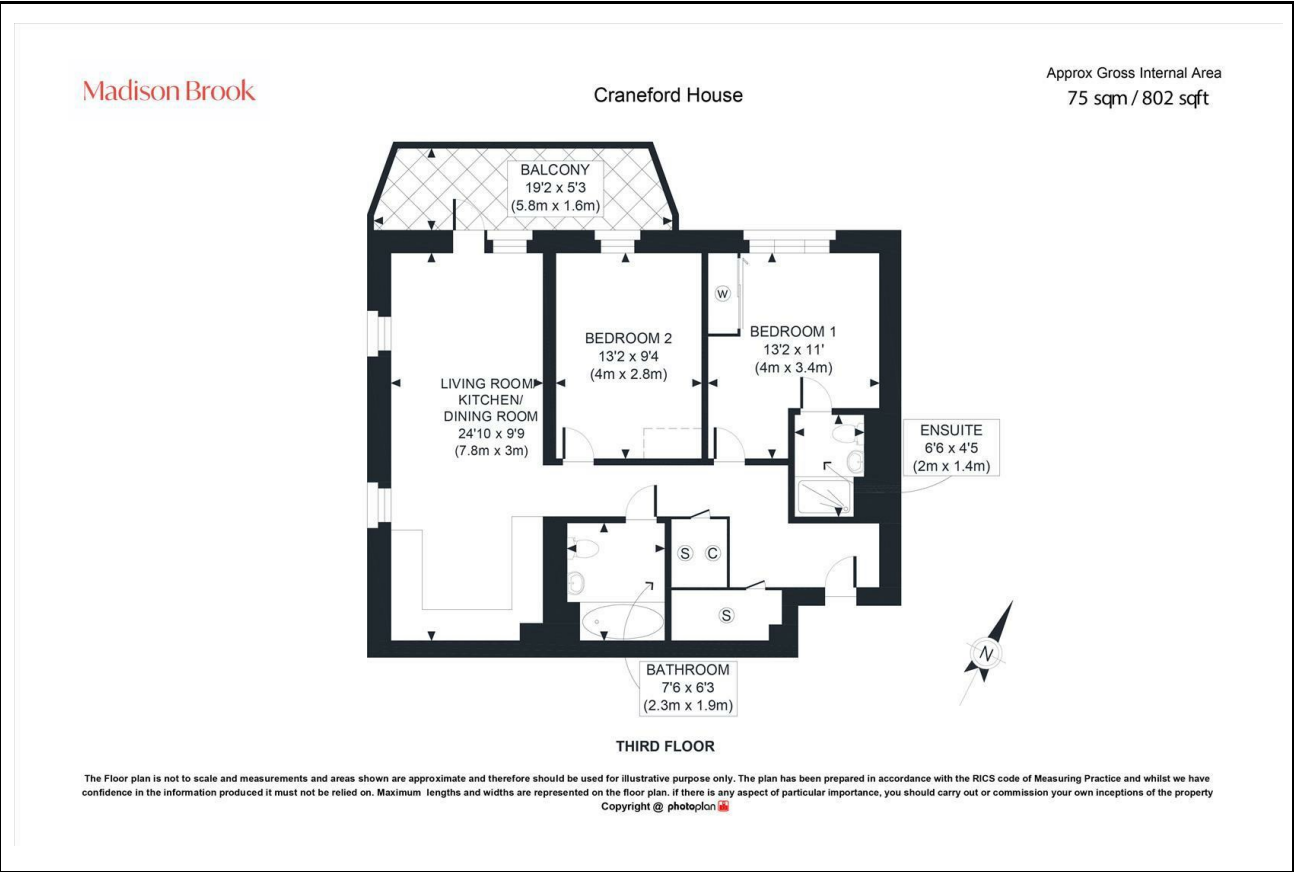

Area Map

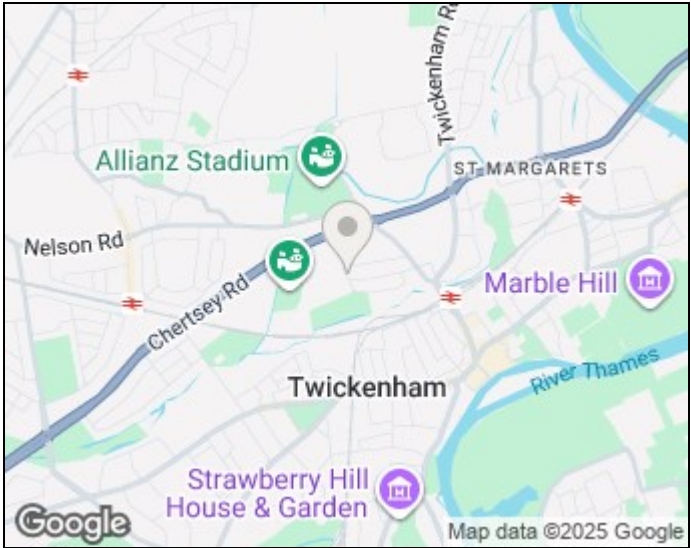

Energy Efficiency Graph

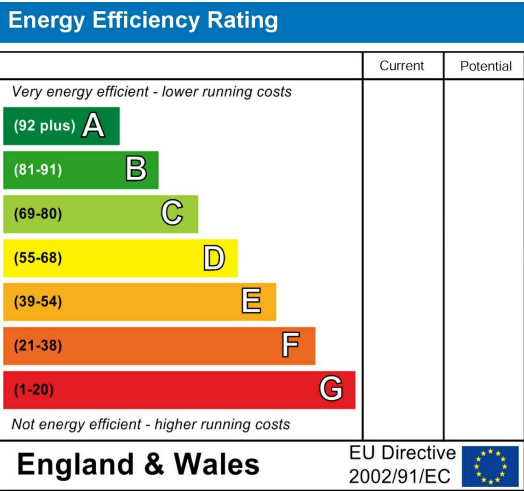

These particulars, whilst believed to be accurate are set out as a general outline only for guidance and do not constitute any part of an offer or contract. Intending purchasers should not rely on them as statements of representation of fact, but must satisfy themselves by inspection or otherwise as to their accuracy. No person in this firm's employment has the authority to make or give any representation or warranty in respect of the property.

16 Church Street, Twickenham, TW1 3NJ
Tel: 020 3946 6400 Email:
twickenham@madisonbrook.com
<https://madisonbrook.com/>