

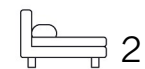

Living
made
better

Highfield Road
Feltham, TW13 4GS



Price Guide £260,000

Highfield Road, Feltham TW13 4GS

Madison Brook

Spacious Two-Bedroom Flat in Central Feltham.

Located in the heart of Feltham, this well-presented two-bedroom, two-bathroom flat in Berberis House offers modern living with exceptional convenience. The property features a master bedroom with an en-suite, a second double bedroom, a family bathroom, and a spacious lounge leading to a fully equipped kitchen, making it ideal for comfortable living and entertaining.

Its prime location places you close to local schools, shops, and amenities, while excellent transport links, including nearby Feltham train station, provide direct access to central London. With a long lease of 135 years, a ground rent of £250, and a service charge of £3,228, this property is a fantastic opportunity for first-time buyers or investors.

Offered with no onward chain, this home ensures a smooth and straightforward purchase. Viewing is highly recommended to appreciate the full potential of this modern and vibrant residence.



Floorplan

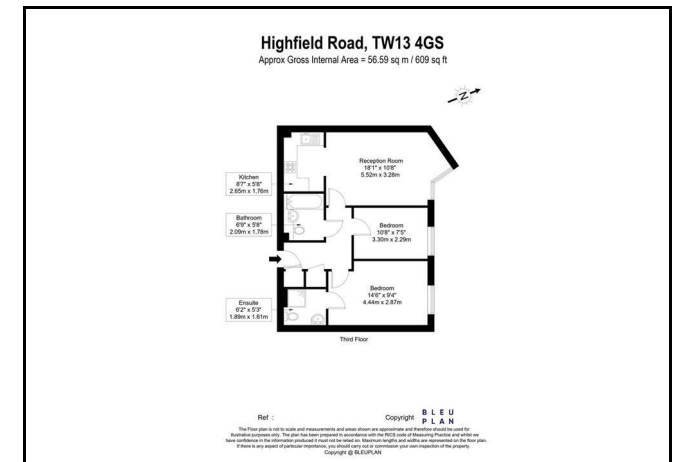

Area Map



Energy Efficiency Graph

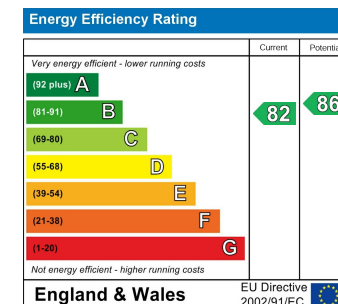

16 Church Street, Twickenham, TW1 3NJ

Tel: 020 3946 6400 Email: twickenham@madisonbrook.com <https://madisonbrook.com/>