



Lemon Grove  
, Feltham, TW13 4DH

Offers In The Region Of £295,000



**MADISON BROOK**  
INTERNATIONAL



# Lemon Grove, Feltham, TW13 4DH

A beautifully presented, modern, fourth floor apartment located in Belvedere House.

This property comprises of two double bedrooms, a light and airy spacious reception room with a separate kitchen and a generous sized modern family bathroom. The property boasts an abundance of natural light with the windows expanding over the full width of the reception room. There is also ample built in storage throughout.

Belvedere house is ideally located just off of the high street, offering easy access to all of the local amenities., The property is conveniently located next to a large Asda and close to Feltham's centre retail park, offering multiple shops, cafes and restaurants. Feltham train station is a 5 minute walk away, which has direct access to London's Waterloo.



These particulars, whilst believed to be accurate are set out as a general outline only for guidance and do not constitute any part of an offer or contract. Intending purchasers should not rely on them as statements of representation of fact, but must satisfy themselves by inspection or otherwise as to their accuracy. No person in this firms employment has the authority to make or give any representation or warranty in respect of the property.

16 Church Street, Twickenham, TW1 3NJ

Tel: 020 3946 6400 Email: [twickenham@madisonbrook.com](mailto:twickenham@madisonbrook.com) <https://madisonbrook.com/>

## Floor Plan

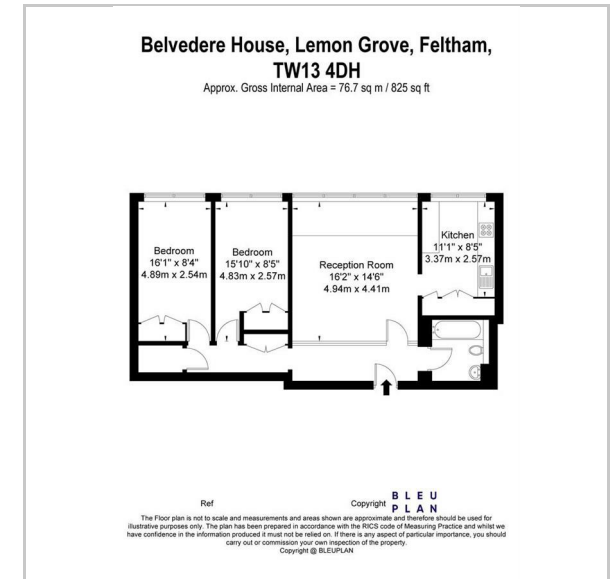

## Area Map



## Energy Efficiency Graph

