

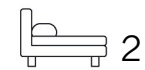

Living
made
better

Clements Court
Hounslow, TW4 6EB



Asking Price £230,000

Clements Court, Hounslow TW4 6EB

Madison Brook

Spacious Two-Bedroom Apartment in Hounslow.

Located near Hounslow Heath, this two-bedroom ground-floor apartment in Clements Court offers comfortable living in a well-connected setting. The property features two generous bedrooms, a spacious separate lounge, and a fully equipped kitchen. Large windows fill the space with natural light, creating a bright and welcoming atmosphere.

Residents benefit from dedicated parking, while the prime location ensures easy access to Heathrow Airport, Hounslow town centre, and excellent transport links. With a leasehold tenure of 118 years, a ground rent of £10 per annum, and a service charge of £110 per annum, this apartment is attractively priced to reflect its non-EWS1 compliant status and is available exclusively to cash buyers.

This property presents an excellent investment opportunity for those seeking a residence in a vibrant and convenient area. Viewing is highly recommended to appreciate the value and potential of this apartment. Contact Madison Brook today to arrange a visit.



Floorplan

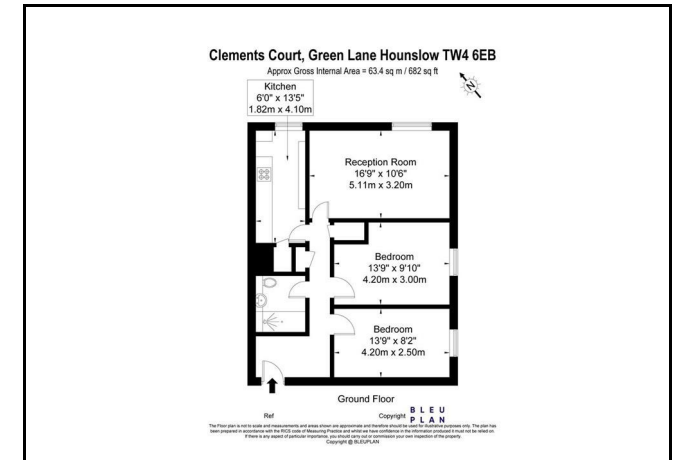

Area Map

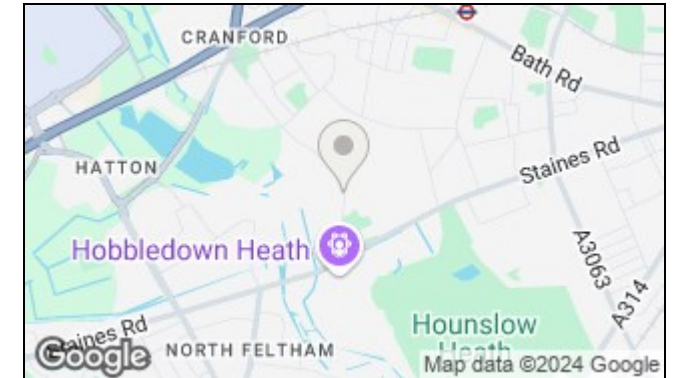

Energy Efficiency Graph

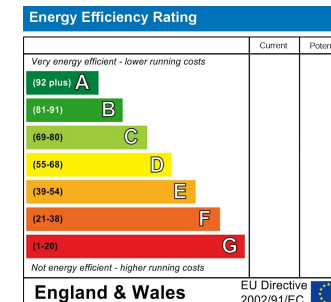

These particulars, whilst believed to be accurate are set out as a general outline only for guidance and do not constitute any part of an offer or contract. Intending purchasers should not rely on them as statements of representation of fact, but must satisfy themselves by inspection or otherwise as to their accuracy. No person in this firm's employment has the authority to make or give any representation or warranty in respect of the property.

16 Church Street, Twickenham, TW1 3NJ

Tel: 020 3946 6400 Email: twickenham@madisonbrook.com <https://madisonbrook.com/>