



Clements Court

Green Lane, Hounslow, TW4 6EB

Offers In The Region Of £240,000



MADISON BROOK
INTERNATIONAL

Clements Court, Green Lane, Hounslow, TW4 6EB

A well proportioned 2 bedroom apartment set within this purpose built block close to Hounslow Heath.

Offering two generous sized bedrooms and large separate lounge & kitchen. The apartment benefits from residents parking as well having large windows flooding the apartment with natural light. It is also well located for access to Heathrow as well as being a short distance away from Hounslow for access to shops and public transport.



These particulars, whilst believed to be accurate are set out as a general outline only for guidance and do not constitute any part of an offer or contract. Intending purchasers should not rely on them as statements of representation of fact, but must satisfy themselves by inspection or otherwise as to their accuracy. No person in this firms employment has the authority to make or give any representation or warranty in respect of the property.

16 Church Street, Twickenham, TW1 3NJ
 Tel: 020 3946 6400 Email: twickenham@madsinbrook.com <https://madsinbrook.com/>

Floor Plan

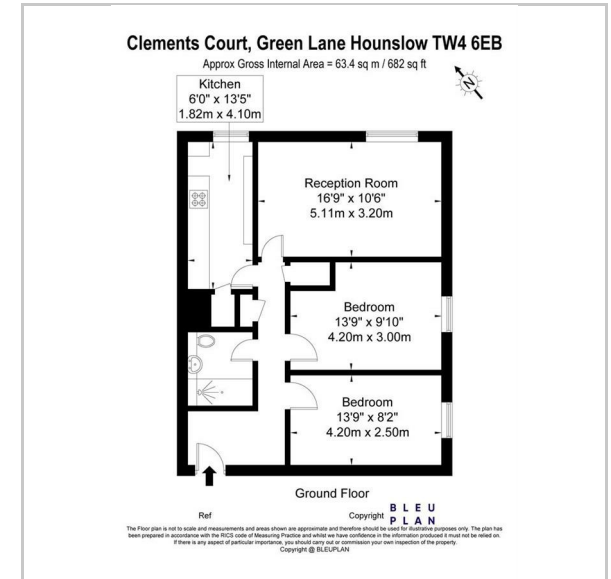

Area Map

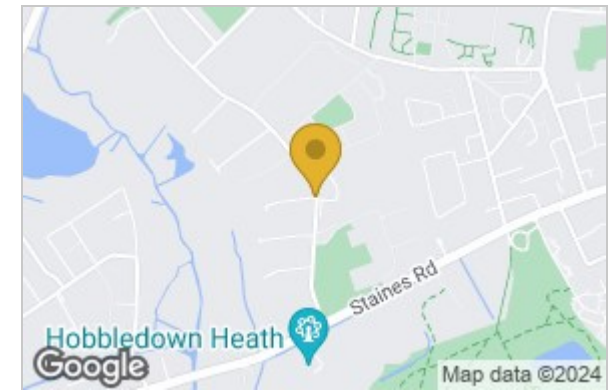

Energy Efficiency Graph

