



Living
made
better

Harlech Gardens
Hounslow, TW5 9PR



Asking Price £285,000

Harlech Gardens, Hounslow, TW5 9PR

Madison Brook

Property Summary

Located on the first floor of a purpose-built block, this spacious two-bedroom apartment features a large reception room, separate kitchen, and two double bedrooms. The property benefits from secure entry, communal gardens with a play area, and ample parking.

Conveniently positioned for Hounslow West Underground Station and Overground connections from Southall and Hayes & Harlington, the property is also within easy reach of Heathrow Airport.

Floorplan

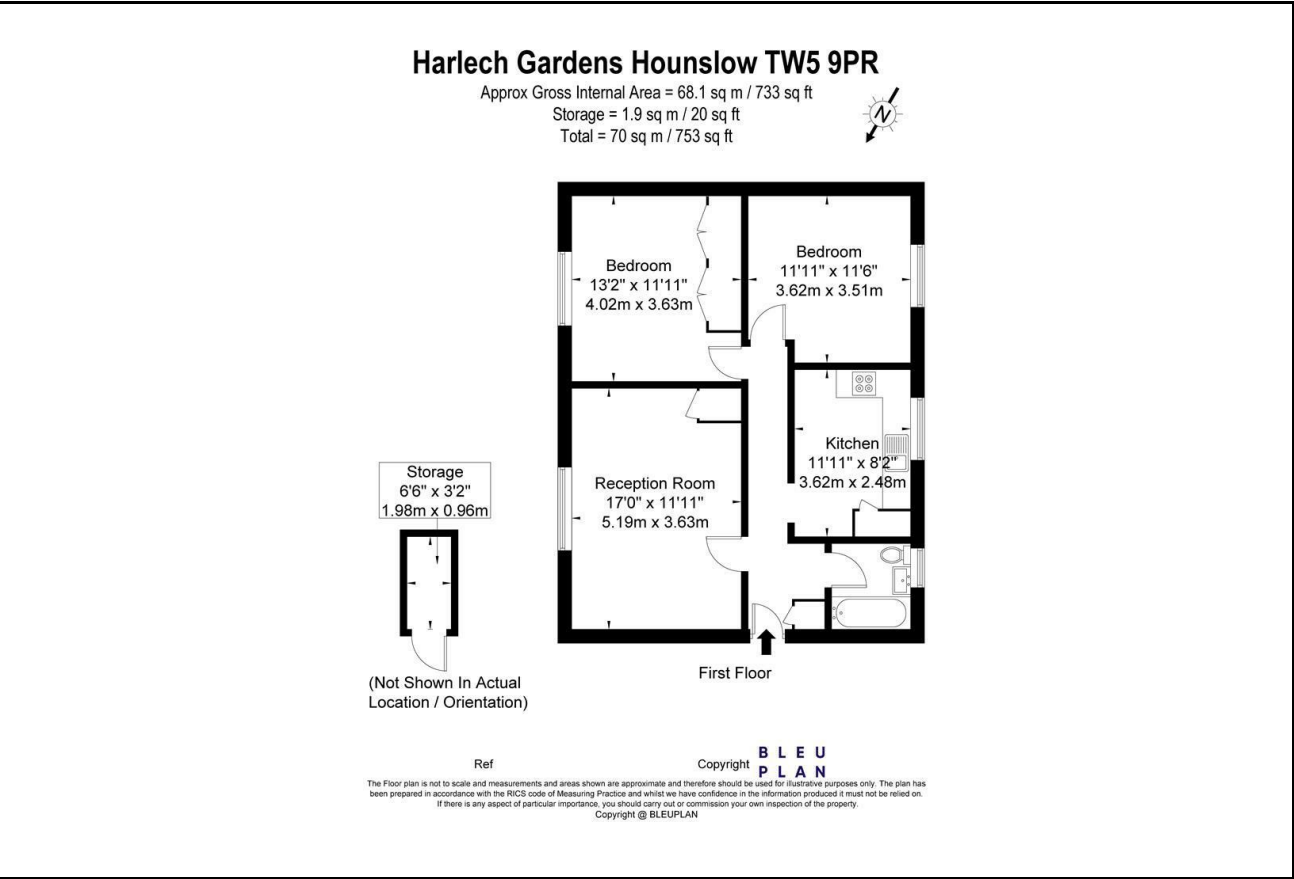

Area Map

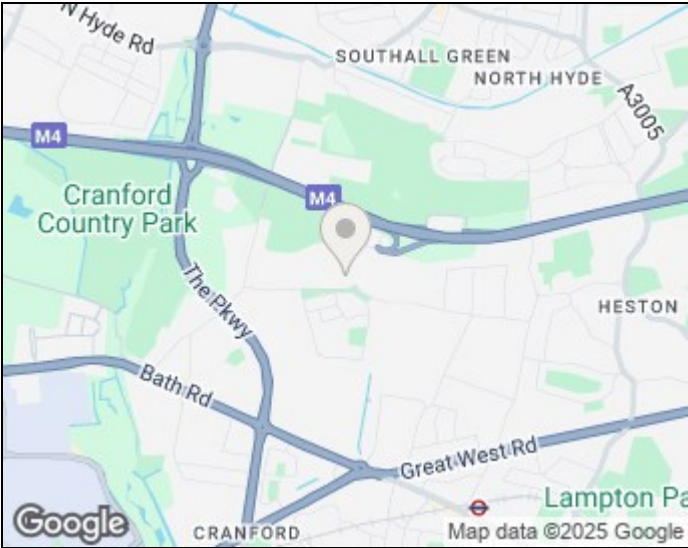

Energy Efficiency Graph

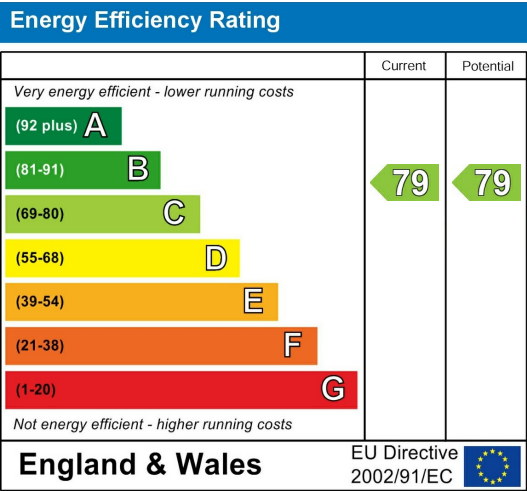

These particulars, whilst believed to be accurate are set out as a general outline only for guidance and do not constitute any part of an offer or contract. Intending purchasers should not rely on them as statements of representation of fact, but must satisfy themselves by inspection or otherwise as to their accuracy. No person in this firms employment has the authority to make or give any representation or warranty in respect of the property.

16 Church Street, Twickenham, TW1 3NJ
Tel: 020 3946 6400 Email: twickenham@madisonbrook.com
<https://madisonbrook.com/>