



44 GLANVILLE ROAD

Hadleigh

| Suffolk



Chapman Sticks



# 44 GLANVILLE ROAD HADLEIGH, SUFFOLK IP7 5SQ

A TWO BEDROOM SEMI-DETACHED HOME IN A PEACEFUL POSITION  
CLOSE TO THE TOWN CENTRE WITH PARKING AND GARDEN

Colchester - 14 miles

Ipswich - 9 miles

Manningtree - 9 miles

- Entrance hall • Sitting room • Kitchen / dining room • Two bedrooms •
- Family bathroom • Garden • Off-road parking •





### The Property

Located in a quiet position along a no through road, 44 Glanville Road is an attractive two bedroom semi-detached house which has been upgraded and modernised by the current owners during their ownership since 2014 resulting in a pleasing and practical home. The upgrade includes works such as the installation of a new Baxi combi boiler and radiators, some new windows, an upgraded bathroom, and an additional (2nd) bedroom has been cleverly created on the first floor.

An entrance hall provides access to the ground floor accommodation comprising a sitting room with glazed doors to the rear garden, family bathroom, and kitchen / dining room with base level units, integrated electric hob and oven, and plumbing for a washing machine and dishwasher.

On the first floor there are two bedrooms. Any available space has been cleverly used as wardrobes and storage.

Outside, to the rear lies a fully enclosed lawned garden with sun terrace, and a side gate providing access to the driveway which provides parking for at least two vehicles.

### Location

Conveniently located for all the town's amenities, Hadleigh is a very popular historic market town situated about 9 miles west from Ipswich. The bustling town centre offers a wide range of local amenities including restaurants, pubs, sports facilities, and a wide selection of shops, as well as both Junior and Senior schools.

### Services

All mains services are connected.

### EPC Rating

Current C (73). Potential B (89).

Local Authority and Council Tax  
Babergh & Mid Suffolk District Council  
Band B (2024)





44 Glanville Road, Hadleigh IP7 5SQ

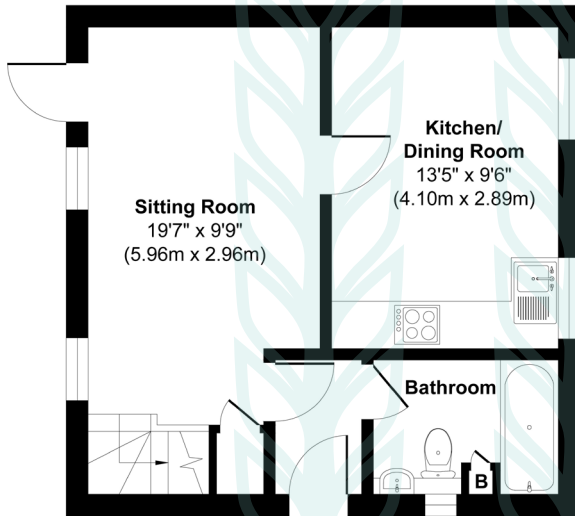

**Ground Floor**  
Approximate Floor Area  
385 sq. ft (35.76 sq. m)

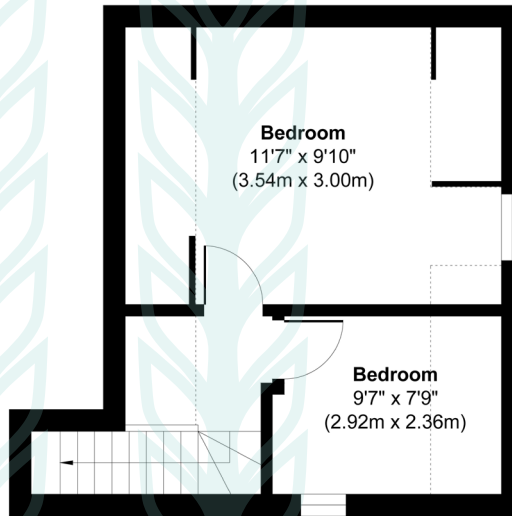

**First Floor**  
Approximate Floor Area  
220 sq. ft (20.46 sq. m)

**Approx. Gross Internal Floor Area 605 sq. ft / 56.22 sq. m.**  
Illustration for identification purposes only, measurements approximate, not to scale. Copyright



**Chapman Stickels**

The Corn Exchange,  
Market Place,  
Hadleigh,  
Suffolk,  
IP7 5DN

info@chapmanstickels.co.uk  
www.chapmanstickels.co.uk

01473 372 372

**All enquiries:**

**Benedict Stickels**  
ben@chapmanstickels.co.uk

**Cleo Shiel**  
cleo@chapmanstickels.co.uk



Scan this QR code  
to view a virtual tour of the property



**IMPORTANT NOTICE**  
Chapman Stickels states these particulars are for general information only and do not constitute an offer or contract or part thereof. All descriptions, photographs and plans are for guidance only and should not be relied upon as statements or representations of fact. All measurements are approximate where stated. Any prospective purchaser must satisfy themselves of the accuracy of the information within these particulars by inspection or otherwise. Chapman Stickels does not have any authority to give any representations or warranties whatsoever in relation to this property (including but not limited to planning/building restrictions), nor can it enter into any contract on behalf of the client. We do not accept responsibility for any expenses incurred by prospective purchasers in inspecting properties which have been sold, let or withdrawn. If there is anything of particular importance to you, please contact us where we will endeavour to have any information or queries checked.