



75 BRETT GREEN

Layham | Suffolk



Chapman Stickels

75 BRETT GREEN LAYHAM, SUFFOLK IP7 5LX

CHAIN FREE - A WELL-PROPORTIONED THREE BEDROOM TERRACED HOUSE DISCREETLY POSITIONED IN A RURAL LOCATION WITH GARDEN, GARAGE AND OFF-ROAD PARKING

Hadleigh - 1.5 miles

Ipswich - 10 miles

Colchester - 13 miles

-
- Entrance hall • Sitting / dining room • Cloakroom • Three bedrooms •
 - Family bathroom • Garden • Off-road parking • Garage •





The Property

75 Brett Green forms part of a small development set in a peaceful location, in the sought-after Suffolk village of Layham.

The accommodation is well-proportioned, offering a practical layout with a welcoming entrance hall which leads to the downstairs accommodation comprising a kitchen providing various eye and base level units combined with wood effect worktops, and a large window overlooking a communal green area to the front. Beyond the kitchen lies a generous sitting/ dining room with French doors to the fully enclosed and private rear garden, and a cloakroom.

On the first floor, a spacious landing with airing cupboard and loft hatch provides access to three bedrooms and a family bathroom. The two double bedrooms benefit from built in wardrobes.

Outside to the front of the house is a pleasant communal green area with a footpath leading to the single garage a few yards away (in a block), and to the rear of the house lies a private and fully enclosed garden.

Agents Note

A pedestrian right of access exists over the neighbouring garden.

Location

75 Brett Green is located approximately 1 mile from the popular historic market town of Hadleigh which is situated about 9 miles from Ipswich, 9 miles from Manningtree and about 14 miles from Colchester – all having main line services for London's Liverpool Street station. The bustling town centre of Hadleigh offers a wide range of local amenities including restaurants, pubs, sports facilities and a good selection of shops.

Services

Mains electricity, water and drainage connected.

EPC

Current C (70). Potential B (86).

75 Brett Green, Layham, IP7 5LX

Approximate Floor Area

Main House - 913 sq. ft / 84.89 sq. m

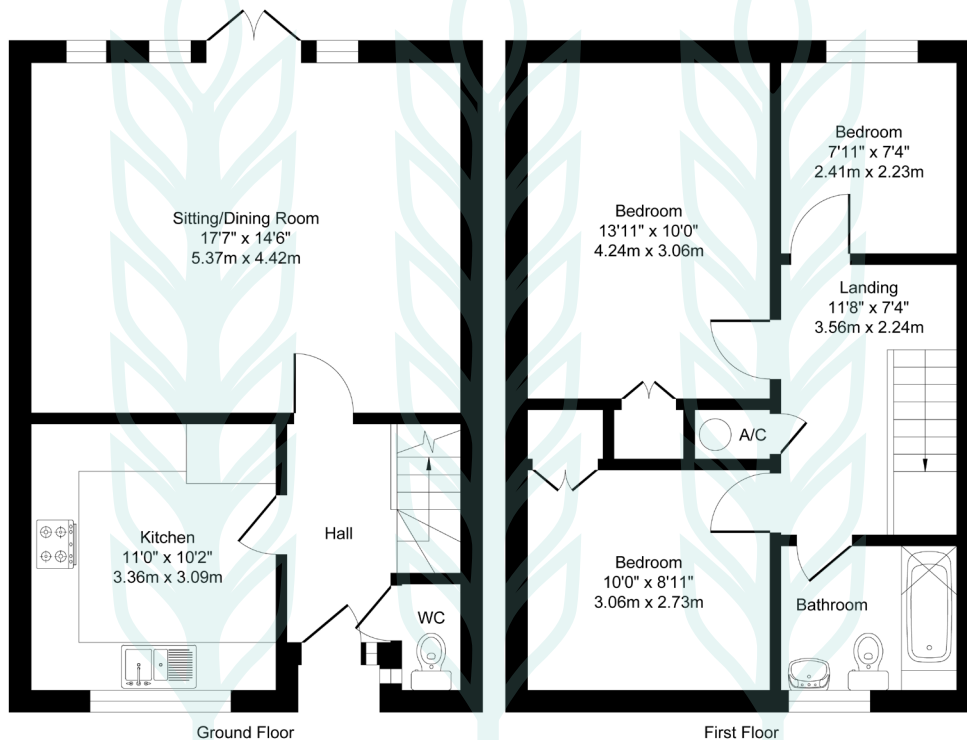

Illustration for identification purposes only, measurements approximate, not to scale. Copyright



Chapman Sticksels

The Corn Exchange,
Market Place,
Hadleigh,
Suffolk,
IP7 5DN

info@chapmansticksels.co.uk
www.chapmansticksels.co.uk

01473 372 372

All enquiries:

Benedict Sticksels
ben@chapmansticksels.co.uk

Cleo Shiel
cleo@chapmansticksels.co.uk



Scan the QR code to visit our website



rightmove

PrimeLocation.com

OnTheMarket.com

Zoopla



IMPORTANT NOTICE
Chapman Sticksels states these particulars are for general information only and do not constitute an offer or contract or part thereof. All descriptions, photographs and plans are for guidance only and should not be relied upon as statements or representations of fact. All measurements are approximate where stated. Any prospective purchaser must satisfy themselves of the accuracy of the information within these particulars by inspection or otherwise. Chapman Sticksels does not have any authority to give any representations or warranties whatsoever in relation to this property (including but not limited to planning/building restrictions), nor can it enter into any contract on behalf of the client. We do not accept responsibility for any expenses incurred by prospective purchasers in inspecting properties which have been sold, let or withdrawn. If there is anything of particular importance to you, please contact us where we will endeavour to have any information or queries checked.