



# 10 NORTHCOTE DRIVE

Monks | Leigh | Suffolk



Chapman Sticks

# 10 NORTHCOTE DRIVE, MONKS ELEIGH, SUFFOLK IP7 7NS

A MODERN TWO BEDROOM END TERRACE HOME WITH SECLUDED  
GARDEN AND OFF-ROAD PARKING

Hadleigh – 6 miles

Sudbury – 8 miles

Bury St Edmunds – 16 miles

- 
- Entrance hall • Cloakroom • Sitting / dining room • Kitchen • Two double bedrooms •
  - Family bathroom • Secluded garden • Off-road parking •







### The Property

10 Northcote Drive is a two-bedroom end terrace house which forms part of a small development in the rural parish of Monks Eleigh.

A welcoming entrance hall leads into a bright and spacious sitting / dining room which benefits from double glazed doors leading out onto the secluded rear garden. The kitchen is fitted with a range of base and eye level units and worksurfaces. New appliances include oven and gas hob, washing machine and fridge / freezer.



On the first floor a landing provides access to two double bedrooms, airing cupboard and a family bathroom. Bedroom one benefits from far reaching countryside views.

Outside, the secluded rear garden is mainly laid to lawn with a sun terrace. A side gate provides access to the front of the property, where off-road parking is available for two vehicles.

### Location

Monks Eleigh is an attractive village set within the Suffolk countryside, with a popular pub and community shop / post office. The excellent Hollow Trees Farm Shop is nearby with the market towns of Hadleigh and Sudbury both within easy reach.

### Services

We understand mains drainage, water and electricity are connected. LPG Gas central heating.

### Local Authority and Council Tax Band

Babergh with Mid Suffolk District Council  
TBA

### EPC Rating

Current C(76). Potential B(91)



# 10 Northcote Drive, Monks Eleigh, IP7 7NS

Approximate Floor Area

Main House - 875 sq. ft / 81.26 sq. m

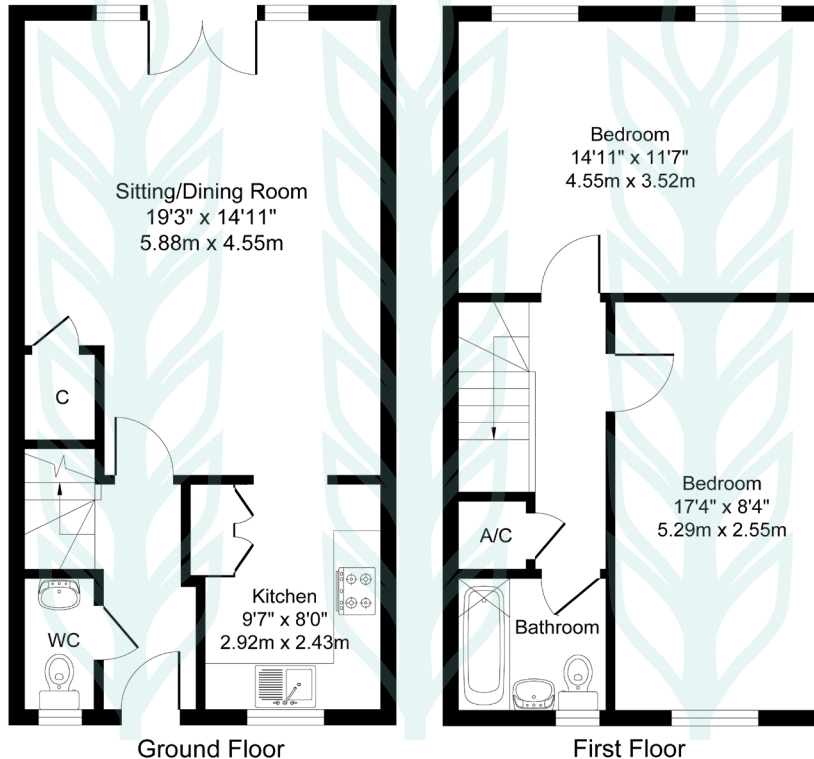

Illustration for identification purposes only, measurements approximate, not to scale. Copyright

## Chapman Sticksels

The Corn Exchange,  
Market Place,  
Hadleigh,  
Suffolk,  
IP7 5DN

info@chapmansticksels.co.uk  
www.chapmansticksels.co.uk

01473 372 372

## All enquiries:

**Benedict Sticksels**  
ben@chapmansticksels.co.uk

**Cleo Shiel**  
cleo@chapmansticksels.co.uk



Scan the QR code to visit our website



rightmove

PrimeLocation.com

onTheMarket.com

Zoopla



IMPORTANT NOTICE  
Chapman Sticksels states these particulars are for general information only and do not constitute an offer or contract or part thereof. All descriptions, photographs and plans are for guidance only and should not be relied upon as statements or representations of fact. All measurements are approximate where stated. Any prospective purchaser must satisfy themselves of the accuracy of the information within these particulars by inspection or otherwise. Chapman Sticksels does not have any authority to give any representations or warranties whatsoever in relation to this property (including but not limited to planning/building restrictions), nor can it enter into any contract on behalf of the client. We do not accept responsibility for any expenses incurred by prospective purchasers in inspecting properties which have been sold, let or withdrawn. If there is anything of particular importance to you, please contact us where we will endeavour to have any information or queries checked.