



# TUMPS COTTAGE

Hadleigh | Suffolk



Chapman Sticks



# TUMPS COTTAGE SPOONERS LANE HADLEIGH IP7 5EZ

AN INDIVIDUAL THREE-BEDROOM DETACHED BUNGALOW LOCATED IN  
THE TOWN CENTRE TOGETHER WITH OFF-ROAD PARKING, GARAGE AND  
GARDENS

Colchester - 13 miles

Manningtree - 9 miles

Ipswich - 10 miles

- 
- Front porch • Entrance hall • Cloakroom • Double reception room • Kitchen •
  - Three bedrooms • Shower room • Ample off-road parking • Gardens •





### The Property

Located in the centre of Hadleigh, Tumps Cottage is one of just two other bungalows that could not be more centrally placed in the town. Moreover, the property is discreetly positioned off Magdalen Road, and therefore it does not front onto the highway.

Despite requiring some cosmetic updating, the accommodation provides a practical and pleasing layout, comprising an entrance hall with cloakroom off, which leads through to a spacious and open plan, twin aspect sitting / dining room. The adjacent kitchen is fitted on two walls, providing work surfaces, integral appliances and numerous cupboards and drawers. The three bedrooms are set around an inner hall, which are all served by a rear shower room.



Outside, the property offers off-road parking via a brick weave driveway which leads to an attached single garage. A patio to the front leads to one side, giving access to the part walled, rear garden which is generally laid to lawn with a further patio. The garden also offers a good deal of privacy and seclusion.

### Services

We understand all mains services are connected.

### Location

Positioned in the town centre, the property is a stone's throw from all of Hadleigh's wide range of amenities, which includes restaurants, pubs, sports facilities and a wide selection of shops.

**Local Authority and Council Tax**  
Babergh & Mid Suffolk District Council  
Band C - (2024)





## Tumps Cottage, Spooners Lane, Hadleigh, Suffolk, IP7 5EZ

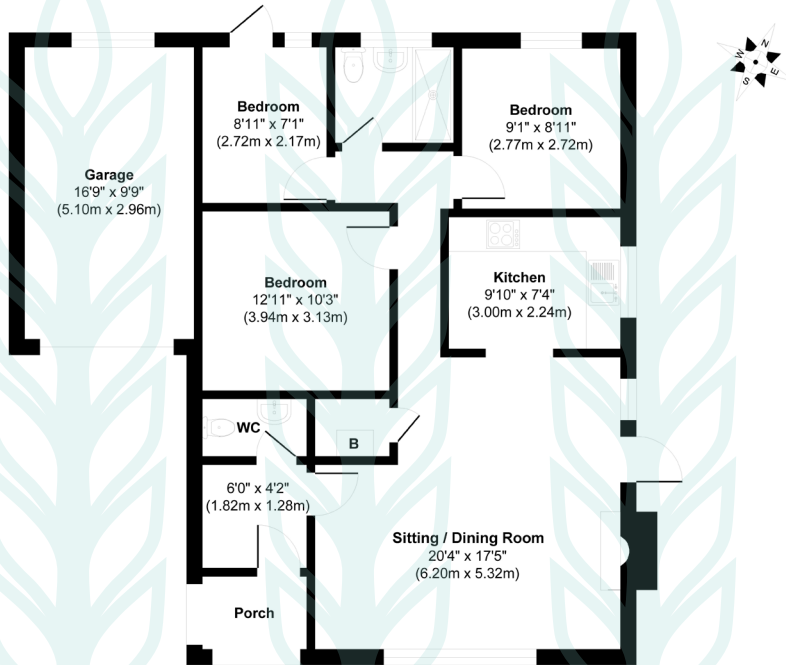

### Chapman Stickels

The Corn Exchange,  
Market Place,  
Hadleigh,  
Suffolk,  
IP7 5DN

info@chapmanstickels.co.uk  
www.chapmanstickels.co.uk

01473 372 372

### All enquiries:

#### Benedict Stickels

ben@chapmanstickels.co.uk

#### Cleo Shiel

cleo@chapmanstickels.co.uk



Scan the QR code to visit our website



rightmove

PrimeLocation.com

onTheMarket.com

Zoopla



**IMPORTANT NOTICE**  
Chapman Stickels states these particulars are for general information only and do not constitute an offer or contract or part thereof. All descriptions, photographs and plans are for guidance only and should not be relied upon as statements or representations of fact. All measurements are approximate where stated. Any prospective purchaser must satisfy themselves of the accuracy of the information within these particulars by inspection or otherwise. Chapman Stickels does not have any authority to give any representations or warranties whatsoever in relation to this property (including but not limited to planning/building restrictions), nor can it enter into any contract on behalf of the client. We do not accept responsibility for any expenses incurred by prospective purchasers in inspecting properties which have been sold, let or withdrawn. If there is anything of particular importance to you, please contact us where we will endeavour to have any information or queries checked.