



# THE WHITE HOUSE

Brent Eleigh | Suffolk



Chapman Stickels

# THE WHITE HOUSE 1 THE GLEBE BRENT ELEIGH CO10 9PP

CHAIN FREE - A FOUR BEDROOM DETACHED HOUSE OFFERING A  
RENOVATION OPPORTUNITY IN A RURAL LOCATION WITH  
GARDENS AND A DOUBLE GARAGE

Lavenham - 2 miles

Hadleigh - 7 miles

Bury St Edmunds - 13 miles

Ipswich - 16 miles

- 
- Entrance hall • Two reception rooms • Kitchen / dining room •
  - Cloakroom • Four bedrooms • Family bathroom •
  - Off-road parking • Gardens • Double garage •





**The Property**  
The White House offers an exciting refurbishment opportunity located in the sought after village of Brent Leigh, Suffolk.

Located in a peaceful setting at the end of a no through road, forming part of a small bespoke cul-de-sac of just four other houses, The White House stands in an elevated position within its generous plot. The property has been under the same ownership for approximately 40 years and presents a renovation opportunity to anyone looking to create a good family home.

**Location**  
Suffolk's Brent Leigh is a small hamlet not far from the medieval weaving village of Lavenham approximately 2.1 miles away, which has an excellent range of day-to-day shopping facilities, pubs and restaurants. The smaller village of Monks Eleigh is about 1.3 miles to the west.

**Services**  
Mains electricity and water are connected. Oil fired central heating to radiators. Private drainage - Binders inspection report available upon request.

**Local Authority and Council Tax Band**  
Babergh with Mid Suffolk District Council  
Band E (2024).

**EPC Rating**  
Current E (41). Potential B (85).

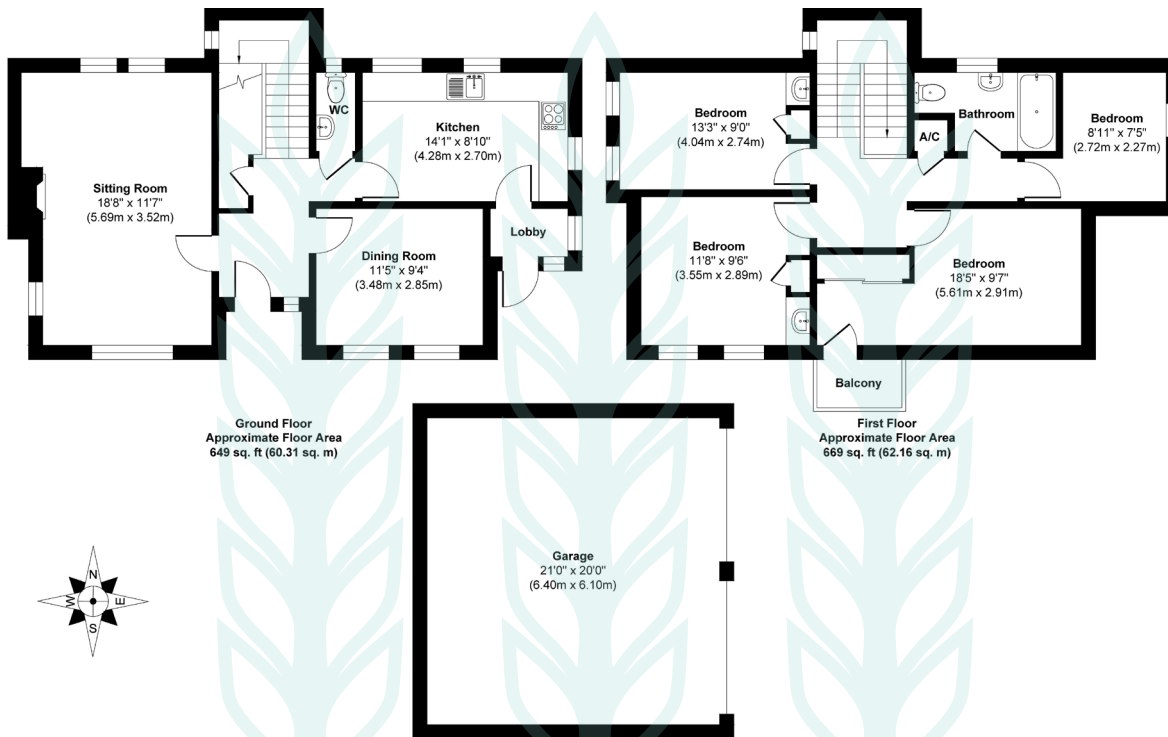

**Floor Area 1318 sq. ft / 122.47 sq. m.**  
**Garage Area 420 sq. ft / 39.04 sq. m.**

Illustration for identification purposes only, measurements approximate, not to scale. Copyright



**Chapman Sticks**

The Corn Exchange,  
Market Place,  
Hadleigh,  
Suffolk,  
IP7 5DN

info@chapmansticks.co.uk  
www.chapmansticks.co.uk

01473 372 372

**All enquiries:**

**Benedict Sticks**  
ben@chapmansticks.co.uk

**Cleo Shiel**  
cleo@chapmansticks.co.uk



Scan the QR code to visit our website



**IMPORTANT NOTICE**  
Chapman Sticks states these particulars are for general information only and do not constitute an offer or contract or part thereof. All descriptions, photographs and plans are for guidance only and should not be relied upon as statements or representations of fact. All measurements are approximate where stated. Any prospective purchaser must satisfy themselves of the accuracy of the information within these particulars by inspection or otherwise. Chapman Sticks does not have any authority to give any representations or warranties whatsoever in relation to this property (including but not limited to planning/building restrictions), nor can it enter into any contract on behalf of the client. We do not accept responsibility for any expenses incurred by prospective purchasers in inspecting properties which have been sold, let or withdrawn. If there is anything of particular importance to you, please contact us where we will endeavour to have any information or queries checked.