



HOPE COTTAGE

Hadleigh | Suffolk



Chapman Stickels

HOPE COTTAGE, 75 BENTON STREET, HADLEIGH, SUFFOLK, IP7 5AR

A CHARMING GRADE II LISTED COTTAGE CLOSE TO THE HEART OF HADLEIGH

Hadleigh Town Centre - 0.5 miles

Manningtree Station - 9 miles

Ipswich – 10 miles

-
- Sitting room • Dining room • Kitchen • Family bathroom • 2 double bedrooms •
• Bedroom 3 / Study • Rear garden •





Property

CHAIN FREE – Hope Cottage is a charming, end terrace cottage boasting 16th Century origins, and forms part of an attractive street scene of similar period properties within walking distance of central Hadleigh. The accommodation comprises a sitting room with attractive red brick fireplace and inset solid fuel burner, a wealth of exposed timbers and brickwork, and a small alcove which serves well as a library. Beyond this lies the dining room with a fireplace and wood surround which leads to the later, extended part of the house which offers a kitchen with eye and base level units, plumbing for washing machine and dishwasher, and space for cooker. Adjacent to the kitchen, and also part of the rear extension, is the family bathroom with airing cupboard which houses the Worcester boiler.

On the first floor, a large landing area with potential to serve as a third bedroom or study provides access to two double bedrooms also offering a wealth of original exposed timbers throughout.

Outside to the front, the house has much curb appeal with its jettied construction, typical of its era. To the rear of the house lies an attractive fully enclosed garden offering a sun terrace with lawn, and a fully stocked border.

Agents Note

Hope Cottage enjoys a pedestrian right of access over the neighbouring rear garden.

Location

The property is located some 0.5 miles south of Hadleigh town centre, and Benton Street consists of mainly individual properties of varying ages. Hadleigh itself is a very popular historic market town. The town offers an excellent range of local amenities including restaurants, pubs, sports facilities, a wide selection of shops and both junior and upper schools.

Services

We understand mains services are connected.

Local Authority and Council Tax Band

Babergh with Mid Suffolk District Council
Band D (2024)



75 Benton Street, Hadleigh, IP7 5AR

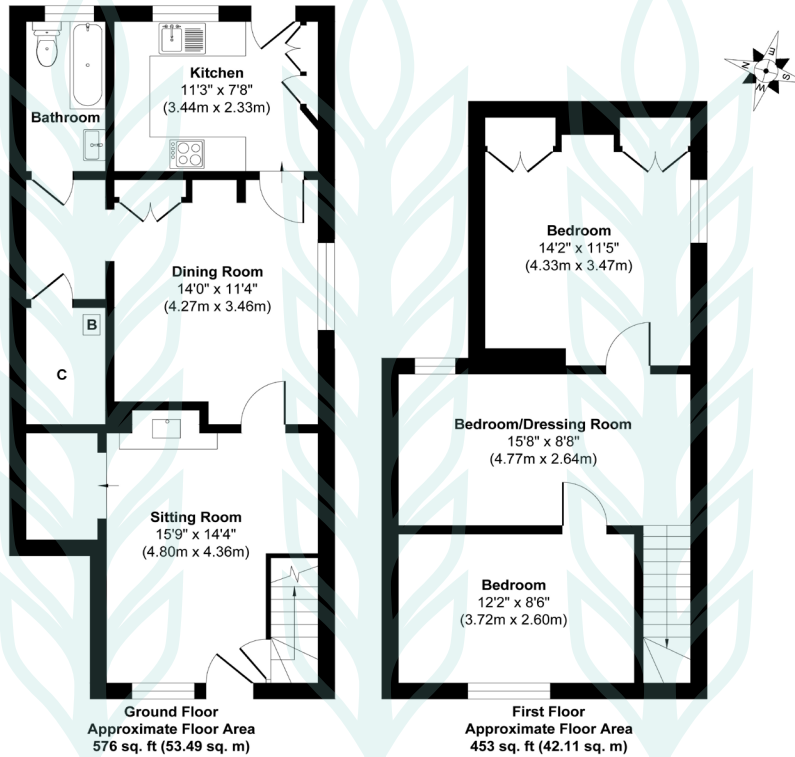

Approx. Gross Internal Floor Area 1029 sq. ft / 95.60 sq. m.

Illustration for identification purposes only, measurements approximate, not to scale. Copyright



Chapman Sticksels

The Corn Exchange,
Market Place,
Hadleigh,
Suffolk,
IP7 5DN

info@chapmansticksels.co.uk
www.chapmansticksels.co.uk

01473 372 372

All enquiries:

Benedict Sticksels
ben@chapmansticksels.co.uk

Cleo Shiel
cleo@chapmansticksels.co.uk



Scan the QR code to visit our website



rightmove

PrimeLocation.com

onTheMarket.com

Zoopla



IMPORTANT NOTICE
Chapman Sticksels states these particulars are for general information only and do not constitute an offer or contract or part thereof. All descriptions, photographs and plans are for guidance only and should not be relied upon as statements or representations of fact. All measurements are approximate where stated. Any prospective purchaser must satisfy themselves of the accuracy of the information within these particulars by inspection or otherwise. Chapman Sticksels does not have any authority to give any representations or warranties whatsoever in relation to this property (including but not limited to planning/building restrictions), nor can it enter into any contract on behalf of the client. We do not accept responsibility for any expenses incurred by prospective purchasers in inspecting properties which have been sold, let or withdrawn. If there is anything of particular importance to you, please contact us where we will endeavour to have any information or queries checked.