



TUDOR COTTAGE

Bildeston | Suffolk



Chapman Stickels

TUDOR COTTAGE, 44 HIGH STREET BILDESTON, SUFFOLK IP7 7EA

A DETACHED GRADE II LISTED HOUSE IN A SOUGHT
AFTER VILLAGE LOCATION

Hadleigh – 5 miles

Ipswich – 14 miles

Bury St Edmunds – 15 miles

-
- Reception hall / Snug • Sitting room • Dining room • Kitchen • Cloakroom •
 - Three double bedrooms • Family bathroom • Outside office • Garage •
 - Off road parking • Garden •





Property
CHAIN FREE – Tudor Cottage is a charming, detached cottage boasting 16th Century origins, located close to the heart of Bildeston, and forms part of its attractive street scene of similar period properties.

A welcoming reception hall, large enough to serve as a cosy snug, with an attractive red brick fireplace leads to a well proportioned sitting room boasting a wealth of period features such as exposed timbers and an impressive inglenook fireplace with inset wood burner. Adjacent to this, is the dining room with further exposed timbers and a partly exposed wattle and daub wall feature which is a charming reminder of the history of the building. Towards the rear of the house lies a modern, well-equipped kitchen (added 1987), offering base and eye level units and wood effect worktops, integrated Neff electric hob and oven, plumbing for dishwasher and washing machine, and includes a free-standing fridge. Beyond the kitchen is the pantry offering further storage and a free-standing freezer, and cloakroom opposite.

On the first floor, there are three double bedrooms, and a family bathroom with separate bath and shower, and a large landing area offering a triple built in wardrobe. Exposed timbers are featured throughout the upstairs accommodation with attractive traditional wooden doors with Suffolk latches.

Outside to the rear of the property, immediately behind the kitchen lies a paved sun terrace ideal for Al Fresco dining during the warmer months, and a fully enclosed and private garden consisting of mainly lawn surrounded by attractive borders filled with an interesting variety of mature shrubs, plants and trees. The property also offers a fully insulated outbuilding with power and phone line (untested) connected, lending itself to many uses and a detached single garage with off road parking beyond.



Location

Bildeston is a popular mid-Suffolk village approximately 5 miles from the market town of Hadleigh. The village is well served by a thriving Post Office/General Stores, Doctor's Surgery, Primary School, the acclaimed Bildeston Crown, pubs, and the nearby Hollow Trees Farm Shop.

Services

We understand mains water and electricity are connected. Oil-fired heating.

Local Authority and Council Tax Band

Babergh with Mid Suffolk District Council
Band D (2024)



Tudor Cottage, 44 High Street, Bildeston, IP7 7EA

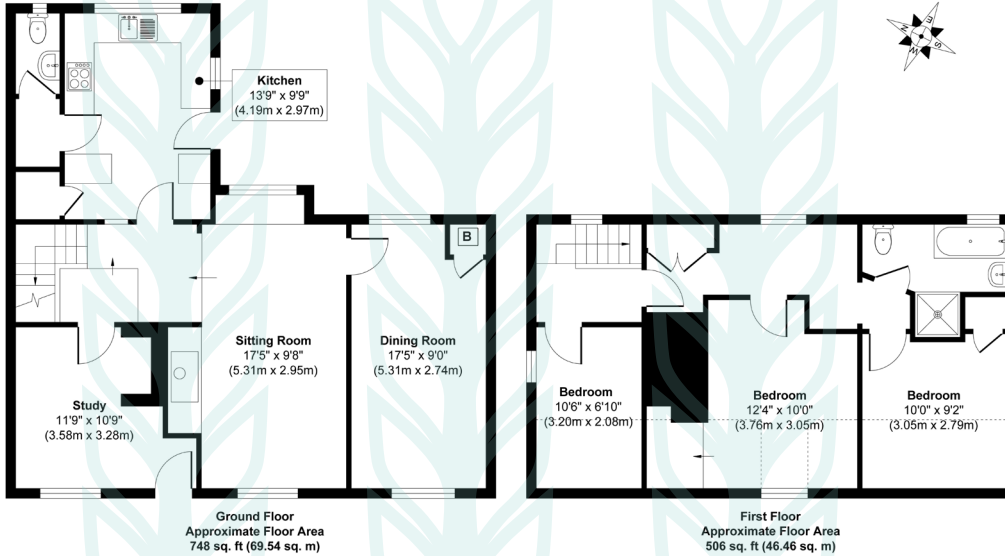

Floor Area 1254 sq. ft / 116.00 sq. m.

Illustration for identification purposes only, measurements approximate, not to scale. Copyright



Chapman Stickels

The Corn Exchange,
Market Place,
Hadleigh,
Suffolk,
IP7 5DN

info@chapmanstickels.co.uk
www.chapmanstickels.co.uk

01473 372 372

All enquiries:

Benedict Stickels
ben@chapmanstickels.co.uk

Cleo Shiel
cleo@chapmanstickels.co.uk



Scan the QR code to visit our website



IMPORTANT NOTICE
Chapman Stickels states these particulars are for general information only and do not constitute an offer or contract or part thereof. All descriptions, photographs and plans are for guidance only and should not be relied upon as statements or representations of fact. All measurements are approximate where stated. Any prospective purchaser must satisfy themselves of the accuracy of the information within these particulars by inspection or otherwise. Chapman Stickels does not have any authority to give any representations or warranties whatsoever in relation to this property (including but not limited to planning/building restrictions), nor can it enter into any contract on behalf of the client. We do not accept responsibility for any expenses incurred by prospective purchasers in inspecting properties which have been sold, let or withdrawn. If there is anything of particular importance to you, please contact us where we will endeavour to have any information or queries checked.