



10 GUNARY CLOSE

Boxford



Suffolk



Chapman Sticksels

10 GUNARY CLOSE, BOXFORD, SUFFOLK, CO10 5QB

A MODERNISED BUNGALOW WITH A SECLUDED GARDEN AND GARAGE,
WITHIN EASY WALKING DISTANCE OF ALL OF BOXFORD'S AMENITIES,
INCLUDING POST OFFICE, DOCTORS SURGERY, AND BUS STOP

Sudbury - 7 miles
Colchester - 11 miles
Ipswich - 14 miles
Manningtree - 15 miles

- Living room • Fitted kitchen • 2 bedrooms • Dining room/bedroom 3 •
- Bathroom • Garage • Gardens •





The Property

10 Gunary Close is one of the very few bungalows in Boxford within walking distance of this acclaimed village's facilities including the Post Office, village stores, Doctors Surgery, pub, and bus stop.

The property has been modernised with replacement windows and doors, a modern kitchen, and bathroom. The living room has casement doors out to the terrace whilst the kitchen is fitted with a built in 'Bosch' oven, 4 ring ceramic hob and fridge, sliding larder cupboard and plumbing for a washing machine.



There is a double bedroom and 2 single rooms, one of which was used as a dining room. These two rooms are divided by a stud wall which could easily be removed to create one larger room if desired.

Outside

The front and side gardens are enclosed by a picket fence, the private rear garden is bounded in part by a brick wall and part by close boarded fence. The garden is principally laid to lawn with flower and shrub borders.



EPC Rating

Current D(59). Potential C(79).

Services

Mains electricity, water, drainage.
Oil-fired central heating.

Local Authority and Council Tax

Babergh & Mid Suffolk District Council.
Band B.

10 Gunary Close , Boxford, CO10 5QB

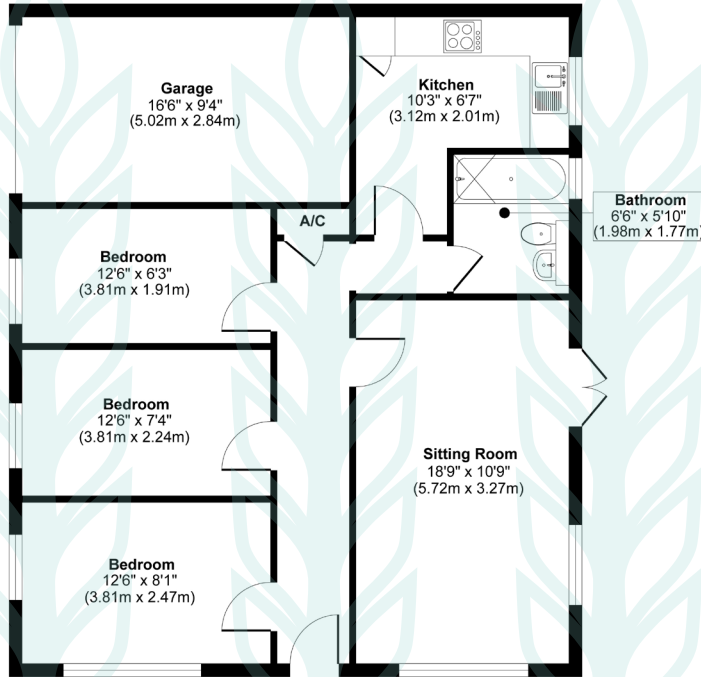

Chapman Stickels

The Corn Exchange,
Market Place,
Hadleigh,
Suffolk,
IP7 5DN

info@chapmanstickels.co.uk
www.chapmanstickels.co.uk

01473 372 372

All enquiries:

Benedict Stickels
ben@chapmanstickels.co.uk

Cleo Shiel
cleo@chapmanstickels.co.uk



Scan the QR code to visit our website



Floor Plan
Approximate Floor Area
733 sq. ft
(68.09 sq. m)

Approx. Gross Internal Floor Area 733 sq. ft / 68.09 sq. m
Approx. Gross Internal Garage Area 153 sq. ft / 14.25 sq. m

Illustration for identification purposes only, measurements are approximate, not to scale.
Copyright of Chapman Stickels Limited



IMPORTANT NOTICE
Chapman Stickels states these particulars are for general information only and do not constitute an offer or contract or part thereof. All descriptions, photographs and plans are for guidance only and should not be relied upon as statements or representations of fact. All measurements are approximate where stated. Any prospective purchaser must satisfy themselves of the accuracy of the information within these particulars by inspection or otherwise. Chapman Stickels does not have any authority to give any representations or warranties whatsoever in relation to this property (including but not limited to planning/building restrictions), nor can it enter into any contract on behalf of the client. We do not accept responsibility for any expenses incurred by prospective purchasers in inspecting properties which have been sold, let or withdrawn. If there is anything of particular importance to you, please contact us where we will endeavour to have any information or queries checked.