



**32 St. Ambrose Road**

Astley, Manchester, M29 7DE

**Offers over £250,000**

\*\*\* FULLY RENOVATED \*\*\* NOT TO BE MISSED!\*\*\*

Looking for the perfect bungalow in Astley? SMOOTHMOVE PROPERTY, Tyldesley are proud to present FOR SALE this STUNNING, two bedroom semi-detached property that simply ticks all the boxes!

The modern interior briefly comprises: Welcoming entrance hall, TWO DOUBLE BEDROOMS with new fitted carpets and neutral decor, a BEAUTIFUL WET ROOM en-suite to the master, and a further contemporary family bathroom. An impressive OPEN PLAN KITCHEN/DINER/FAMILY ROOM can be found to the rear with BI-FOLDING doors opening onto the garden. The new HIGH GLOSS kitchen includes a full range of integrated appliances.

Externally the property boasts a low maintenance, fully paved rear garden which enjoys pleasant open views across farmland beyond. The front aspect offers a double driveway for off road parking and a low maintenance garden.

Located in a quiet CUL-DE-SAC position in a highly sought after area of Astley, the property is ideally placed for local amenities and transport links.

Early viewing highly recommended!

- FULLY RENOVATED
- OPEN PLAN KITCHEN/ FAMILY ROOM WITH BI-FOLDING DOORS
- TWO DOUBLE BEDROOMS
- EN-SUITE WET ROOM
- MODERN FAMILY BATHROOM
- NEW HIGH GLOSS KITCHEN WITH APPLIANCES
- OPEN VIEWS TO REAR
- NEW ELECTRICAL REWIRE AND CENTRAL HEATING SYSTEM
- NO ONWARD CHAIN
- CUL DE SAC POSITION

## Viewing

Please contact our Smoothmove Property Office on 01942 914124 if you wish to arrange a viewing appointment for this property or require further information.



Floor Plan

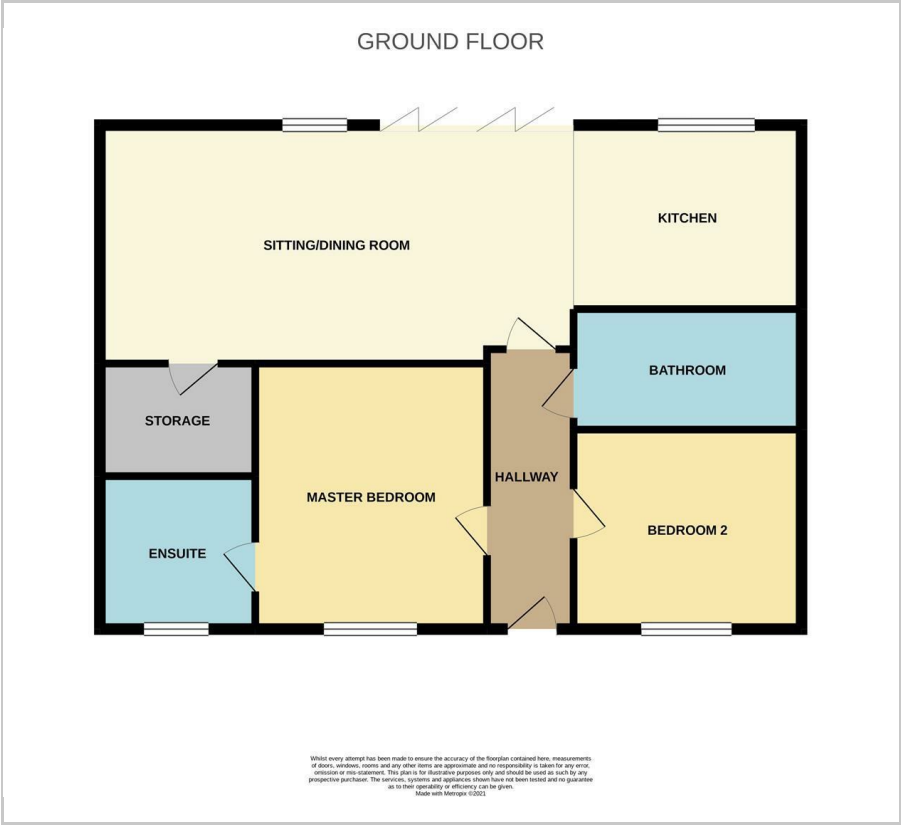

Area Map



Energy Efficiency Graph

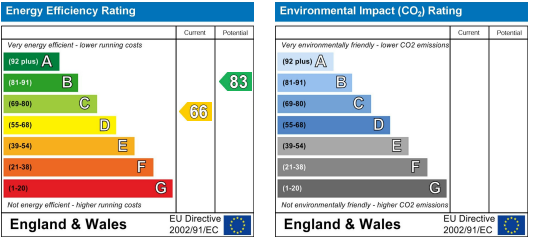

These particulars, whilst believed to be accurate are set out as a general outline only for guidance and do not constitute any part of an offer or contract. Intending purchasers should not rely on them as statements of representation of fact, but must satisfy themselves by inspection or otherwise as to their accuracy. No person in this firm's employment has the authority to make or give any representation or warranty in respect of the property.