

JESSICA JAMES
Properties



Lynton, 17 Salisbury Road, Marlborough, Wiltshire, SN8 4AB
Asking Price £625,000



Lynton, 17 Salisbury Road, Marlborough, Wiltshire, SN8 4AB

Asking Price £625,000

A charming Victorian four bedroomed detached house occupying a good sized corner plot with south west facing enclosed garden, off road parking and a detached garage. Four reception rooms. Shower room and family bathroom.

Three double bedrooms. Open fireplaces. Much original character and charm. Large modern kitchen with built in appliances and gas fired Aga with adjacent breakfast / garden room. Some works required. Gas fired central heating and majority double glazed windows. No onward chain. Call Jonathan on 07775 858 772 to view.

Description

We walk through the mature well stocked front garden with pathways to both sides, up to the covered front porch and through the front door into the entrance hall. Staircase rises to the first floor with storage under, door left into the dining room with bay window to the front, attractive fireplace with inset wood burning stove and double doors opening into the good sized kitchen with extensive modern fitted storage cupboards and contrasting solid wood worksurfaces over, inset triple sink, gas hob and eye level oven/grill, integrated dishwasher, fridge and centre stage a lovely gas fired Aga. Straight on through the archway into a lovely breakfast or garden room, overlooking the garden and flooded with light from the full height glazed roof. Door through to the rear hall with door into the garden, straight on into a small utility area and door into the downstairs shower and cloakroom. Back through the hall, left back into the kitchen and left again into the Study with window to the side, finally right into the drawing room with bay window to the front and lovely original open fireplace.

Situation

Up the staircase on to the landing, with access to the loft and window to the front, right and right again into the main bedroom, a good sized double with three double built in wardrobes. Straight over the landing into the second bedroom, again a good double with two double wardrobes. Along the landing and right into the third bedroom, again a double with window to the rear and open fronted wardrobe. The family bathroom is next with an older style suite but also a walk in shower. Finally into the fourth bedroom, a single with window to the rear and a large walk-in boiler/airing cupboard.

Outside.

To the front a well stocked garden with mature shrubs and climbing roses. To the left gated access to a wood store and the rear garden, to the right access to the parking area.

To the rear, a good sized south west facing, enclosed garden, paved patio leading to the lawn and deep well stocked flower and shrub beds with a mature fruit tree. To the rear a second patio area with timber shed and steps leading to the garage.

Parking. Brick paved parking area to the side, which could, we understand be enlarged. Detached garage with power and light to the rear of the plot.

Council Tax Band: F



Floor Plans

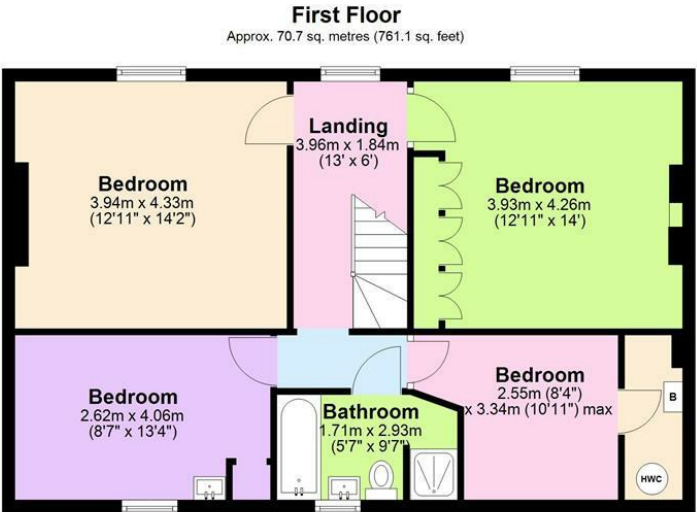
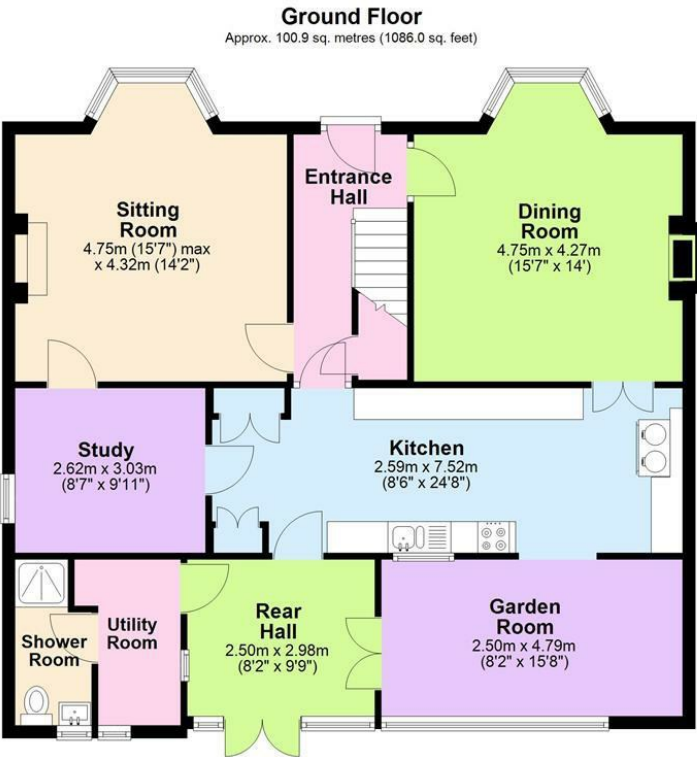

Total area: approx. 171.6 sq. metres (1847.1 sq. feet)
Lynton, 17 Salisbury Road, Marlborough

Energy Performance Graph

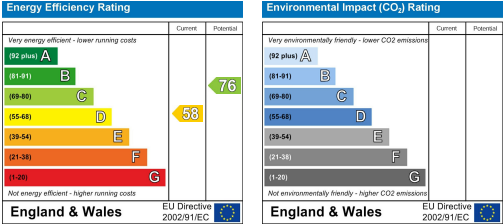

These particulars, whilst believed to be accurate are set out as a general outline only for guidance and do not constitute any part of an offer or contract. Intending purchasers should not rely on them as statements of representation of fact, but must satisfy themselves by inspection or otherwise as to their accuracy. No person in this firm's employment has the authority to make or give any representation or warranty in respect of the property.

Viewing

Please contact our Jessica James Properties Office on 01793 875324 if you wish to arrange a viewing appointment for this property or require further information.

Contact us

T: 01793 875324
jessica@jessicajamesproperties.co.uk