



## North Side Wandsworth Common, £350,000

An impressive, generously sized one-double-bedroom lateral apartment measuring over 533 sq ft, ideally located just off Wandsworth Common. The property features a bright reception room, a separate kitchen, a bathroom and a W/C. Additional benefits include abundant natural light, attractive views, and the advantage of being sold chain-free.

North Side Wandsworth Common is a short stroll from St. Johns Hill with its excellent selection of shops, bars and restaurants and is located close to all of the amenities of Northcote Road as well. Clapham Junction is very close offering excellent mainline transport links.

### Features

- One Double Bedroom
- Superb Location
- Fantastic Views
- Private Balcony
- Chain Free
- Additional Storage

# North Side Wandsworth Common, London, SW18

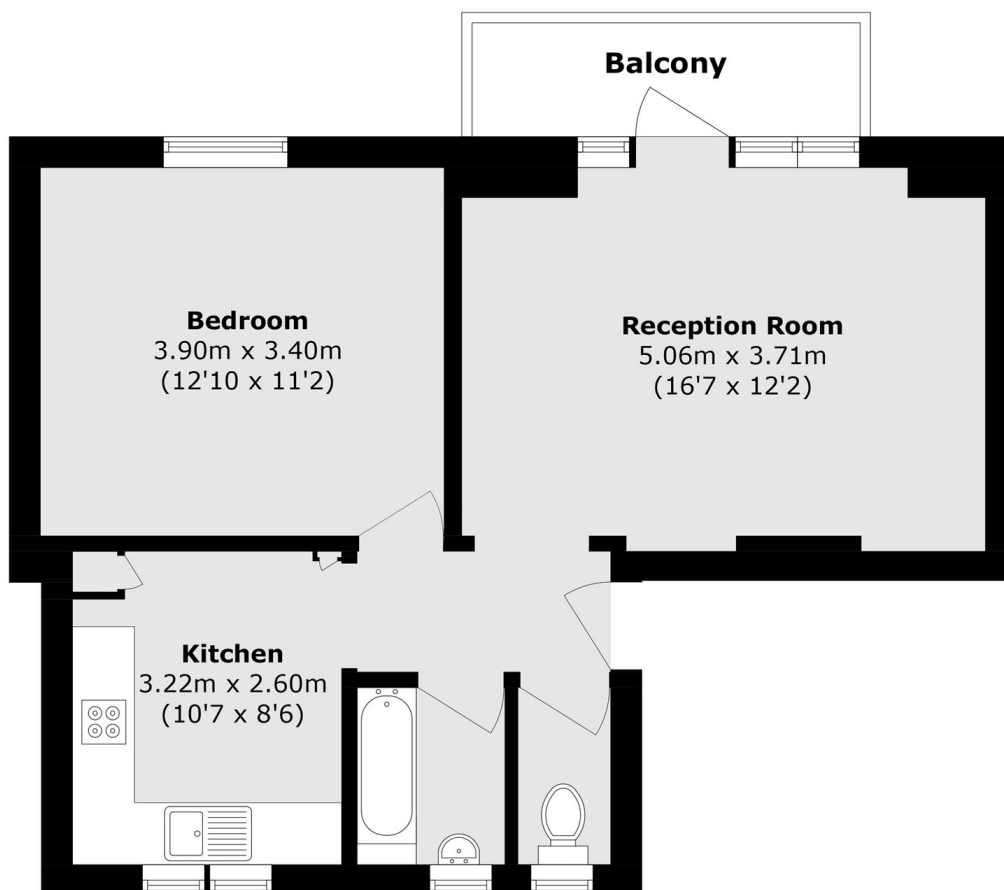

Total area (approx.): 49.6 sq. m (533.8 sq. ft)

Balcony area (approx.): 4.1 sq. m (44.1 sq. ft)