



Queenstown Road, SW11
£1,100,000

Dexters



Queenstown Road, SW11

An impressive two double bedroom lateral apartment situated within the sought-after Valetta House. Comprising an exceptionally large open plan reception room, modern kitchen & dining area, family bathroom and large outside space (roof terrace) overlooking Battersea Park. The property further benefits from a concierge, residents pool/gym & is moments from Battersea Power Station.

On entering the apartment, you are welcomed into a spacious hallway that leads through to the open-plan kitchen and reception room, designed for both entertaining and relaxing. Flooded with natural light, this generous space opens onto the home's stand-out feature, a large private balcony overlooking Battersea Park. Both bedrooms enjoy direct views to the balcony and beyond, creating a wonderful sense of flow and connection with the outdoors. The principal bedroom very well-proportioned and the second bedroom offers flexibility as a guest room, study, or additional living space. A sleek bathroom and convenient utility room complete the accommodation.

A popular development opposite Battersea Park and located close to Chelsea Bridge and Chelsea. Queenstown Road station and Battersea Power Station Underground are close by. The Iconic Battersea Power station is moments away.

Features

- Valetta House
- Two Double Bedrooms
- Open Plan Reception/Kitchen
- 24 Hour Concierge
- Residents Gym & Pool
- Overlooking Battersea Park







Queenstown Road, London, SW11

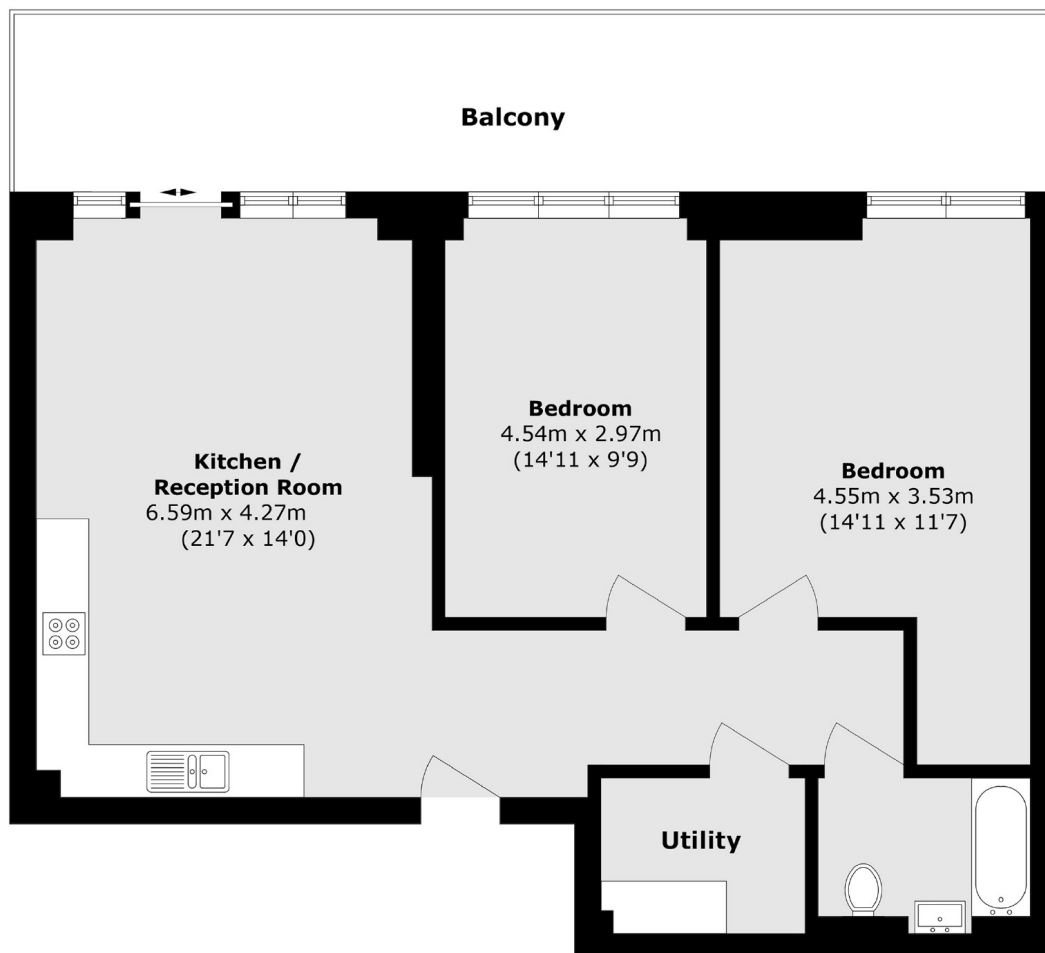

Total area (approx.): 82.0 sq. m (882.6 sq. ft)
Balcony area (approx.): 23.5 sq. m (253.0 sq. ft)

Dexters

Northcote Road
93 St. John's Road
London
SW11 1QY
Sales
020 7483 6333

Energy Rating: B. We aim to make our particulars both accurate and reliable. However they are not guaranteed; nor do they form part of an offer or contract. If you require clarification on any points then please contact us, especially if you're traveling some distance to view. Please note that appliances and heating systems have not been tested and therefore no warranties can be given as to their good working order.

 **RICS** | Regulated
Estate Agent
and Letting Agent

[dexters.co.uk](https://www.dexters.co.uk)