



## Thorndean Street, SW18

### £416,500

A spacious ground floor apartment located on the popular Thorndean Street. Arranged to include a reception room, separate eat-in kitchen, double bedroom & modern family bathroom. The property benefits further from a low maintenance shared garden, has a share of the freehold and is being sold chain free.

Thorndean Street is well placed for accessing a wide range of local amenities in Earlsfield, Wandsworth and Balham with Earlsfield station (National Rail) just a short stroll away taking you into Clapham Junction in one stop.

### Features

- Reception Room
- Eat-In Kitchen
- One Double Bedroom
- Share Of Freehold
- Chain Free
- Garden

# Thorndean Street, London, SW18

## Ground Floor

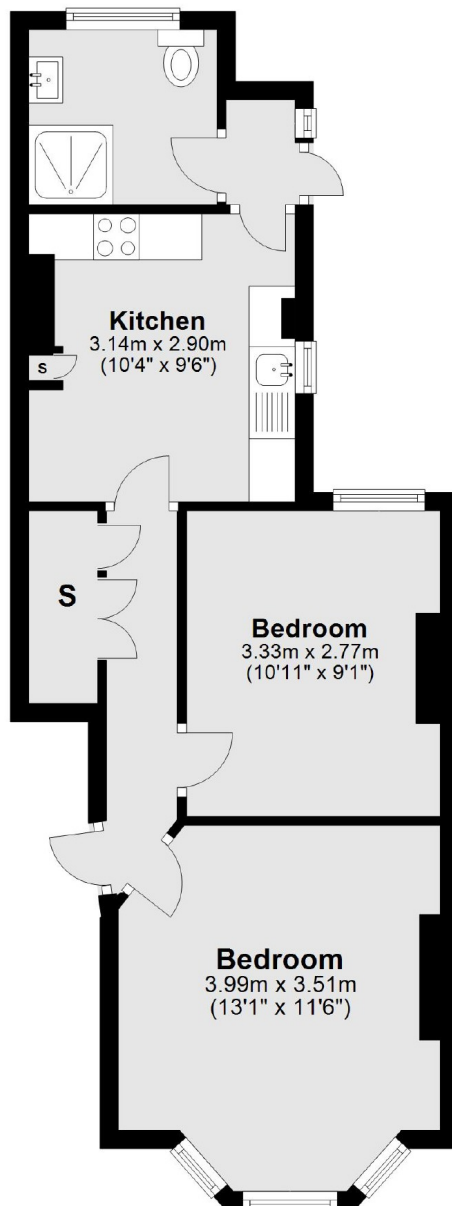

Total area: approx. 41.8 sq. metres (450.2 sq. feet)