



Taybridge Road, SW11

£500,000

Offers in excess of. A spacious one double bedroom apartment set in a beautiful Victorian building. Accommodation includes a generous open plan reception/kitchen/dining area, double bedroom with feature fireplace and bespoke built-in wardrobes and a modern bathroom. The property further benefits from a private garden, has been recently refurbished, has it's own private entrance and owns a share of the freehold.

Taybridge Road is a sought after residential street off Clapham Common North Side located near some of the areas best schools. Northcote Road is close by with an array of bars, restaurants, cafés & gyms. Transport links can be found at Clapham Common and Clapham Junction alongside local bus routes with access to the beautiful Battersea Park/Power Station and the busy Sloane Square.

Features

- Victorian Conversion
- Open Plan Reception/Kitchen
- Large Double Bedroom
- Private Garden
- Share Of The Freehold
- Private Entrance

Taybridge Road, London, SW11

Lower Ground Floor

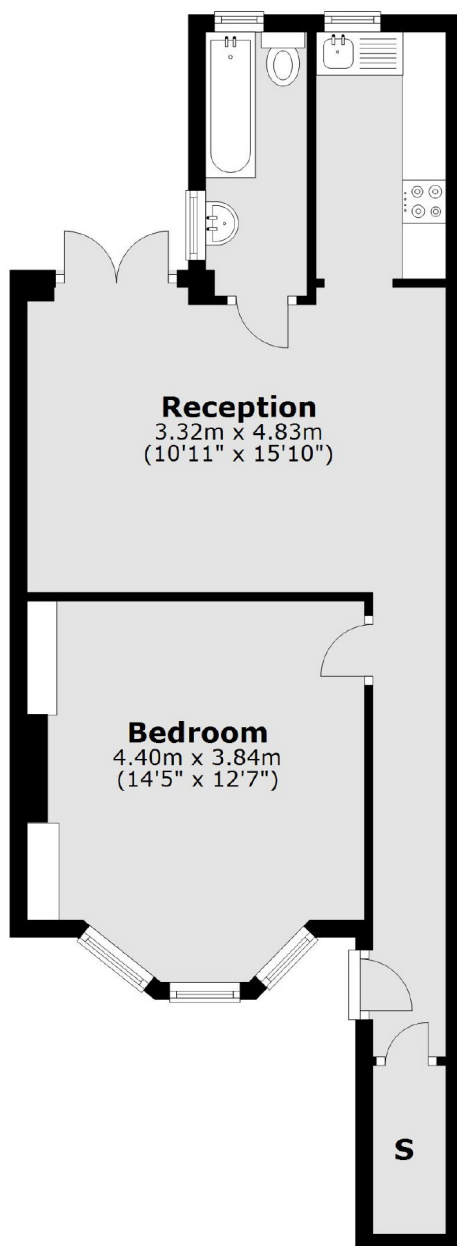

Total area: approx. 46.1 sq. metres (496.2 sq. feet)

Dexters

Northcote Road
93 St. John's Road
London
SW11 1QY
Sales
020 7483 6333

Energy Rating: C. We aim to make our particulars both accurate and reliable. However they are not guaranteed; nor do they form part of an offer or contract. If you require clarification on any points then please contact us, especially if you're traveling some distance to view. Please note that appliances and heating systems have not been tested and therefore no warranties can be given as to their good working order.

 **RICS** | Regulated
Estate Agent
and Letting Agent

[dexters.co.uk](https://www.dexters.co.uk)