



Nansen Road, SW11
£750,000

Dexters



Nansen Road, SW11

An exceptional and recently refurbished Victorian conversion presented in immaculate order throughout. Comprising a large open plan reception/kitchen, two double bedrooms, modern bathroom and private garden. The property also benefits from a share of the freehold.

As you head through the front door you are greeted by a warm and welcoming reception room with high ceilings and multiple seating areas. The newly refurbished kitchen is nestled at the back of the reception room with plenty of space to dine making this a great area for entertaining and relaxing alike. The two well proportioned bedrooms are located at the rear, both leading onto the private, low maintenance garden. The modern bathroom is well located being opposite the bedrooms.

Nansen Road is located moments from Clapham Common and the many shops, cafés, gyms and restaurants on Lavender Hill. The fashionable Northcote Road is within a short walk, along with the department stores and excellent transport links of Clapham Junction.

Features

- Victorian Conversion
- Two Double Bedrooms
- Open Plan Reception/Kitchen
- Modern Bathroom
- Private Garden
- Share Of Freehold



Nansen Road, London, SW11

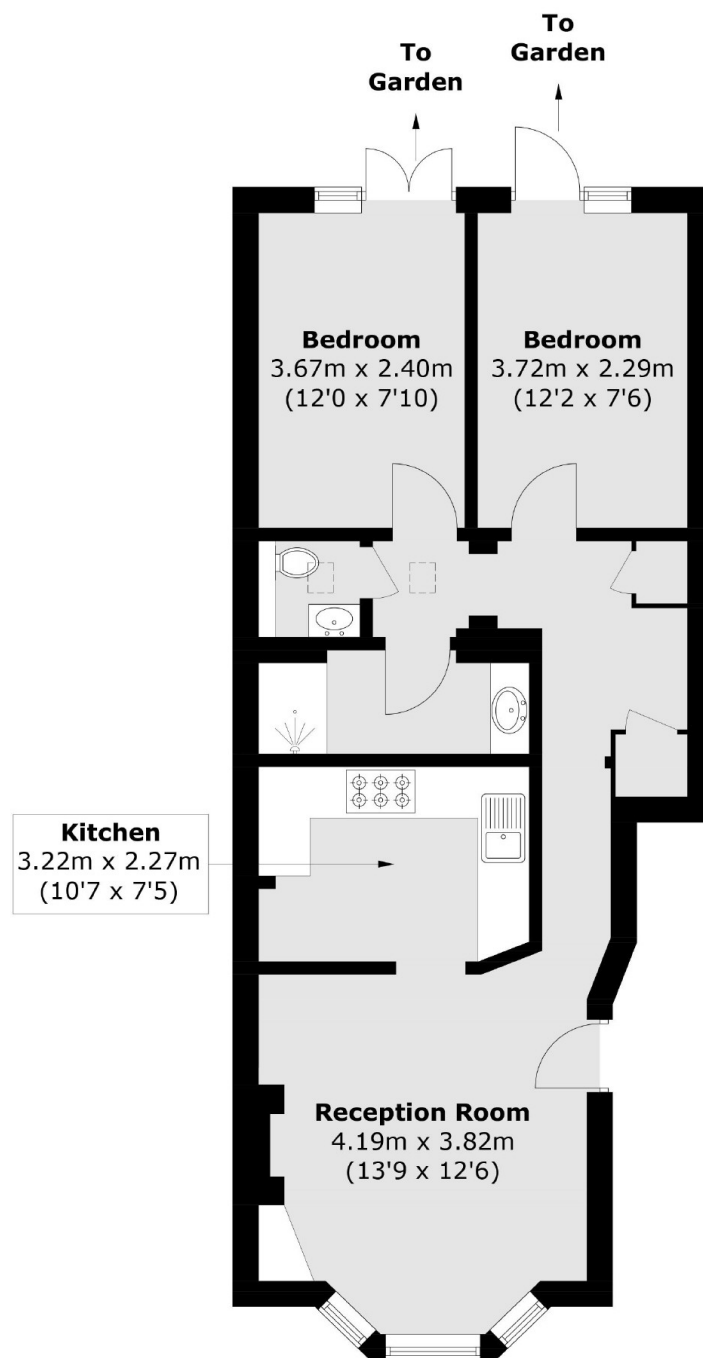

Total area (approx.): 57.6 sq. m (620.0 sq. ft)

Dexters

Northcote Road
93 St. John's Road
London
SW11 1QY
Sales
020 7483 6333

Energy Rating: D. We aim to make our particulars both accurate and reliable. However they are not guaranteed; nor do they form part of an offer or contract. If you require clarification on any points then please contact us, especially if you're traveling some distance to view. Please note that appliances and heating systems have not been tested and therefore no warranties can be given as to their good working order.

 **RICS** | Regulated
Estate Agent
and Letting Agent

[dexters.co.uk](https://www.dexters.co.uk)