



Lavender Hill, SW11

£500,000

A one double bedroom garden flat measuring just shy of 600 Sq Ft situated on the sought after Lavender Hill. The apartment comprises of a double bedroom, open plan reception/kitchen, family bathroom and spacious private garden, perfect for entertaining and relaxing. The property further benefits from it's own private entrance.

Lavender Hill is conveniently located for Clapham Junction station, the green spaces of Clapham Common as well as many shops, restaurants and bars on Northcote Road and Battersea Rise. Battersea Park & Power Station are a short stroll away.

Features

- One Double Bedroom
- Private Entrance
- Open Plan Reception/Kitchen
- Modern Bathroom
- Spacious Garden
- Superb Location

Lavender Hill, London, SW11

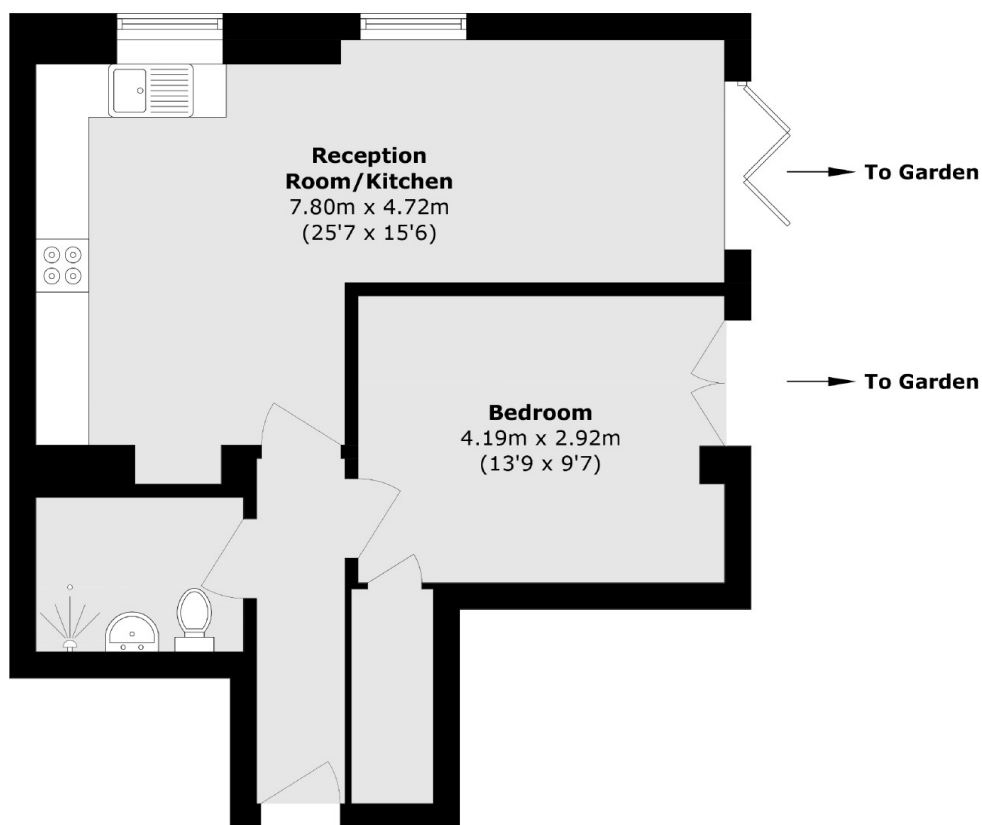

Total area (approx.): 55.0 sq. m (592.0 sq. ft)