



Mossbury Road, SW11

£450,000

A one double bedroom ground floor garden flat set in a beautiful Victorian building situated on the sought after Mossbury Road. The apartment comprises of a double bedroom, reception room with high ceilings, eat-in kitchen, family bathroom & private South facing garden. The property benefits further from being sold chain free & has a share of the freehold.

Mossbury Road is a sought after street located moments from the green open spaces of Wandsworth Common and close to the eclectic mix of bars, restaurants and boutiques on St. John's Hill & Northcote Road. Clapham Junction Station is literally around the corner.

Features

- Period Conversion
- Reception Room
- Eat-In Kitchen
- Private South Facing Garden
- Superb Location
- Chain Free

Mossbury Road,
London, SW11

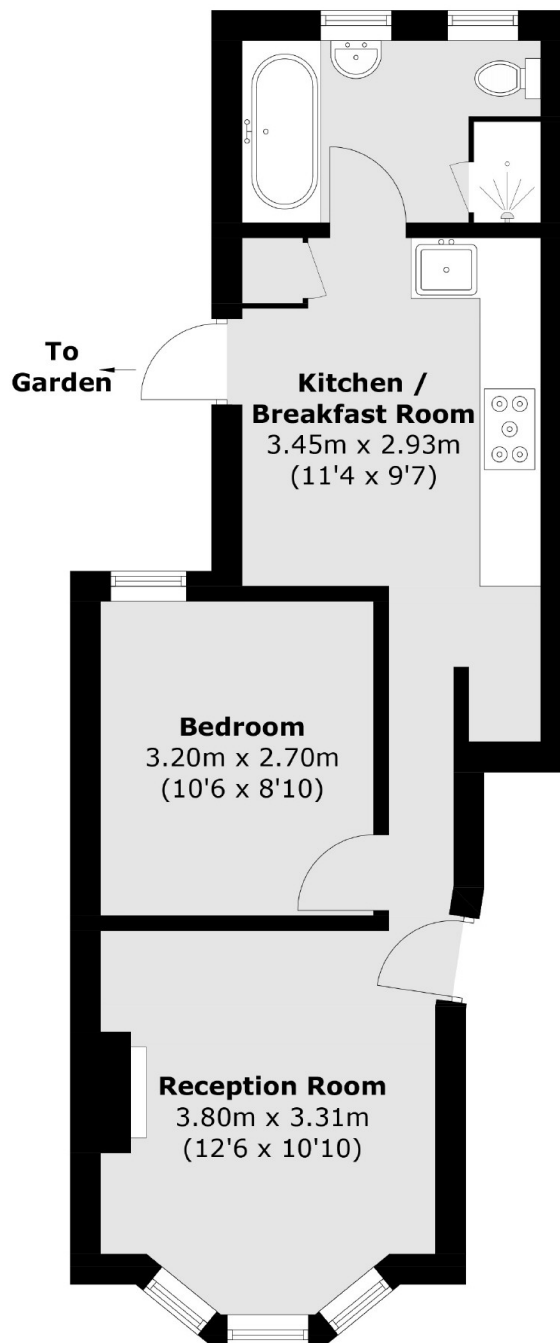

Total area (approx.): 40.8 sq. m (439.2 sq. ft)

Dexters

Northcote Road
93 St. John's Road
London
SW11 1QY
Sales
020 7483 6333

Energy Rating: C. We aim to make our particulars both accurate and reliable. However they are not guaranteed; nor do they form part of an offer or contract. If you require clarification on any points then please contact us, especially if you're traveling some distance to view. Please note that appliances and heating systems have not been tested and therefore no warranties can be given as to their good working order.

 **RICS** | Regulated
Estate Agent
and Letting Agent

dexters.co.uk