



Jedburgh Street, SW11

£725,000

An exceptional three double bedroom Victorian conversion measuring over 938 Sq Ft. Comprising a large reception room, eat-in kitchen that can be opened up to create an open plan setting, three double bedrooms & two bathrooms (inc en-suite). The property is being sold chain free.

Jedburgh Street is a sought-after residential street off Clapham Common North Side located near some of the area's best schools including Eaton House, Parkgate House and Belleville Wix Academy. Clapham Junction station, Clapham Common Underground & Clapham Common itself are a short stroll away.

Features

- Victorian Conversion
- Three Double Bedrooms
- Two Bathrooms
- Superb Location
- Measuring Over 938 Sq Ft
- Chain Free

Jedburgh Street, London, SW11

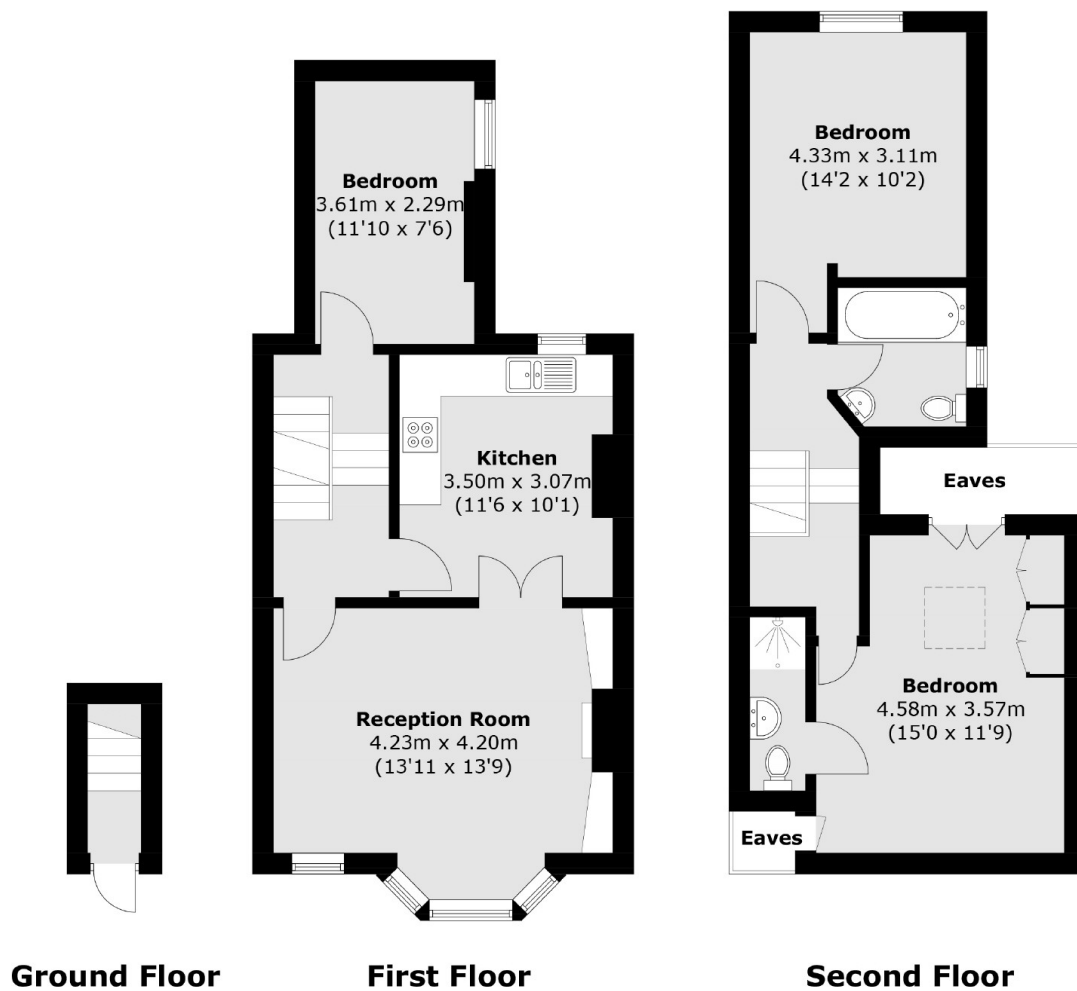

Total area (approx.): 87.2 sq. m (938.6 sq. ft)
(Excluding Eaves)