



Harbut Road, SW11

£525,000

A one double bedroom ground floor garden flat set in a beautiful Victoria building situated on the sought after Harbut Road. The apartment comprises of a spacious reception room, separate eat-in kitchen, double bedroom and family bathroom. The property benefits further from a private garden and a basement which could be used as additional storage

Harbut Road is a sought after address located moments from the green open spaces of Wandsworth Common and close to the eclectic mix of bars, restaurants and boutiques on St. John's Hill & Northcote Road. Clapham Junction Station is just a short stroll away.

Features

- Period Conversion
- Large Reception Room
- Eat-In Kitchen
- Private Garden
- Superb Location

Harbut Road, London, SW11

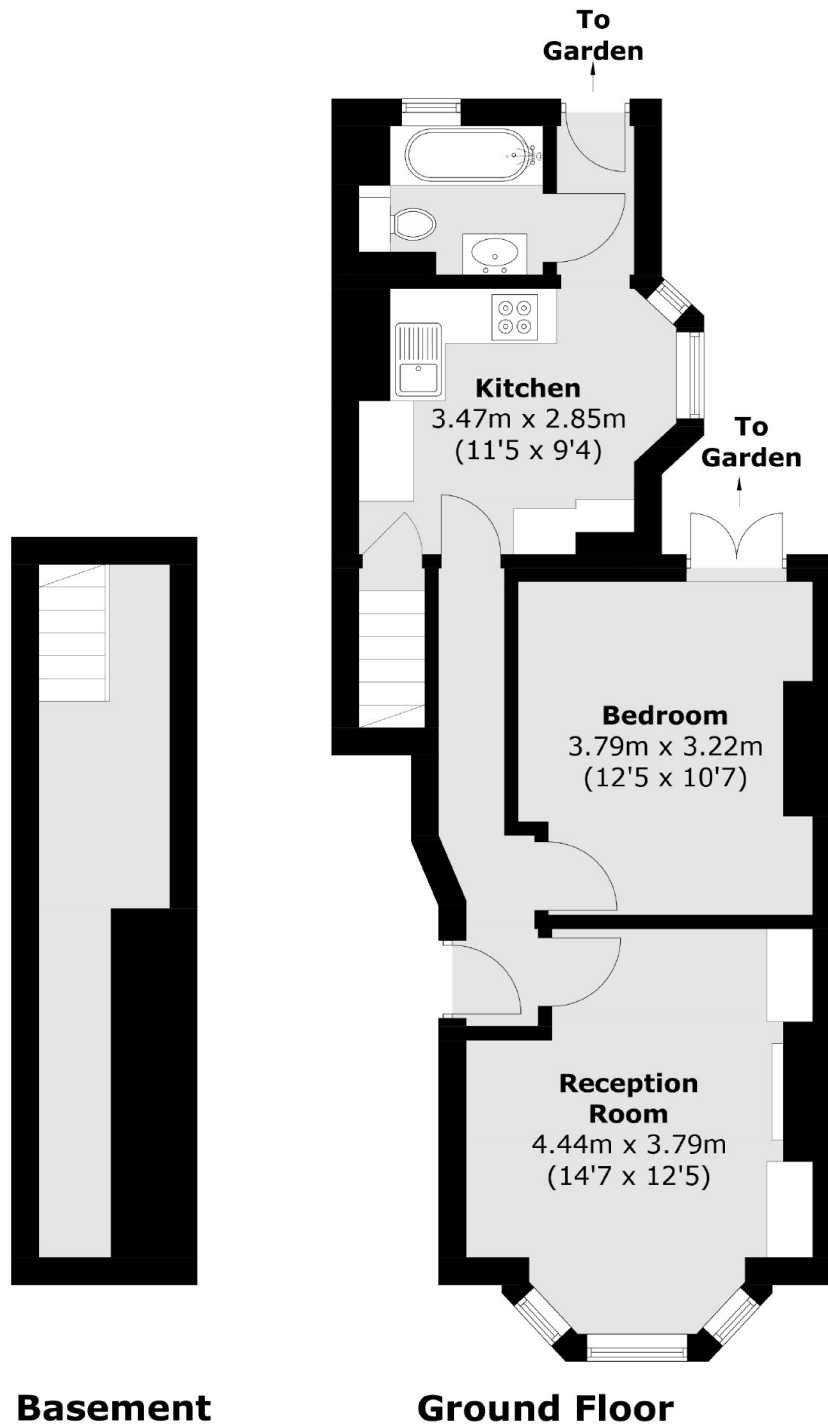

Total area (approx.): 56.6 sq. m (609.2 sq. ft)
(Including Basement)

Dexters

Northcote Road
93 St. John's Road
London
SW11 1QY
Sales
020 7483 6333

Energy Rating: D. We aim to make our particulars both accurate and reliable. However they are not guaranteed; nor do they form part of an offer or contract. If you require clarification on any points then please contact us, especially if you're traveling some distance to view. Please note that appliances and heating systems have not been tested and therefore no warranties can be given as to their good working order.

 **RICS** | Regulated
Estate Agent
and Letting Agent

dexters.co.uk