



East Hill, SW18

£475,000

A rarely available split level apartment with over 925 sq ft situated within on East Hill. Comprising a spacious reception room, an adjoining well-equipped eat-in kitchen, three bedrooms, separate study, family bathroom & private balcony. The property benefits further from a garage & is being sold chain free.

East Hill is moments from Wandsworth Town. Transport nearby includes Wandsworth Town station, Earlsfield station and East Putney/Southfields on the district tube line. Also in close proximity are the gastropubs and coffee shops of Old York Road as well as Garratt Lane's selection of shops, restaurants and bars.

Features

- Large Reception Room
- Three Bedrooms
- Private Balcony
- Over 925 Sq Ft
- Garage
- Chain Free

East Hill, London, SW18

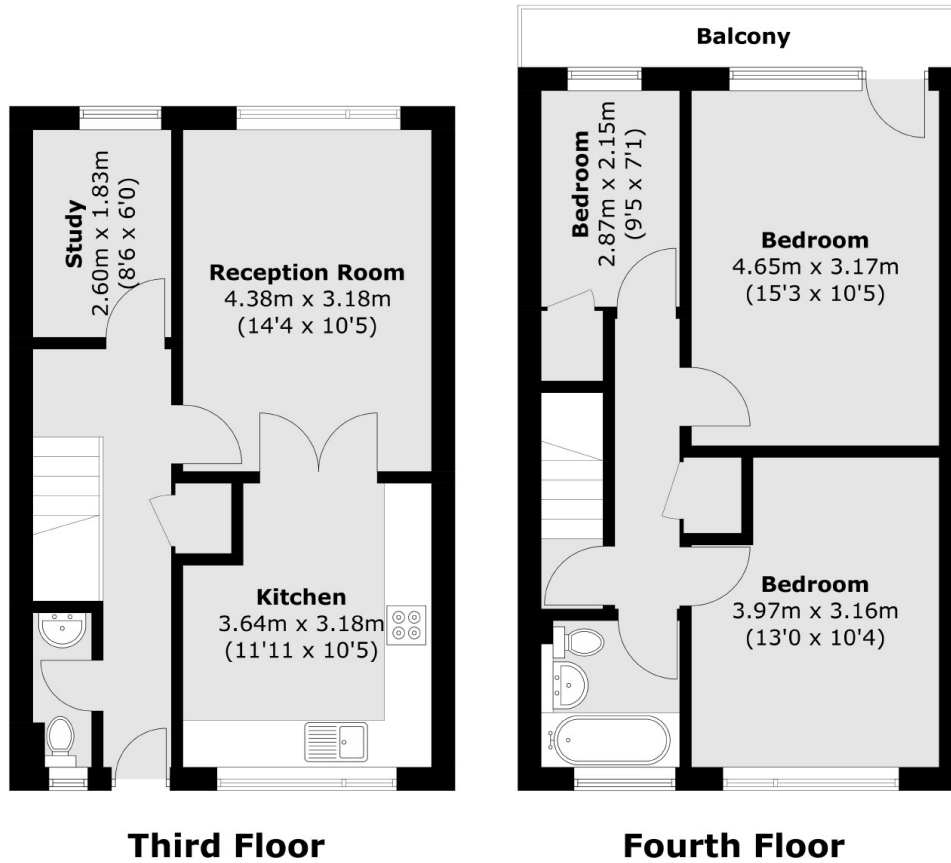

Total area (approx.): 86.0 sq. m (925.7 sq. ft)
Balcony (approx.): 4.2 sq. m (45.2 sq. ft)