



## Chivalry Road, SW11

£425,000

A spacious first floor apartment presented in excellent order throughout. Arranged to include a large reception room with a separate modern kitchen, two bedrooms and a bathroom.

Chivalry Road is a short stroll from St. Johns Hill with its excellent selection of shops, bars and restaurants and is located close to all of the amenities of Northcote Road as well. Clapham Junction is very close offering excellent mainline transport links.

### Features

- Large Reception Room
- Two Bedrooms
- Stylish Kitchen
- Long Lease
- Modern Bathroom
- Superb Location

# Chivalry Road, London, SW11

## First Floor

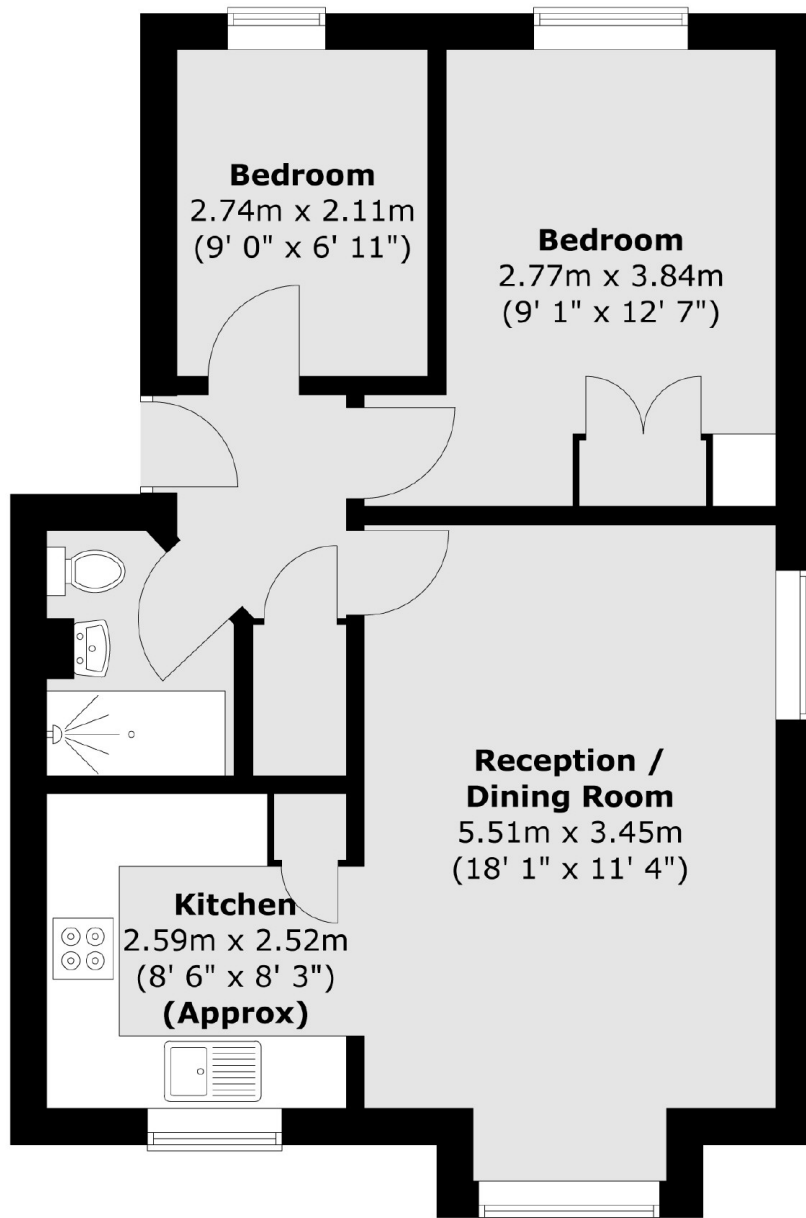

Total area (approx.) : 51.2 sq. m (551 sq. ft)