

St. John's Hill, SW11

£550,000

A bright, spacious, modern two double bedroom purpose built apartment. It has an open plan reception/ kitchen, two double bedrooms and modern bathroom. The property further benefits from concierge, communal roof terrace, communal cinema, is being sold chain free and has a share of the freehold.

Lumiere Apartments is perfectly located for the green open spaces of Wandsworth Common and close to the eclectic mix of bars, restaurants and boutiques on St. John's Hill/Road & Northcote Road. Clapham Junction Station is literally moments away and couldn't be easier for commuters.

Features

- Two Double Bedrooms
- Communal Roof Terrace
- Communal Cinema
- Concierge
- Chain Free
- Superb Location

St. John's Hill, London, SW11

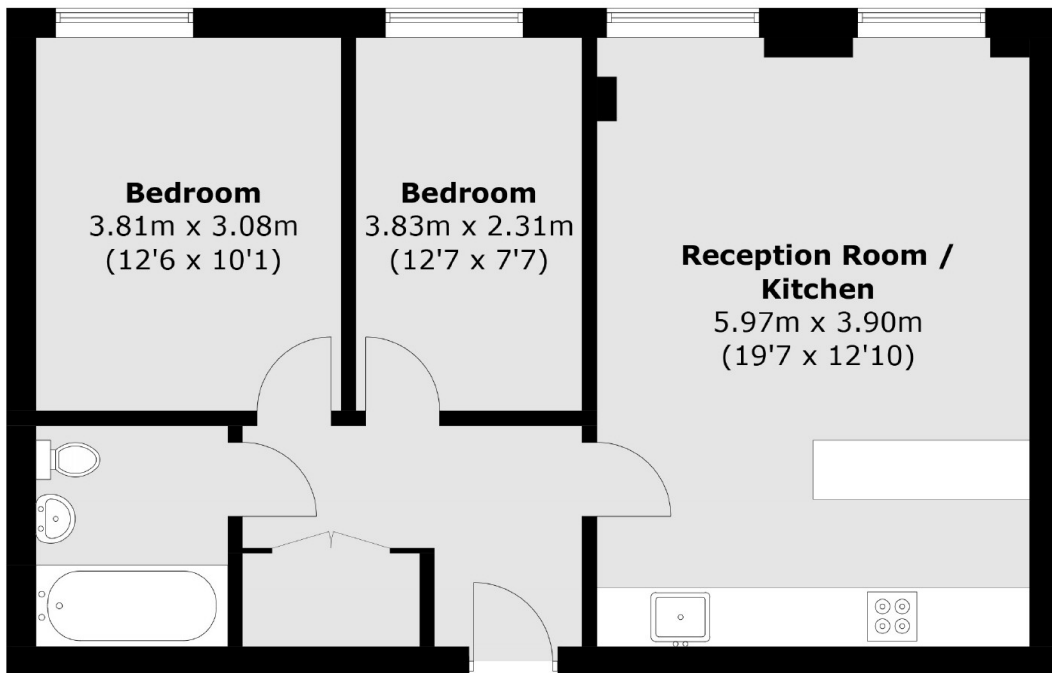

Total area (approx.): 62.7 sq. m (674.9 sq. ft)