



## Elsley Road, SW11

£850,000

A beautiful three double bedroom freehold house located in the popular Shaftesbury estate. Accommodation includes a large reception room, dining room, family bathroom & private garden. The property further benefits from extension potential into the side return and loft (STP).

Elsley Road is a residential street in the popular Shaftesbury area of Battersea. Clapham Common, Battersea Park & the iconic Battersea Power Station are all nearby, as are the transport links at Clapham Junction mainline train station.

### Features

- Three Double Bedrooms
- Large Reception Room
- Family Bathroom
- Private Garden
- Extension Potential (STP)
- Superb Location

# Elsley Road, London, SW11

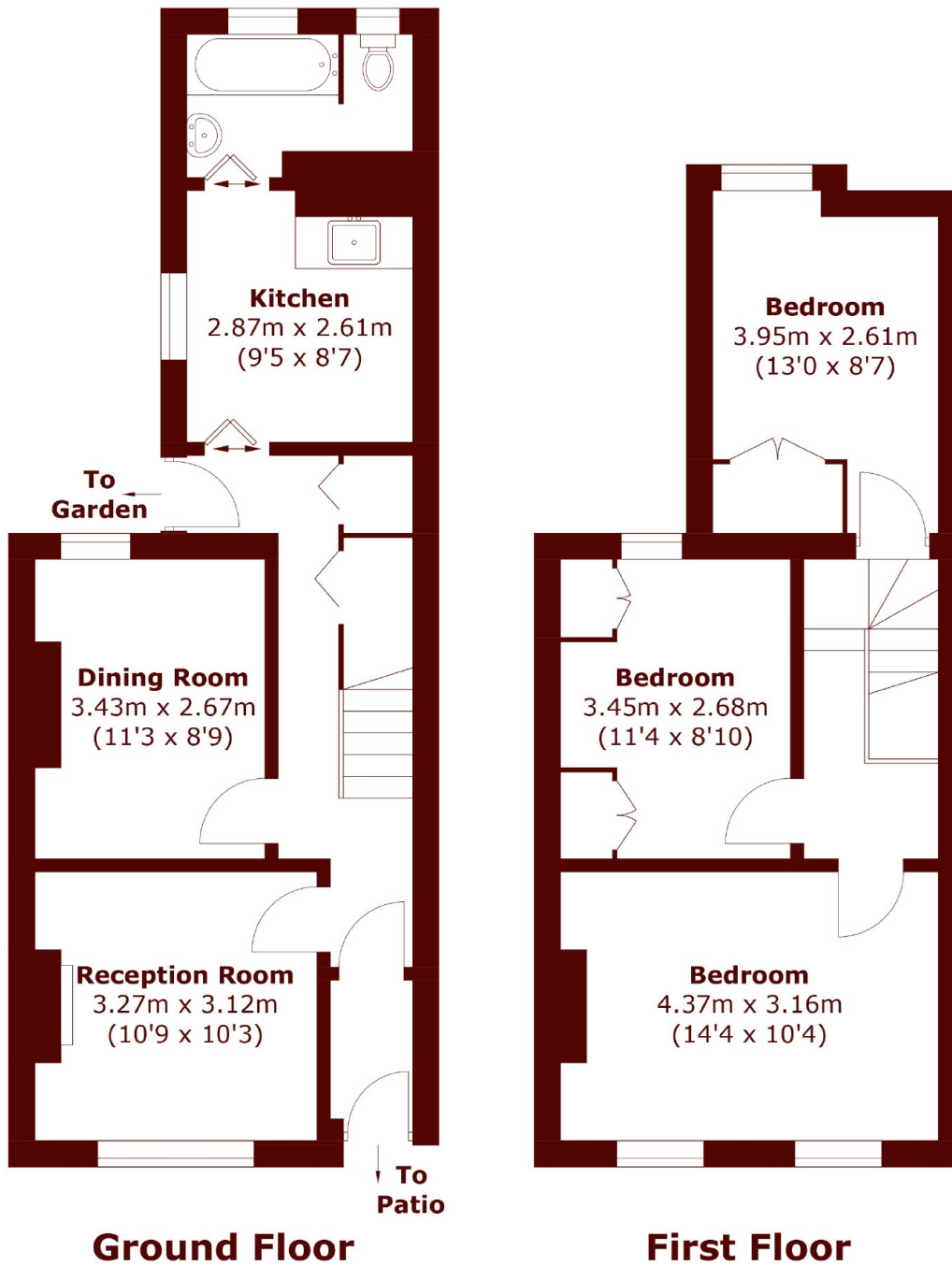

Total area (approx.): 84.6 sq. m (910.6 sq. ft)