



Fitzhugh Grove, SW18

£300,000

A spacious bright and airy apartment presented in excellent order throughout. Arranged to include a large reception room with private balcony, separate modern kitchen, double bedroom and a bathroom. The property further benefits from off street parking including visitors parking.

Fitzhugh Grove is well placed for accessing a wide range of local amenities in Wandsworth, Earlsfield and Balham with Wandsworth Common station (National Rail) just a short distance away.

Features

- Large Reception Room
- Double Bedroom
- Modern Kitchen
- Private Balcony
- Communal Garden
- Off Street Parking

Fitzhugh Grove, London, SW18

Tenth Floor

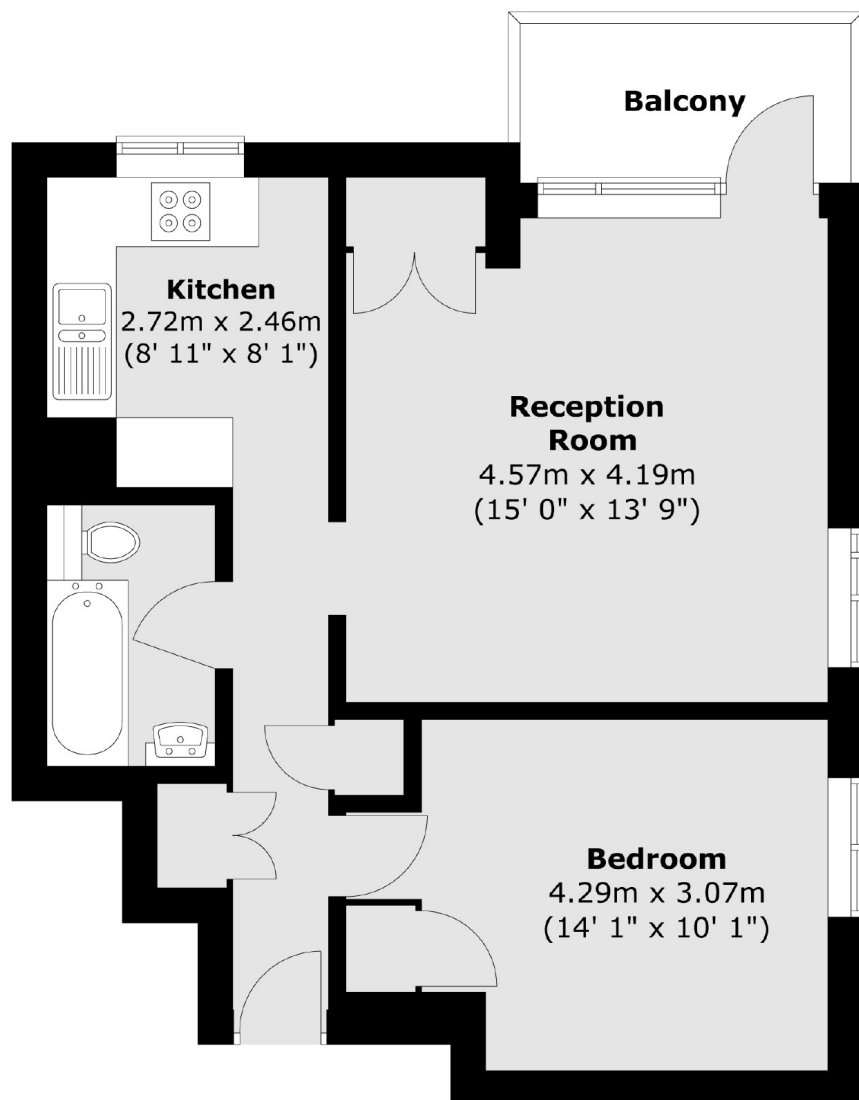

Total area (approx.) : 47.7 sq. m (513 sq. ft)
Total balcony area (approx.) : 4 sq. m (43 sq. ft)