



York Road, SW11
£700,000

Dexters



York Road, SW11

A contemporary two double bedroom, two bathroom loft style apartment built within a beautiful former Victorian candle making factory ideally located for Clapham Junction and moments from the Thames. The property benefits from a secure gated video entry system, allocated off street parking, a private terrace and is being sold chain free.

Candlemakers apartments is situated just off the banks of the River Thames, a short walk to Battersea Village & Chelsea Harbour. Clapham Junction is located close by where there is an abundance of shops, restaurants, cafes and bars and great transport links. The property also comes with secure underground parking space and a video entry system.

Features

- Two Double Bedrooms
- Two Bathrooms
- Measuring Over 800 Sq Ft
- Secure Gated Entrance
- Allocated Off Street Parking
- Private Terrace







York Road,
London, SW11

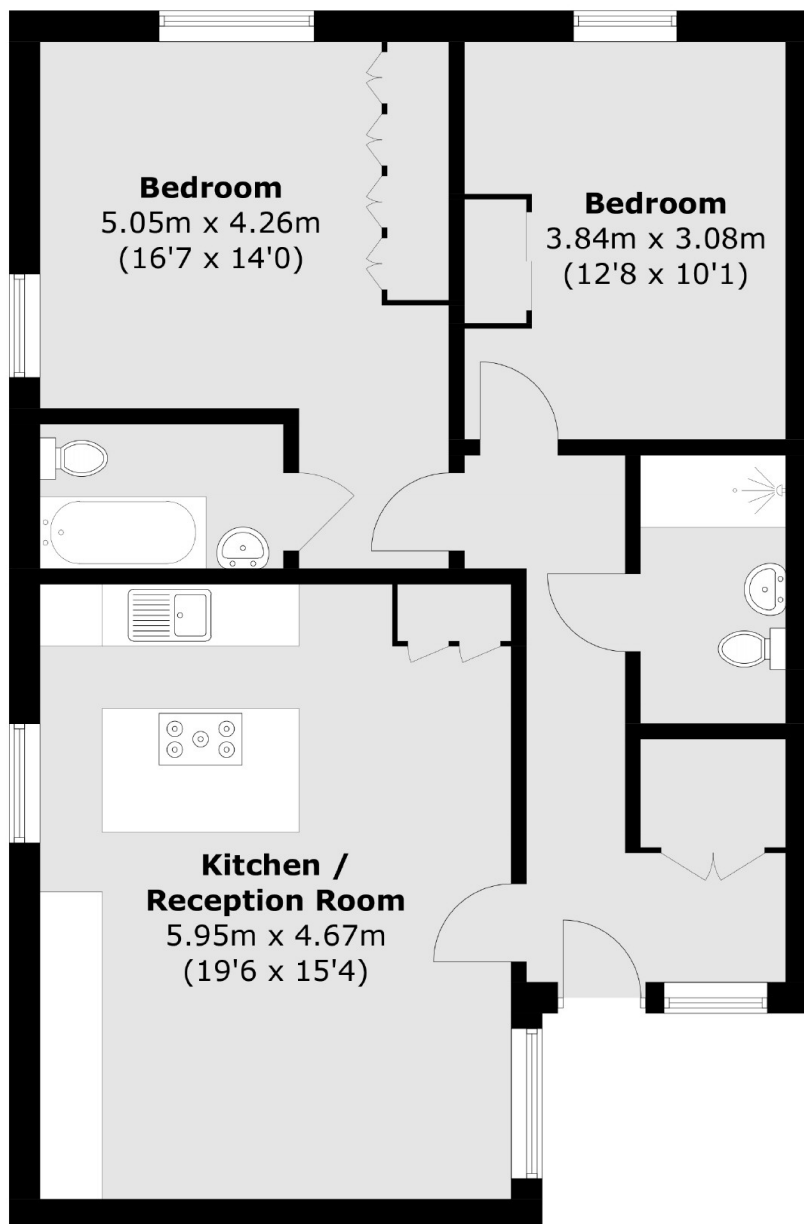

Second Floor

Total area (approx.): 75.2 sq. m (809.4 sq. ft)

Dexters

Northcote Road
93 St. John's Road
London
SW11 1QY
Sales
020 7483 6333

Energy Rating: B. We aim to make our particulars both accurate and reliable. However they are not guaranteed; nor do they form part of an offer or contract. If you require clarification on any points then please contact us, especially if you're traveling some distance to view. Please note that appliances and heating systems have not been tested and therefore no warranties can be given as to their good working order.

 **RICS** | Regulated
Estate Agent
and Letting Agent

dexters.co.uk