



Heathfield Road, SW18

£390,000

An impressive one double bedroom lateral apartment measuring over 656 sq ft situated within the sought-after Skydec Apartments development. Comprising an open plan reception/kitchen, modern bathroom and large private garden. The property benefits further from an allocated underground parking space.

Heathfield Road is well placed for accessing a wide range of local amenities in Wandsworth, Earlsfield, Northcote Road and Balham with Wandsworth Common station (National Rail) just a short distance away.

Features

- One Double Bedroom
- Open Plan Reception/Kitchen
- Large Private Garden
- Measuring Over 656 Sq Ft
- Allocated Underground Parking
- Superb Location

Heathfield Road, London, SW18

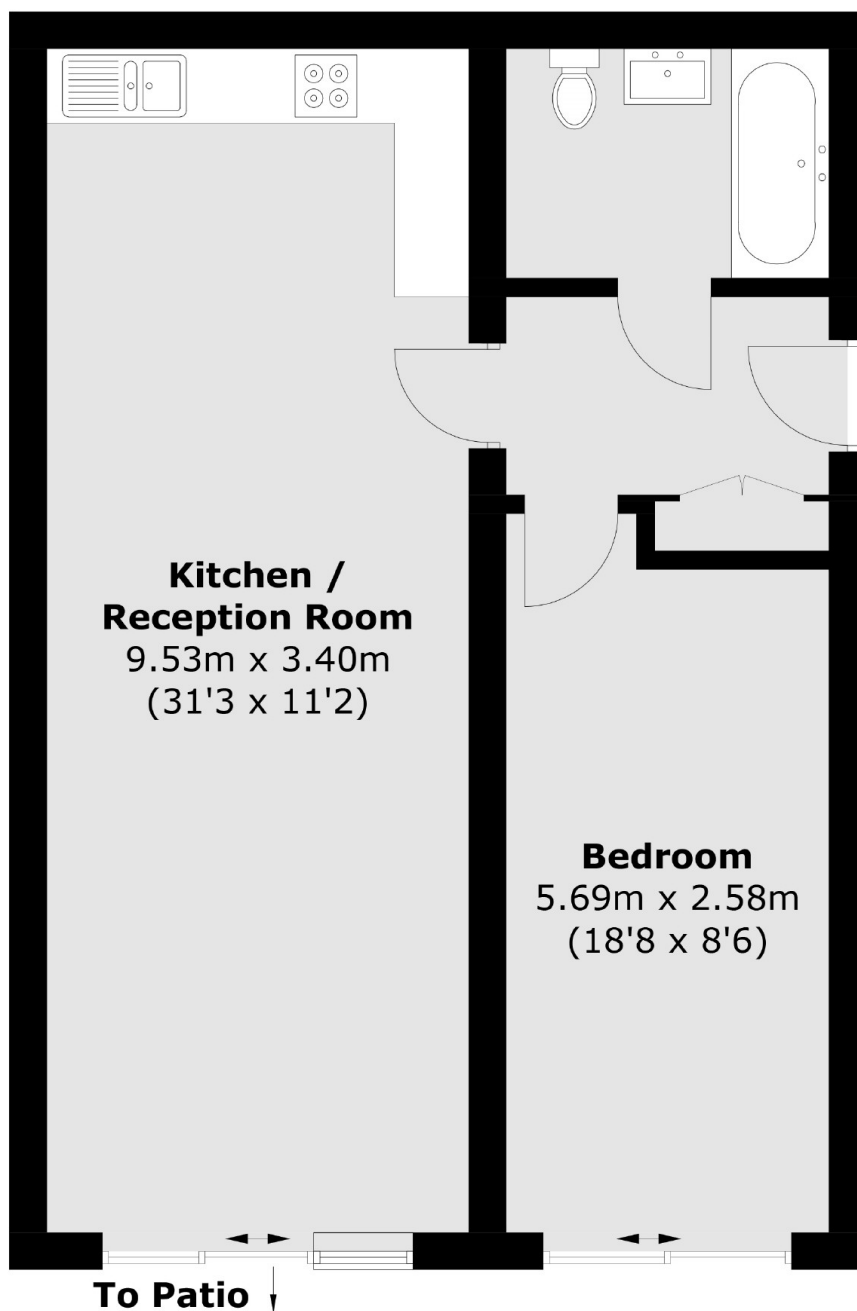

Total area (approx.): 61.0 sq. m (656.6 sq. ft)

Dexters

Northcote Road
93 St. John's Road
London
SW11 1QY
Sales
020 7483 6333

Energy Rating: C. We aim to make our particulars both accurate and reliable. However they are not guaranteed; nor do they form part of an offer or contract. If you require clarification on any points then please contact us, especially if you're traveling some distance to view. Please note that appliances and heating systems have not been tested and therefore no warranties can be given as to their good working order.

 **RICS** | Regulated
Estate Agent
and Letting Agent

dexters.co.uk