



Bennerley Road, SW11

£1,600,000

Dexters



Bennerley Road, SW11

A beautifully refurbished four double bedroom Victorian home located 'between the commons'. Comprising a double reception room, an open plan kitchen / diner, two bathrooms and a private South facing garden.

The ground floor comprises a bright double reception room to the front of the property with solid oak parquet flooring throughout along with a downstairs WC. The kitchen features a range of appliances, underfloor heating, an island and dining area that provides access into the garden. A perfect space for entertaining.

The first floor comprises a large principle bedroom, two further double bedrooms (one with vaulted ceilings) and family bathroom. The second floor houses a fourth double bedroom and second bathroom.

Bennerley Road is a quiet residential street moments from Northcote Road with both Clapham & Wandsworth Commons nearby. Transport links are fantastic with Clapham Junction overground station and Clapham South underground stations both accessible.

Features

- Between The Commons
- Four Double Bedrooms
- Two Bathrooms
- Downstairs WC
- Potential to Extend (STP)
- Private South Facing Garden







Bennerley Road, London, SW11

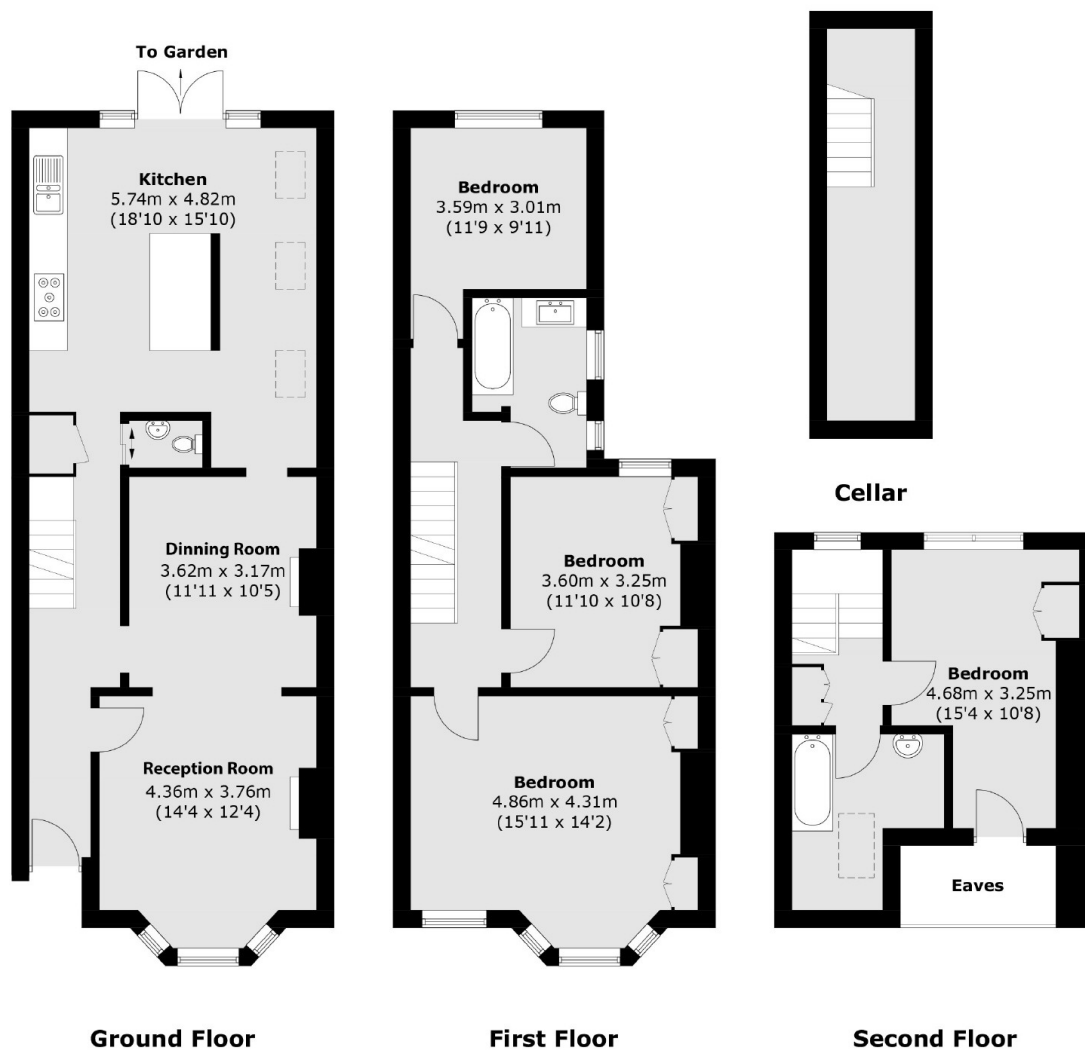

Total area (approx.): 156.8 sq. m (1,687.6 sq. ft)
(Excluding Eaves)