



## Wix's Lane, SW4

£325,000

A well located one double bedroom apartment. Accommodation includes an open plan reception room/kitchen, double bedroom and a modern bathroom. The property further benefits from a large communal garden with direct access and has a very long lease (Over 960 years).

Wix's Lane is a sought after quiet residential street located North of Clapham Common. It is situated in the catchment areas for some of the best schools; Eaton House, Parkgate House, and Belleville Wix Academy and is great for transport with both Clapham Junction station and Clapham Common tube a short stroll away.

### Features

- Open Plan Reception/Kitchen
- Modern Bathroom
- Large Communal Garden
- Superb Location
- One Double Bedroom
- Long Lease

# Wix's Lane, London, SW4



**(Not Shown In Actual  
Location / Orientation)**

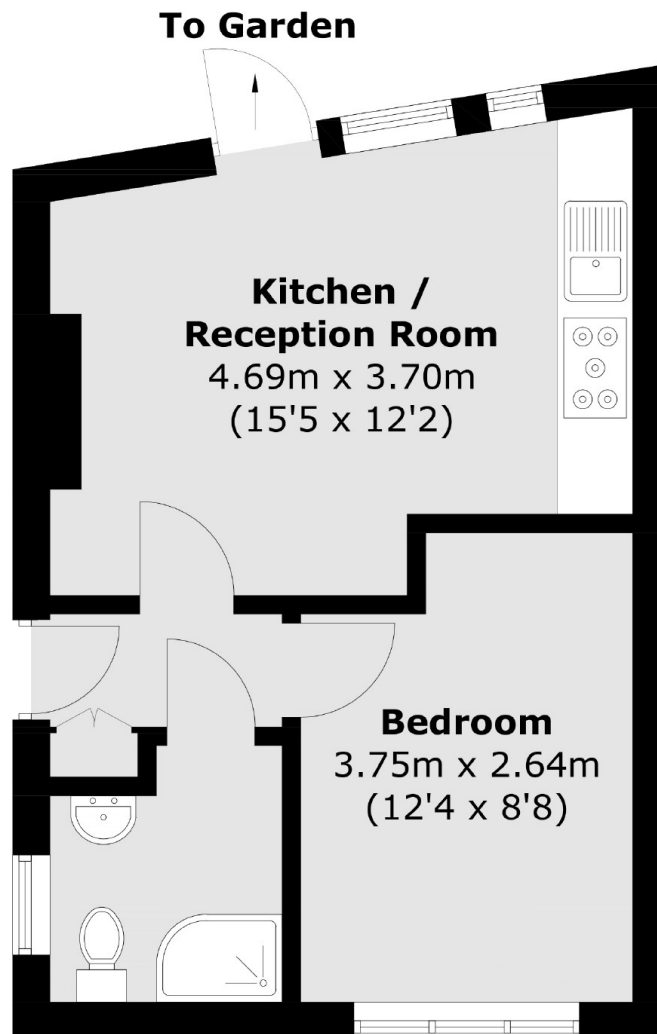

Total area (approx.): 31.7 sq. m (341.2 sq. ft)  
External Storage (approx.): 0.7 sq. m (7.5 sq. ft)