



108 Aspen Road, High Wycombe, Buckinghamshire, HP10 9GF

Asking Price | £1,300

Property Features

- A Stunning One Bedroom Apartment
- Located in the Abbey Barn Park Development
- A Newly Built Community In A Tranquil Countryside Setting
- High Standard Throughout
- Lift Access to Each Floor
- Allocated Parking
- Fitted Wardrobe in Bedroom
- Located Within a Short distance to High Wycombe Town Centre and Station
- Unfurnished
- Available 21st July 2025

Full Description

A stunning and modern one-bedroom apartment, located in the Abbey Barn Park Development, a newly built community in a tranquil countryside setting. This property was recently built by Berkeley Homes, this apartment is completed to an extremely high specification and offers modern, light, and airy accommodation.

The internal accommodation offers; communal entrance which offers lift access to each floor; entrance hallway; bathroom; bedroom with fitted wardrobes; storage cupboard; open plan living area/kitchen which has a range of appliances. The property is available now on an unfurnished basis.

High Wycombe has something for everyone- The town offers an array of restaurants and local pubs, making it the ideal destination to wine and dine. It also has an impressive shopping centre, Eden Shopping Centre, which includes a cinema complex for those who want to catch the latest movie releases.

Abbey Barn Place is where you can start the day with a peaceful morning stroll, and where you can step out your front door and enjoy a superb 34-acre country park. With woodland walks, a fitness trail, a wellness garden, play areas, allotments and a community orchard, there is something for everyone to enjoy.





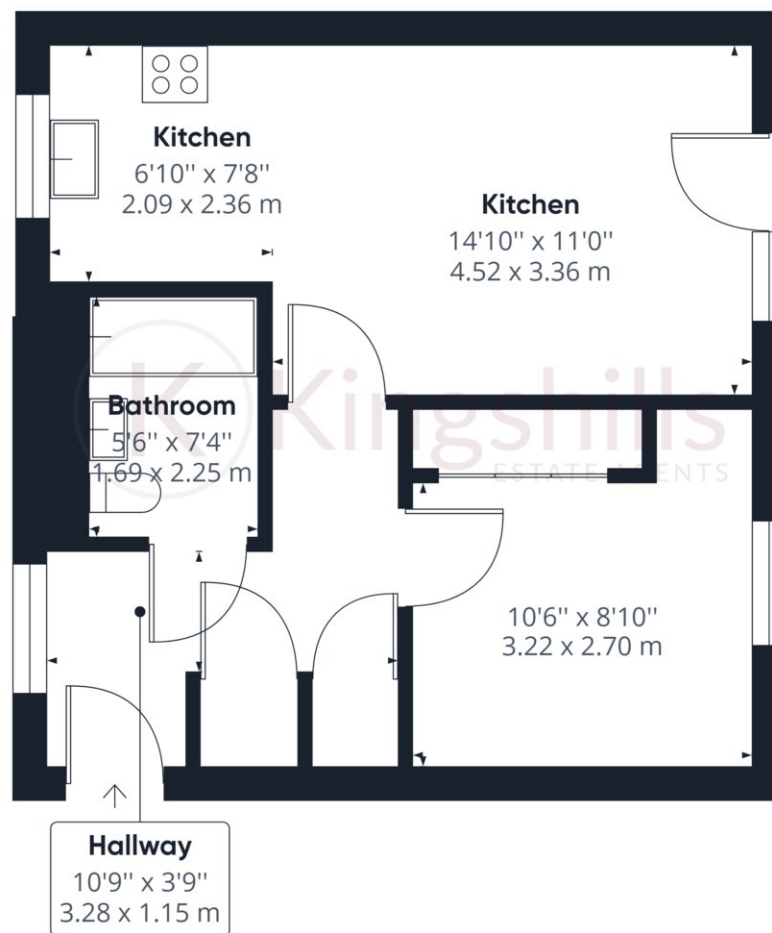

Approximate total area⁽¹⁾

473.73 ft²

44.01 m²

(1) Excluding balconies and terraces

While every attempt has been made to ensure accuracy, all measurements are approximate, not to scale. This floor plan is for illustrative purposes only.

GIRAFFE360