





## Property Description

Nestled in one of High Wycombe's most sought-after roads, this stunning two-bedroom flat with two en suites offers an unparalleled combination of luxury, comfort, and convenience. Set within an exclusive modern development, this property boasts contemporary design features and an enviable central location.

Upon entering, you are greeted by a spacious hallway leading to a bright and airy open-plan living area. The living space seamlessly integrates with a private balcony, perfect for relaxing or entertaining while enjoying the views. The kitchen is sleek and fully equipped with high-spec appliances, generous storage, and elegant countertops, making it an ideal space for culinary enthusiasts.

The property offers two well-proportioned bedrooms each with its own en suite. The principal bedroom has its own Jack and Jill en-suite bathroom (which can be accessed from the hallway and bedroom), fitted wardrobes, and large windows that flood the room with natural light. The second bedroom is equally inviting and can serve as a guest room or home office and has its own en-suite shower room.

Additional features include allocated parking, secure entry systems, and access to communal grounds and private parking. With its exceptional quality and prime location, this property is a fantastic opportunity for first-time buyers, young professionals, or investors.

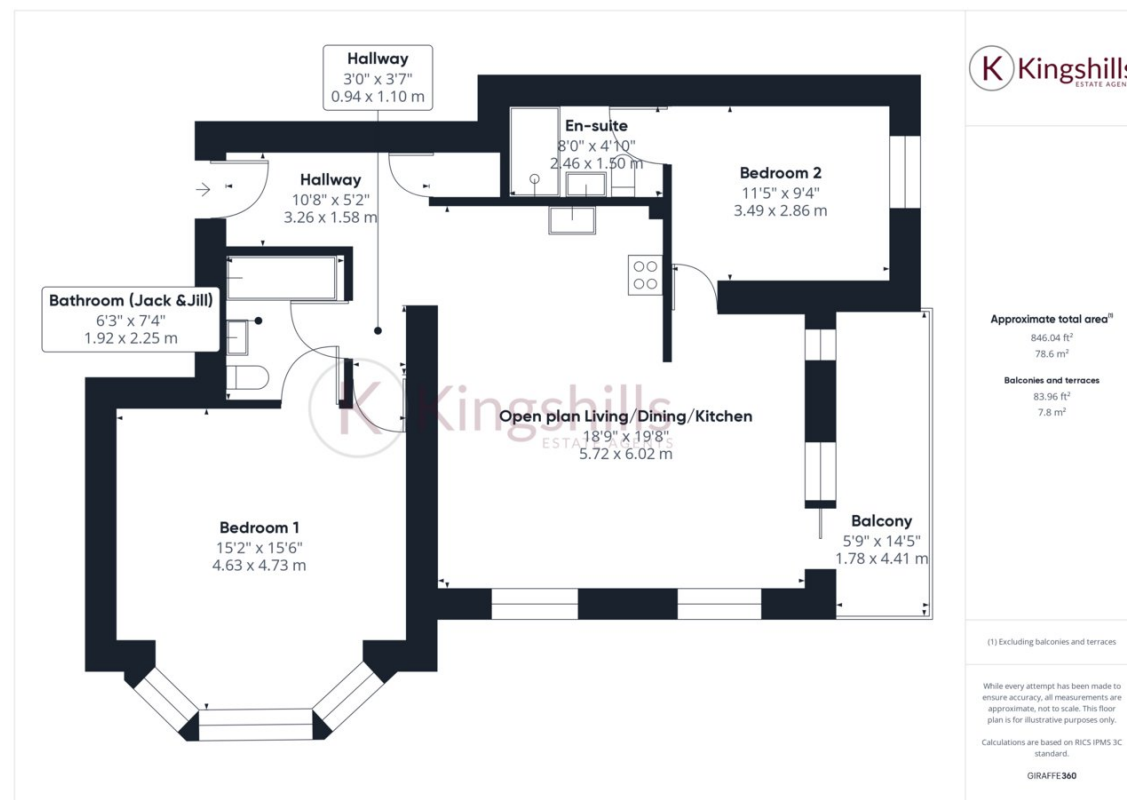

Kingshills Estate Agents  
Comet Studios  
Amersham  
Buckinghamshire  
HP7 0PX

01494 939868  
hello@kingshills.co.uk  
kingshills.co.uk

Agents Note: Whilst every care has been taken to prepare these particulars, they are for guidance purposes only. All measurements are for general guidance purposes only and whilst every care has been taken to ensure accuracy, they should not be relied upon and potential buyers/tenants are advised to recheck the measurements