



Farndale Gardens, Hazlemere, High Wycombe, Buckinghamshire, HP15 7HE

Asking Price | £1,750

Property Features

- Three Bedrooms House
- End Of Terrace
- Modern Interior
- Low Maintenance Rear Garden
- En-Suite Shower
- Sought After Location
- Close To Local Amenities
- Within Walking Distance To Local Schools
- No Pets
- Unfurnished

Full Description

An extremely well maintained three bedroom house, situated in this sought after location in Hazlemere, just a short distance to great local schools for all ages and the popular 'Cosy Corner' parade of shops. The ground floor is open and bright, and offers an entrance porch, lounge, dining room with patio doors to the garden and kitchen with a range of appliances. Upstairs is 2 double bedrooms, with the principle bedroom benefiting from an en-suite shower room and a further single bedroom/home office. Externally the property has a low maintenance garden to the rear with storage and to the front is driveway parking for 2 cars. Available unfurnished from early December.

Location

Situated on the Amersham side of Hazlemere, which is an established and pretty Chiltern village, just 10 minutes' away from the bustling centre of High Wycombe and 15 Minutes to the upmarket town of Amersham which both have great train links into London. You also have the added benefit of having easy access into London via the M40. A small selection of shops, pubs and cafes, make Hazlemere a fantastic base for commuters. The village also offers schools for both primary and secondary age groups, as well as being surrounded by countryside and woodland, offering the perfect location for walks and outdoor pursuits.







Ground Floor

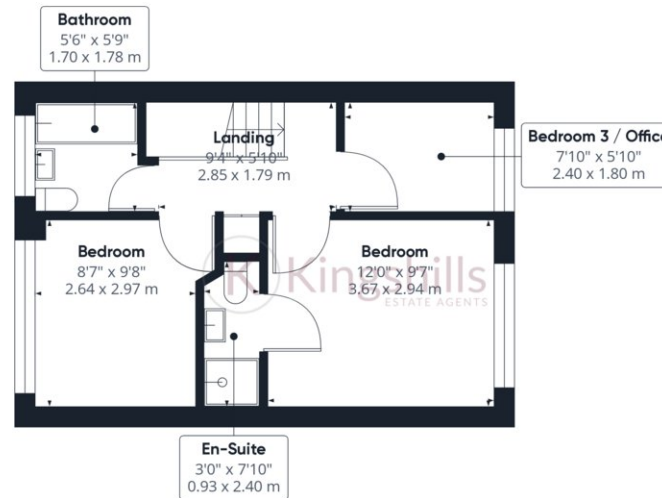

Floor 1

Approximate total area^m
736.57 ft²
68.43 m²

(1) Excluding balconies and terraces

While every attempt has been made to ensure accuracy, all measurements are approximate, not to scale. This floor plan is for illustrative purposes only.

Calculations were based on RICS IPMS 3C standard. Please note that calculations were adjusted by a third party and therefore may not comply with RICS IPMS 3C.

GIRAFFE360