



Property Features

- 3 Bedroom Family Home
- Surrounded by Open Countryside
- Open plan Kitchen/Dining Room
- Living Room with Fireplace
- Tranquil Village Location
- Train Stations at Amersham and Gt Missenden
- Courtyard Garden
- Informal Parking
- EPC 62D / Council Tax Band D
-

Full Description

Nestled in the heart of the picturesque village of Little Missenden, 19 Highmore Cottages offers a serene and tranquil lifestyle, surrounded by lush countryside while being just a short distance from the vibrant town of Amersham. This delightful 3-bedroom property is perfectly situated at the end of a quiet cul-de-sac, offering breathtaking views over farmland.

The cottage boasts a welcoming entrance hall that leads to the living room, perfect for relaxing or entertaining. The extended kitchen/dining room provides a modern and open space, ideal for family meals and gatherings. The property also features a family bathroom, three well-proportioned bedrooms, and a low-maintenance courtyard garden, offering a private outdoor space to enjoy the fresh country air. Informal parking is available at the front of the property on the quiet street.

Surrounded by stunning countryside, Little Missenden is a haven for outdoor enthusiasts. The area is crisscrossed with scenic walking trails, perfect for leisurely strolls or more adventurous hikes, where you can enjoy the beauty of the Chiltern Hills and spot local wildlife. Little Missenden itself is a quaint village, steeped in history, with a welcoming community, local pubs, and a tranquil atmosphere.

Families will appreciate the proximity of Little Missenden Church of England School, a well-regarded local primary school offering excellent education in a nurturing environment.





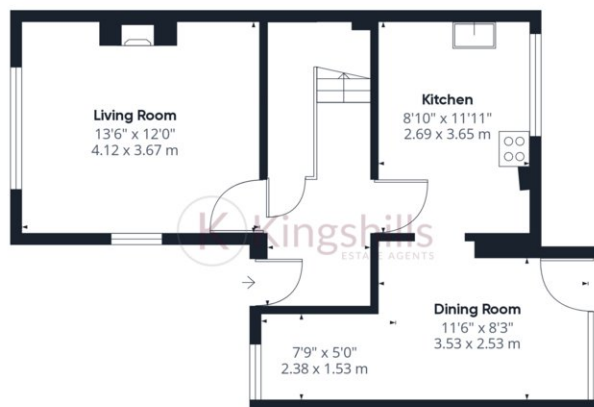

Ground Floor

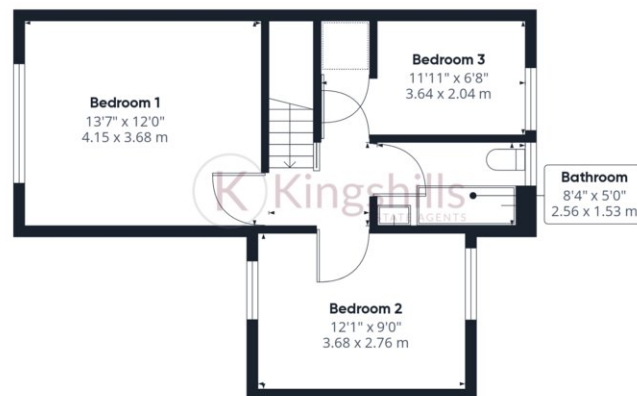

Floor 1

Approximate total area⁽¹⁾

906.11 ft²
84.18 m²

(1) Excluding balconies and terraces

While every attempt has been made to ensure accuracy, all measurements are approximate, not to scale. This floor plan is for illustrative purposes only.

Calculations are based on RICS IPMS 3C standard.

GIRAFFE360