



29a Amersham Hill, High Wycombe, Buckinghamshire, HP13 6NU

Asking Price | £1,600

## Property Description

A recently refurbished 3-bedroom split level apartment which would ideally suit 3 sharers/students, located just a stone's throw from High Wycombe train station. The property has recently had a stunning kitchen fitted. The accommodation comprises; private entrance; kitchen with a range of appliances; modern fitted bathroom; two bedrooms; stairs to a large basement bedroom. The property further benefits from an outside patio and residents parking which is on first come first served basis. An internal viewing is strongly recommended to appreciate the space and standard of accommodation. Available from 19th September 2024 on a part-furnished basis. EPC EER Rating E.

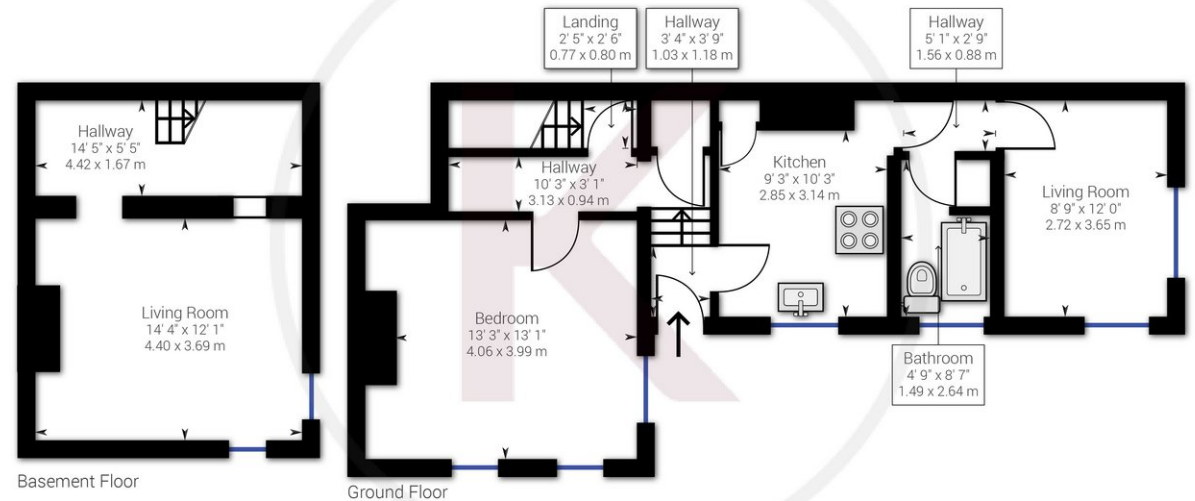

Approximate net internal area: 800.68 ft<sup>2</sup> / 74.39 m<sup>2</sup>  
While every attempt has been made to ensure accuracy, all measurements are approximate, not to scale. This floor plan is for illustrative purpose only and should be used as such by any prospective tenant or purchaser.

Powered by Giraffe360

Kingshills Estate Agents  
Comet Studios  
Amersham  
Buckinghamshire  
HP7 0PX

01494 939868  
hello@kingshills.co.uk  
kingshills.co.uk

Agents Note: Whilst every care has been taken to prepare these particulars, they are for guidance purposes only. All measurements are for general guidance purposes only and whilst every care has been taken to ensure accuracy, they should not be relied upon and potential buyers/tenants are advised to recheck the measurements