



3 Catkin Close, High Wycombe, Buckinghamshire HP12 4UZ

Asking Price | £395,000

Property Description

A link-detached two-bedroom bungalow located in a quiet cul-de-sac on the south-side of High Wycombe, close to transport links, the M40 motorway and amenities.

The property has been well maintained and benefits from driveway parking and a garage. Internally the accommodation comprises; entrance; kitchen with a range of appliances; living area with patio doors overlooking the rear garden; shower room and two bedrooms.

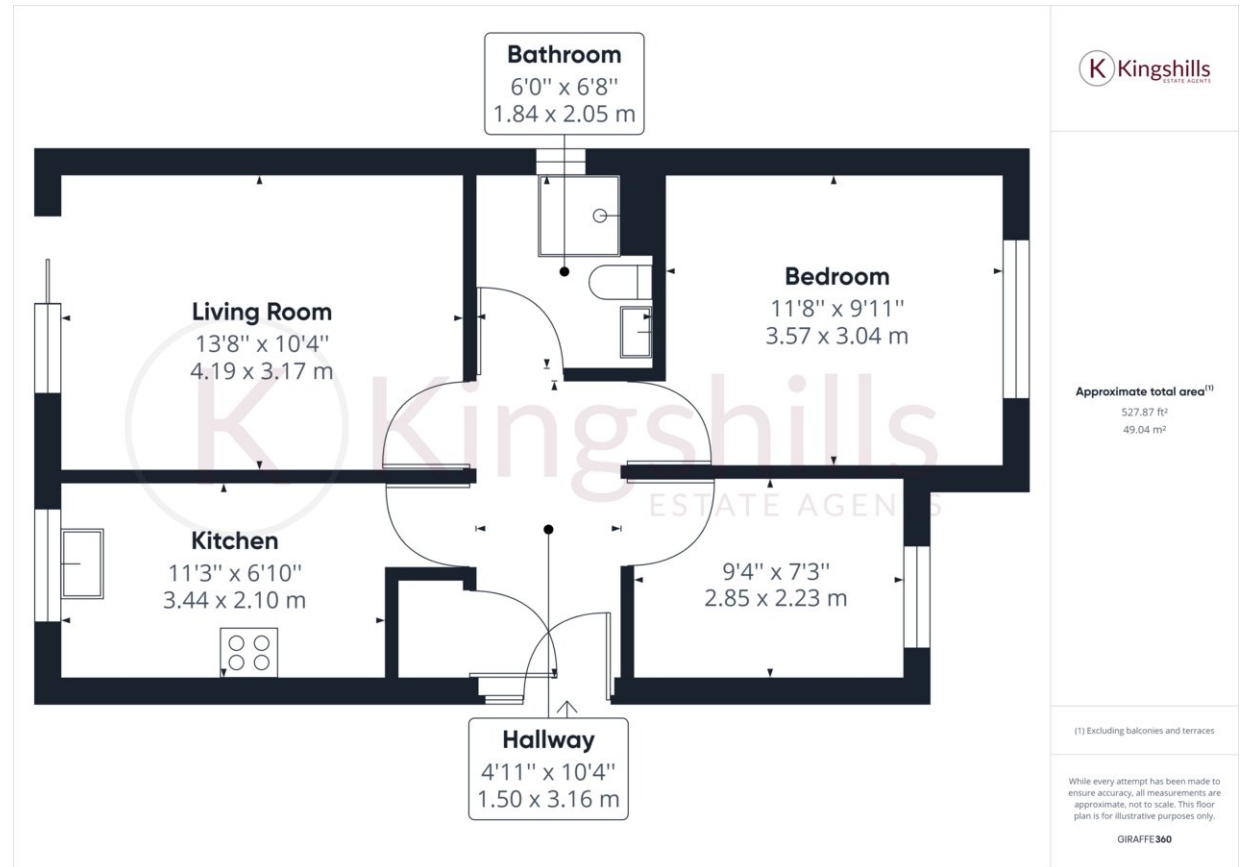

Kingshills Estate Agents
Comet Studios
Amersham
Buckinghamshire
HP7 0PX

01494 939868
hello@kingshills.co.uk
kingshills.co.uk

Agents Note: Whilst every care has been taken to prepare these particulars, they are for guidance purposes only. All measurements are for general guidance purposes only and whilst every care has been taken to ensure accuracy, they should not be relied upon and potential buyers/tenants are advised to recheck the measurements