



Silverwood, Hedgerley Hill, Hedgerley, Berkshire, SL2 3RL

Offers Over | £800,000

## Property Features

---

- Spacious Detached Chalet Bungalow
- Views to the front overlooking Village Green
- Shops and Bus Routes Close by
- 3/4 bedrooms
- 2/3 Reception Rooms
- Fitted Kitchen with Utility Room
- Level Garden and Large Summer House
- Parking for 3 to 5 cars

## Full Description

---

Welcome to Silverwood, a charming detached chalet bungalow nestled in the picturesque village of Hedgerley. Boasting versatile accommodation, this property offers an ideal blend of comfort, convenience, and space for modern living.

Flexibility is key with Silverwood, as depending on your families needs, this home could offer 3 or 4 bedrooms and 2 or 3 reception rooms and has over 1500 square feet in accommodation, within walking distance of the village centre with its duck pond, country pub and church. Hedgerley is surrounded by open countryside perfect for dog walking or a country stroll.

The ground floor hosts two or three bedrooms one with en suite bathroom offering the convenience of single-level living if desired, a spacious reception room, perfect for entertaining guests. Adjacent is a well-appointed kitchen, ample storage, walk in larder and utility room. Upstairs, you'll find an additional bedroom with en suite, offering privacy and comfort, ideal for accommodating family members or guests.

One of the standout features of Silverwood is its generous rear garden which is level and mainly laid to lawn stretching nearly 100 ft in length with hedging and a large patio There is a sizeable summer house at the rear with electrics and could be used as an outdoor office or gym.

Conveniently located, Silverwood is close to local transport links, making it easy to access nearby amenities and explore the surrounding area. With its idyllic setting and versatile accommodation, this charming chalet bungalow offers a wonderful opportunity to embrace the quintessential village lifestyle while enjoying the comforts of modern living. To the front there is parking for up to 5 cars.

There is the added bonus for over 60's The Tracey Trust please follow the link to find out more.  
<https://www.thetracytrust.co.uk>.





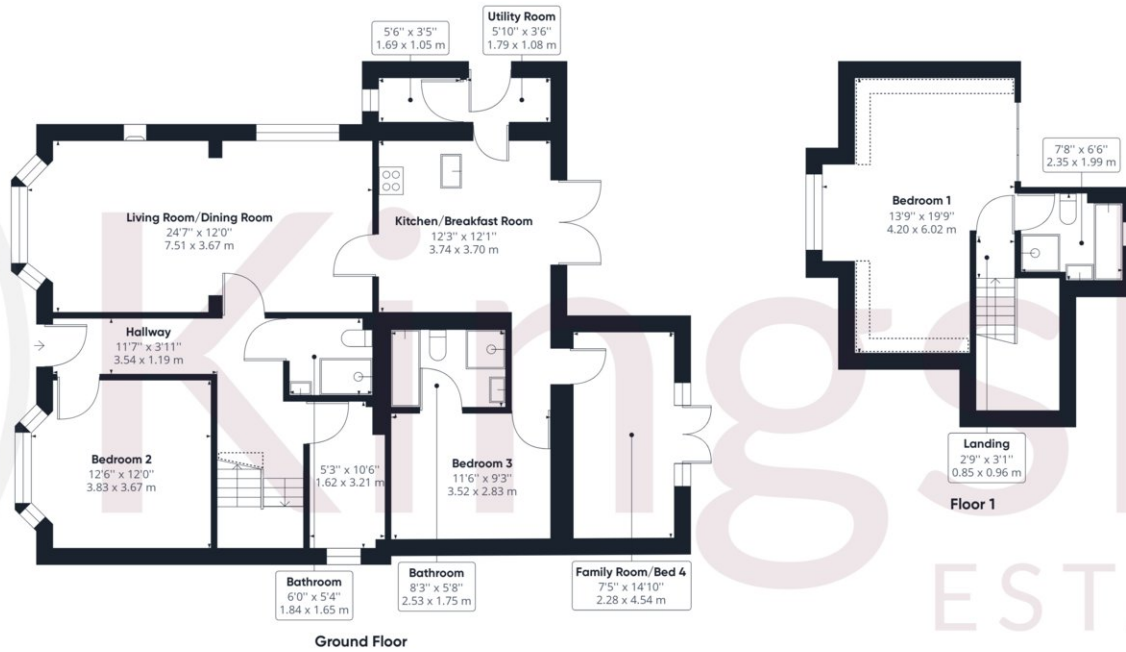

Approximate total area<sup>(1)</sup>

1432.59 ft<sup>2</sup>  
133.09 m<sup>2</sup>

Reduced headroom

40.40 ft<sup>2</sup>  
3.75 m<sup>2</sup>

(1) Excluding balconies and terraces

Reduced headroom  
(below 1.5m/4.92ft)

While every attempt has been made to ensure accuracy, all measurements are approximate, not to scale. This floor plan is for illustrative purposes only.

GIRAFFE360