



Selbon

Residential sales & lettings

Cranbrook Court, Fleet,
Hampshire, GU51 4QA
£300,000 Leasehold



01252 979300

Selbonproperty.co.uk

- Three Bedroom Maisonette
- Re-Fitted Kitchen
- Re-Fitted Bathroom
- Close to Fleet Town & Train Station
- Gas Central Heating & Double Glazed Windows
- First Floor
- 16ft. Living/Dining Room
- Permit Parking & Garage in a Block
- Ideal Investment Purchase or First Time Purchase
- Long Lease Approx. 940 Remaining

Selbon Estate Agents are delighted to offer this deceptively spacious first floor maisonette to the market, conveniently located within walking distance of Fleet town centre and main line railway station.

The property was granted a 999 year lease granted in 1964 with approx 940 years remaining. The ground rent is £20 per annum and the service charge is £86 per month (£1032 PA) and the property is an excellent first time or investment purchase.

Accessed via pathway leading to a double glazed front door, which gives access to the stairs leading to the first floor landing with doors leading to the lounge, kitchen, 3 bedrooms and bathroom as well as a storage cupboard.

The bright and airy 20ft bay fronted lounge/dining room has views over the front garden with space for table and chairs, the second double bedroom is front aspect and has a built in storage cupboard, bedroom one is a generous double bedroom over looking the communal grounds to the rear of the home and boasts built in wardrobes. The third bedroom is a good size single, ideal as a guest room or home office, the bathroom has been re-fitted with a white suite with a bath and separate shower cubicle, the accommodation is completed by a re-fitted kitchen with some built in appliances.

The property further benefits from gas central heating, double glazed windows, communal grounds to the front and rear, there is a single garage in a nearby block as well as there being permit parking available (one permit per home).

Fleet mainline train station and town centre are within close proximity. The town centre offers an array of shops, bars and restaurants. For those who like the outdoors, there is easy access to walking, running and cycling routes including Elvetham Heath nature reserve, Fleet Pond, Edenbrook Countrypark, Velmead woods, Caesars Camp and the Basingstoke canal to name a few.

The M3 motorway and access to the A30 are also within easy reach.











Close to Fleet Town Centre, Fleet Pond & Mainline Train Station



Floor Plans

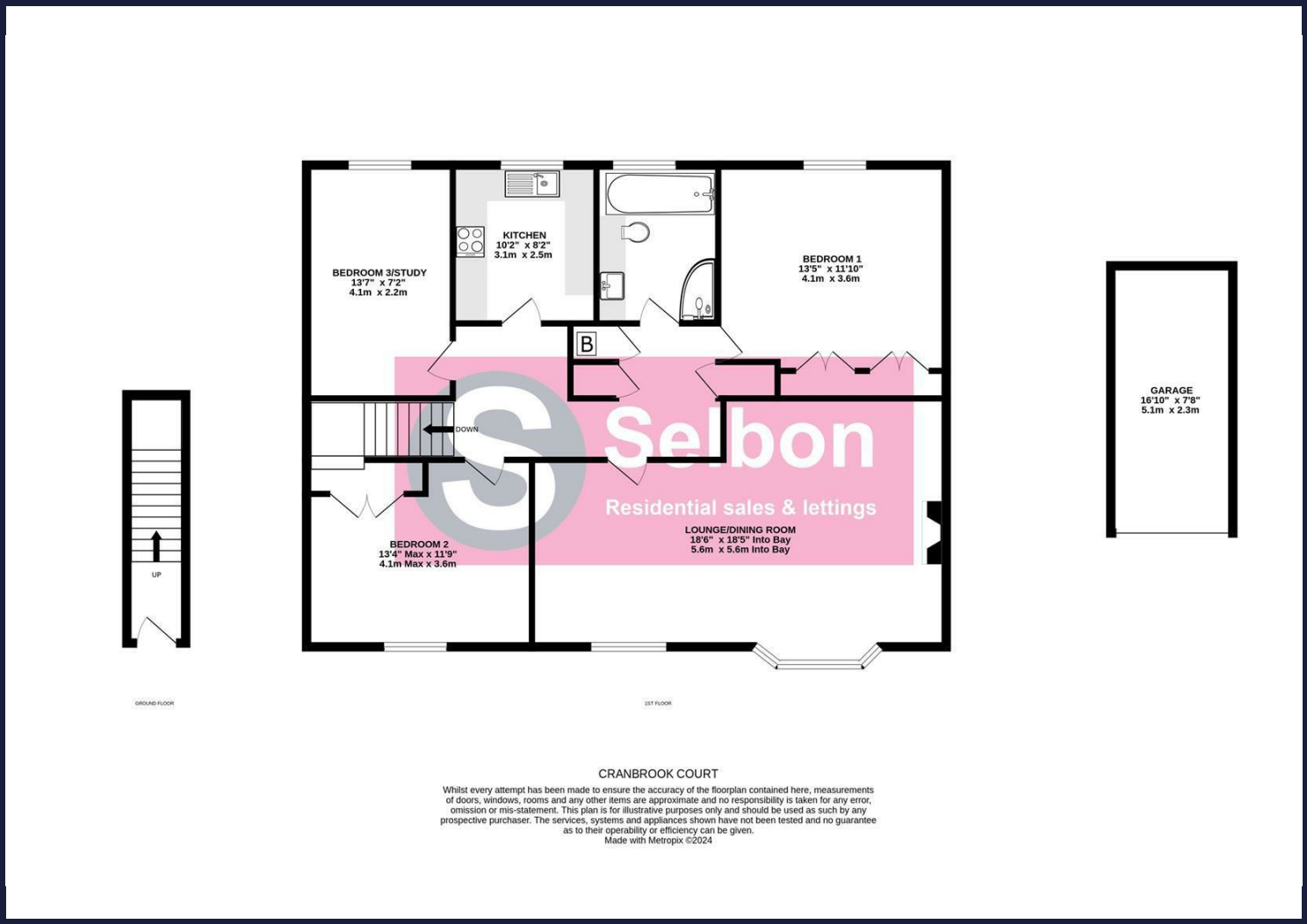

Area Map



Energy Performance Graph

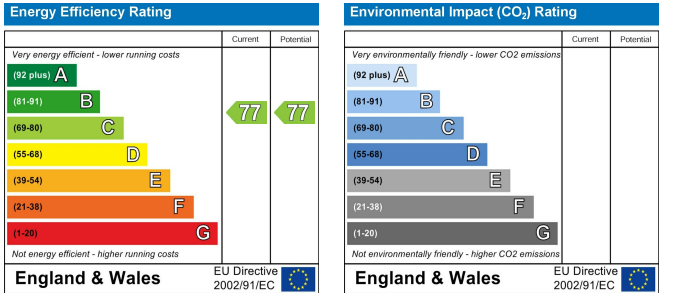

Viewing

For further information on this property or to arrange a viewing please contact Selbon Estate Agents on 01252 979300

We give notice that these particulars are produced in good faith and in accordance with the Consumer Protection from Unfair Trading Regulations 2008 (CPR). They are set out as a general guide only and do not constitute any part of a contract or warranty whatsoever. Intending purchasers should not rely on them as statements of representation of fact, but must satisfy themselves by inspection or otherwise as to their accuracy. No person in the employment of Selbon has any authority to make or give any representation or warranty whatever in relation to the property. A detailed survey has not been carried out nor have the services, heating systems, appliances or specific fittings been tested. Any photograph incorporated within these particulars shows only certain parts of the property and it must not be assumed that any contents or fixtures and fittings shown in the photographs are either included with the property or indeed remain in it. Room sizes shown and any floor plans should not be relied upon for carpets and furnishings. If there is any point which is of particular importance to you we will be pleased to check the information for you and confirm that the property remains available. This is particularly important if you are contemplating travelling some distance to view the property.

Council Tax Band: C