



Selbon

Residential sales & lettings

Castle Street, Fleet,
Hampshire, GU52 7ST

Offers over £550,000 Freehold



01252 979300

Selbonproperty.co.uk

- Edwardian Character Property
- Two Generous Reception Rooms
- Re-Fitted Family Bathroom & En-Suite
- Period Features Including Sash Windows
- Extended & Re-Furbished
- Three Bedrooms
- Re-Fitted Kitchen/Breakfast/Utility Room
- Approx. 50ft. South Facing Rear Garden
- Garage & Parking
- Close to Local Schools & Town Centre

Selbon Estate Agents are delighted to offer to the market this charming Edwardian three bedroom semi-detached family home, offered for sale in excellent decorative order throughout and within a stones throw from local schools.

Built in the early 1900's the property benefits from a two storey extension to the rear and offers fantastic accommodation. The current school catchment areas include: Heatherside Infant and Junior schools and Court Moor Secondary school.

As you step inside you are welcomed into a porch which leads into the hallway with stairs to the first floor. The ground floor accommodation boasts a cloakroom, living room and family/dining room which opens to a kitchen/breakfast/utility room.

The kitchen comprises; eye and base level cupboard and drawer units. Inset sink with mixer tap, built-in oven, hob and extractor over. There is space in the kitchen for a table and French doors which lead to the rear garden.

To the first floor are three bedrooms and a re-fitted family bathroom. The bathroom boasts an L-shaped bath with mixer tap with shower over, hand wash basin and W.C.

Bedroom one benefits from a re-fitted en-suite shower room with shower cubicle, hand wash basin and W.C. Both bathrooms are complimented with tiled flooring and part-tiled walls.

Externally the Southerly facing rear garden measures approximately 50ft. in length and is predominately laid to patio. At the rear of the property is a courtesy door to the garage.

To the property is enclosed by picket fencing and evergreen borders. To the side is a shared driveway which leads to parking and a garage. Further on-street parking is available.

The location is excellent with Fleet town centre approximately 0.5 miles away with an array of shops, bars and restaurants, Fleet mainline railway station and access to the M3 are also only a short distance away. There is also easy access to walking, running and cycling routes including the Basingstoke Canal.

















Floor Plans

Area Map

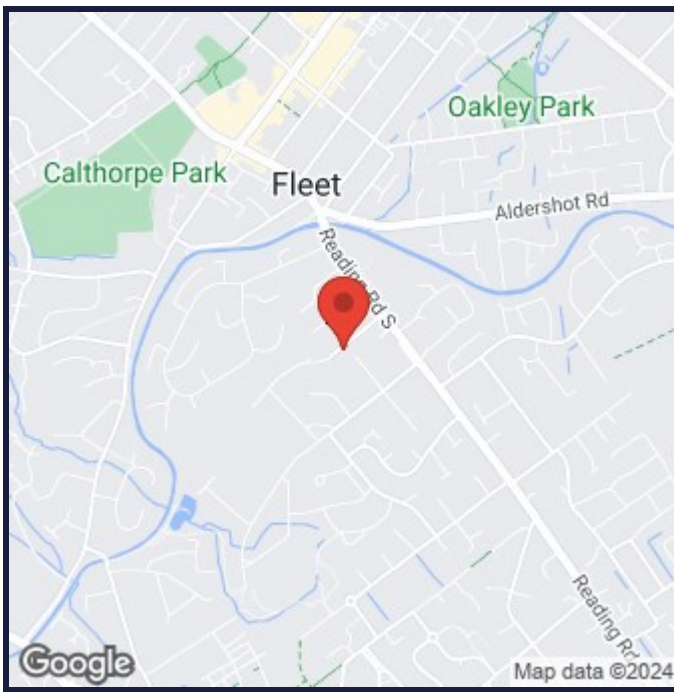
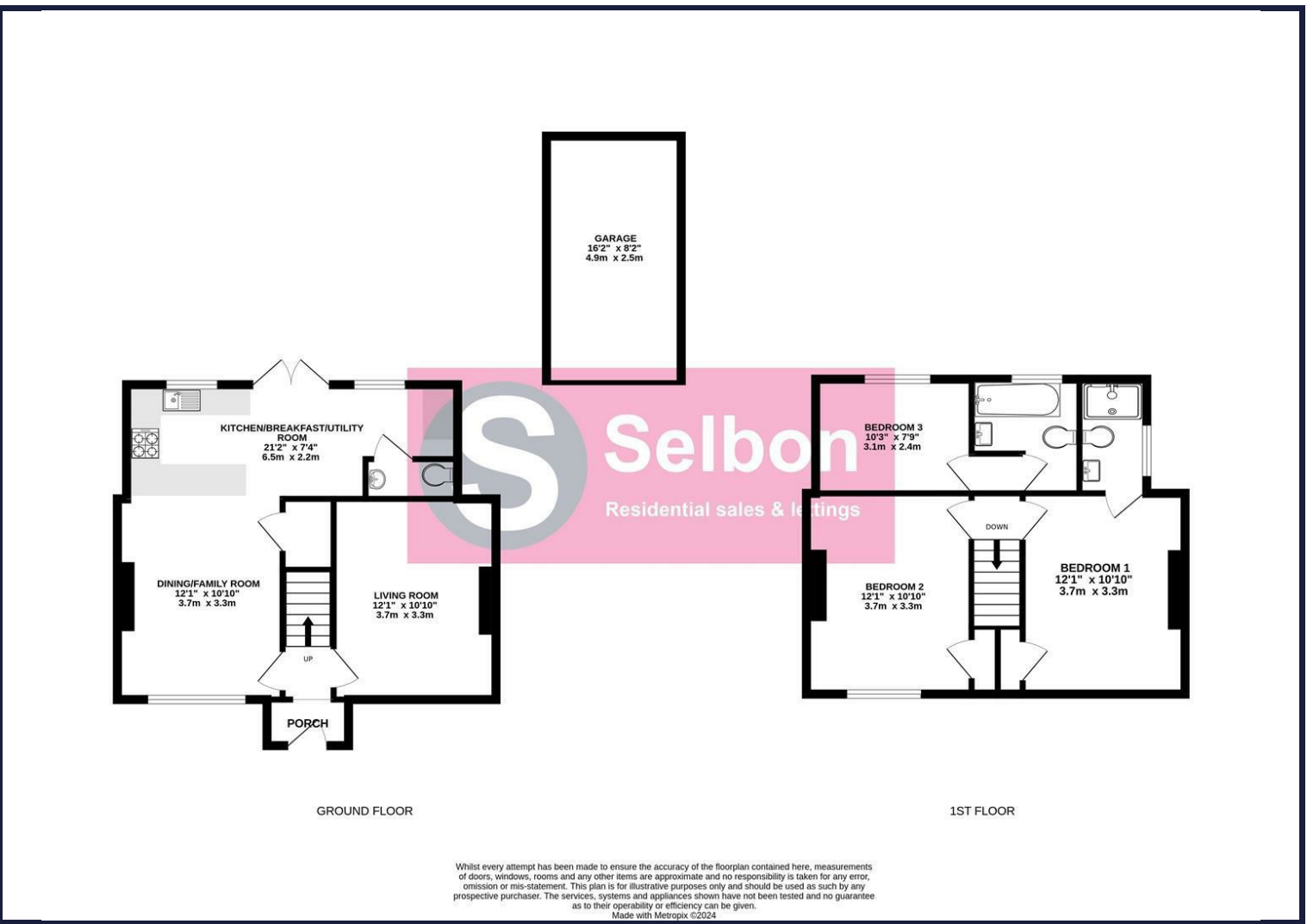

Energy Performance Graph

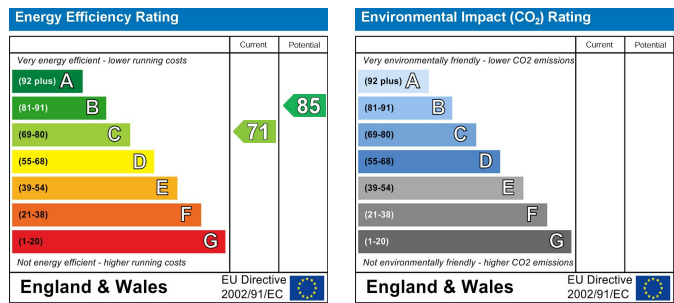

Viewing

For further information on this property or to arrange a viewing please contact Selbon Estate Agents on 01252 979300

Council Tax Band: D

We give notice that these particulars are produced in good faith and in accordance with the Consumer Protection from Unfair Trading Regulations 2008 (CPR). They are set out as a general guide only and do not constitute any part of a contract or warranty whatsoever. Intending purchasers should not rely on them as statements of representation of fact, but must satisfy themselves by inspection or otherwise as to their accuracy. No person in the employment of Selbon has any authority to make or give any representation or warranty whatever in relation to the property. A detailed survey has not been carried out nor have the services, heating systems, appliances or specific fittings been tested. Any photograph incorporated within these particulars shows only certain parts of the property and it must not be assumed that any contents or fixtures and fittings shown in the photographs are either included with the property or indeed remain in it. Room sizes shown and any floor plans should not be relied upon for carpets and furnishings. If there is any point which is of particular importance to you we will be pleased to check the information for you and confirm that the property remains available. This is particularly important if you are contemplating travelling some distance to view the property.