



2 1 1

Wilton Road, Bexhill on Sea, TN40 1HX
£1,150 Per Calendar Month



Oliver & Bailey

01424 834000 | 01424 533 555

Info@oliverbaileylettings.co.uk
www.oliverbaileylettings.co.uk

Entrance Hallway

Living Room

17'6" x 12'0" (5.34m x 3.67m)

Bedroom

14'0" x 6'6" (4.27m x 1.99m)

Bedroom

14'2" x 8'10" (4.34m x 2.71m)

Bathroom

5'5" x 6'2" (1.66m x 1.90m)

Kitchen

9'6" x 6'0" (2.91m x 1.85m)

Furnished Options: Unfurnished

Council Tax Band: A

Available Date: 4th June 2025

Oliver & Bailey



BRIGHT AND WELL PRESENTED TWO BEDROOM APARTMENT... Call Georgia or Robyn at Oliver & Bailey to view this apartment located on the first floor of a converted building.

Situated in the heart of Bexhill Town Centre, the apartment is positioned walking distance to the sea front promenade, Bexhill main Line Train Station and all the amenities Bexhill Town Centre has to offer.

Recently decorated throughout, the apartment boasts a Large living room with floor to ceiling sash windows opening onto a Juliette balcony and offering partial sea views, there are two bedrooms, bathroom with shower over a bath and a kitchen to the rear of the property with integrated oven/hob.

Further benefits are gas central heating and double glazing throughout.

FLOORPLAN

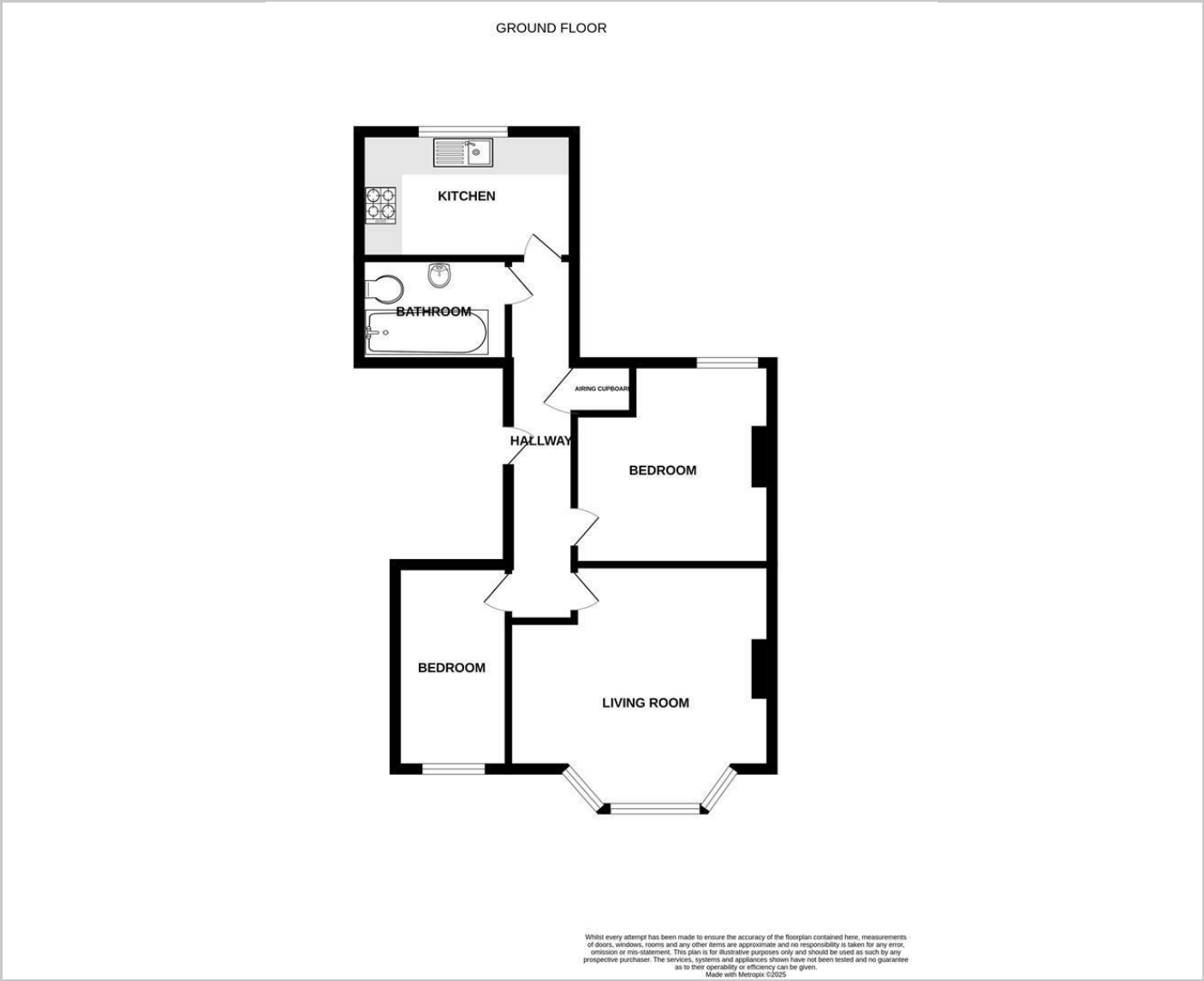

AREA MAP

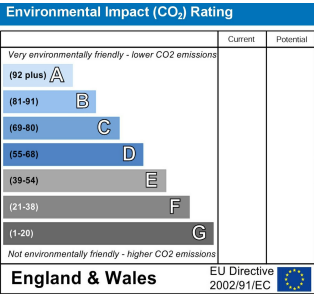
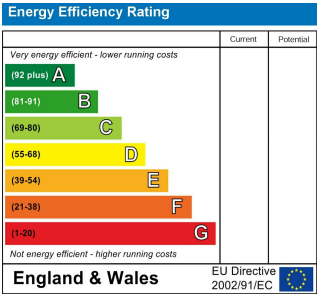
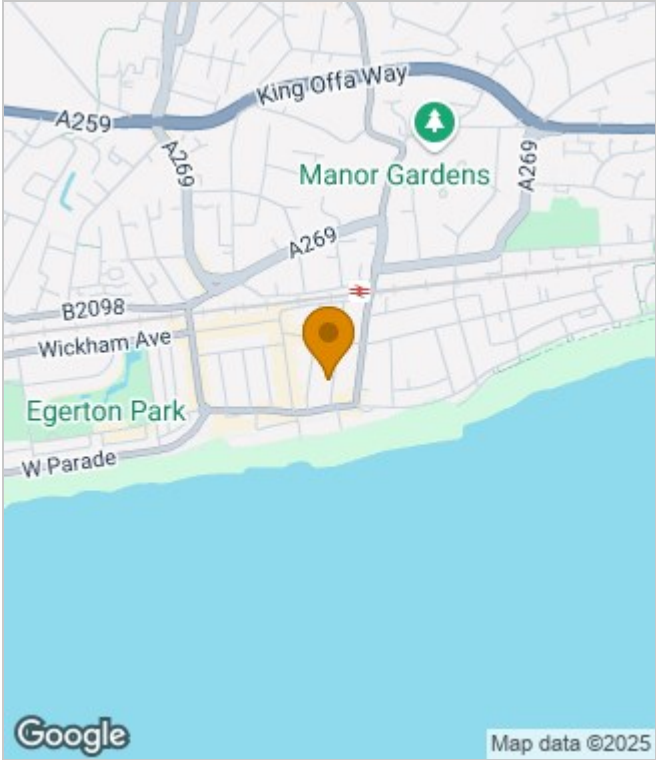

These particulars, whilst believed to be accurate are set out as a general outline only for guidance and do not constitute any part of an offer or contract. Intending purchasers should not rely on them as statements of representation of fact, but must satisfy themselves by inspection or otherwise as to their accuracy. No person in this firms employment has the authority to make or give any representation or warranty in respect of the property.