

Axminster Branch

5 South Street
Axminster
Devon
EX13 5AD
01297 33449
sales@vicaryandco.com

vicaryandco.com

Bridport Branch

38 South Street
Bridport
Dorset
DT6 3NN
01308 459550
info@vicaryandco.com

Vicary & Co

Chartered Surveyors & Property Agents

Estate Agents & Valuers
Residential - Commercial - Rural



4 Cherry Tree, Bridport, Dorset, DT6 5HQ
Guide Price £280,000



4 Cherry Tree, Bridport, Dorset, DT6 5HQ

Guide Price £280,000

Positioned in a popular residential area on the Northern side of Bridport town, this three bedroom terraced property enjoys views across to Allington Hill and is conveniently located within a walkable distance to the town centre.



Property Details

- Three bedroom family home
- Convenient location
- Enclosed and low maintenance rear garden
- Views towards Allington Hill

THE PROPERTY

This beautifully presented three-bedroom terraced home is set in the popular Cherry Tree area, perfectly blending convenience with a touch of countryside charm. It is ideally located close to Bridport Community Hospital, scenic walking routes, and within easy reach of Bridport town centre, making it an excellent choice for family life.

The property has been thoughtfully upgraded by its current owners and is in excellent condition throughout. A welcoming porch and hallway leading into a bright and spacious lounge with under stair storage, featuring two front-facing windows and a front garden with views of Allington Hill.

To the rear, the kitchen and dining area create a practical and sociable space. The kitchen is fitted with stylish wood-effect wall and base units, a built-in electric oven, and space for household appliances. A door from the dining area opens directly onto the rear garden.

Upstairs, there are three double bedrooms, a convenient airing cupboard, and a modern family shower room. The main bedroom is generously sized with plenty of room for freestanding wardrobes. The shower room has been tastefully refurbished and features a walk-in shower, wash hand basin, and WC.

The property benefits from gas central heating and double-glazed windows throughout.

OUTSIDE

The rear garden is mainly laid to lawn and includes a pathway leading to a decking area adjacent to the house—perfect for **relaxing or entertaining**. There is also a nearby children's play area for local residents. On-street parking is available at the front of the property on a first-come, first-served basis along Cherry Tree.

SITUATION

Bridport is renowned for its friendly and vibrant culture, and fantastic reputation for quality local food and art. Facilities include a post office, arts centre, theatre, leisure centre, library, cinema and museum. Local schools are within easy reach. There are also regular bus services to Axminster, Lyme Regis, Beaminster, Yeovil, Dorchester, Weymouth and Poole.

PROPERTY TENURE

Freehold

Subject to a Dorset Section 157 Restriction.

INFORMATION

Heating Type: Gas central heating

Construction Type: Concrete tiled roof.

Broadband: Standard & Superfast Available (Ofcom Data)

Mobile phone coverage: Good outdoor and variable indoors on some major networks.

Parking: on street, first come first serve.

SERVICES

Mains electricity, Gas, Water and drainage.

Council Tax Band: B (Dorset Council)

EPC: C (71)

VIEWINGS

Strictly by appointment only with Vicary & Co



Cherry Tree, Bridport, DT6 5HQ, GB

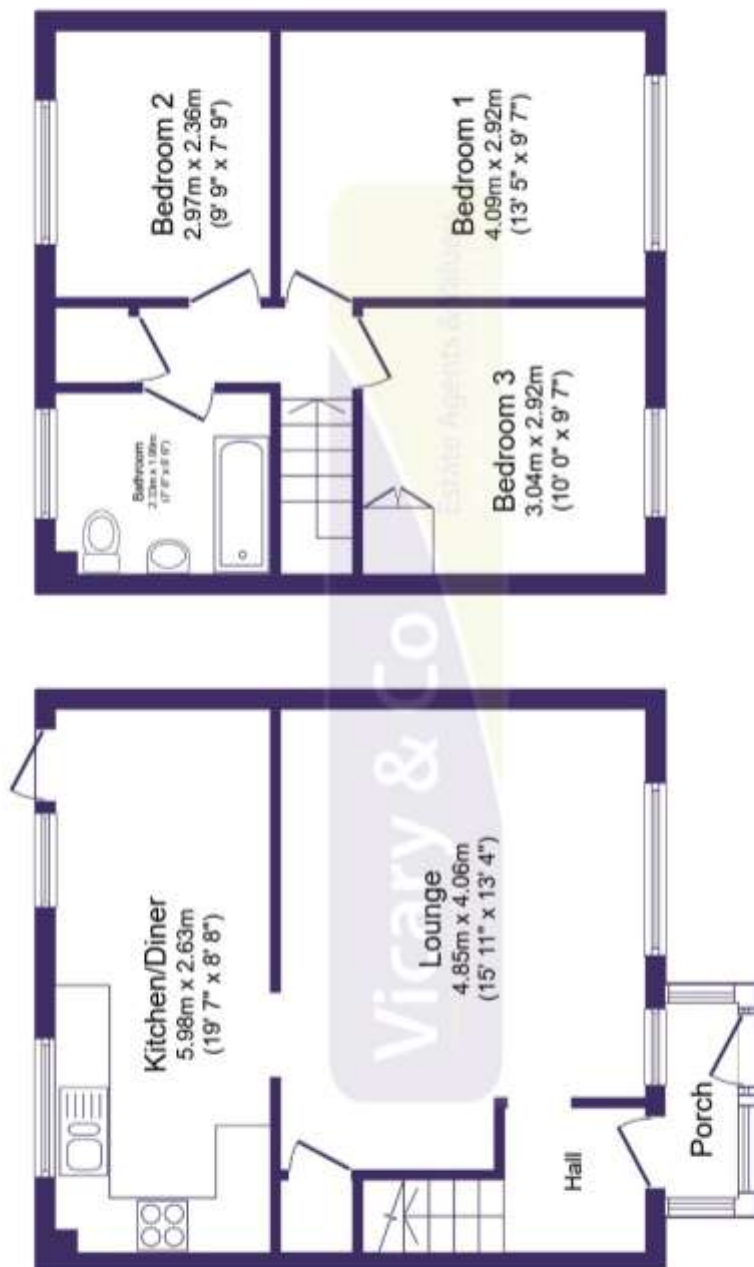

This floor plan is for illustrative purposes only. It is not drawn to scale. Any measurements, floor areas (including any total floor area), openings and elevations are approximate. No details are guaranteed, they cannot be relied upon for any purpose and do not form any part of any agreement. No liability is taken for any error, omission or misstatement. A party must rely upon its own inspection(s). Powered by www.Propertybox.co.uk



Important Information:
All measurements are approximate. We have not tested any appliances or services within this property and cannot verify them to be in working order or within the vendors/s ownership. We have not verified the tenure of the property, type of construction or the condition thereof. Intending purchasers should make appropriate enquiries through their own solicitors and surveyor etc, prior to exchange of contract.

Axminster Branch
5 South Street
Axminster
Devon
EX13 5AD
01297 33449
sales@vicaryandco.com

Bridport Branch
38 South Street
Bridport
Dorset
DT6 3NN
01308 459550
info@vicaryandco.com

Vicary & Co
Chartered Surveyors & Property Agents

Estate Agents & Valuers
Residential - Commercial - Rural



vicaryandco.com