



55/57 Whitworth Street

Manchester, M1 3NT

Asking Price Of £149,950

South Manchester Homes are pleased to offer for sale this studio apartment in 55-57 Whitworth Street in Manchester City Centre. The apartment is located close to Piccadilly & Oxford road train station and is part of the well maintained Granby Village development which has access to a private leisure centre which includes a gym, games room, swimming pool, jacuzzi and steam room. The apartment briefly comprises of hallway, living area, fitted kitchen with base and eye level units, sleeping area with fitted wardrobes and bathroom with 3 piece suite with shower above the bath. The property has allocated parking and is offered with no onward chain.



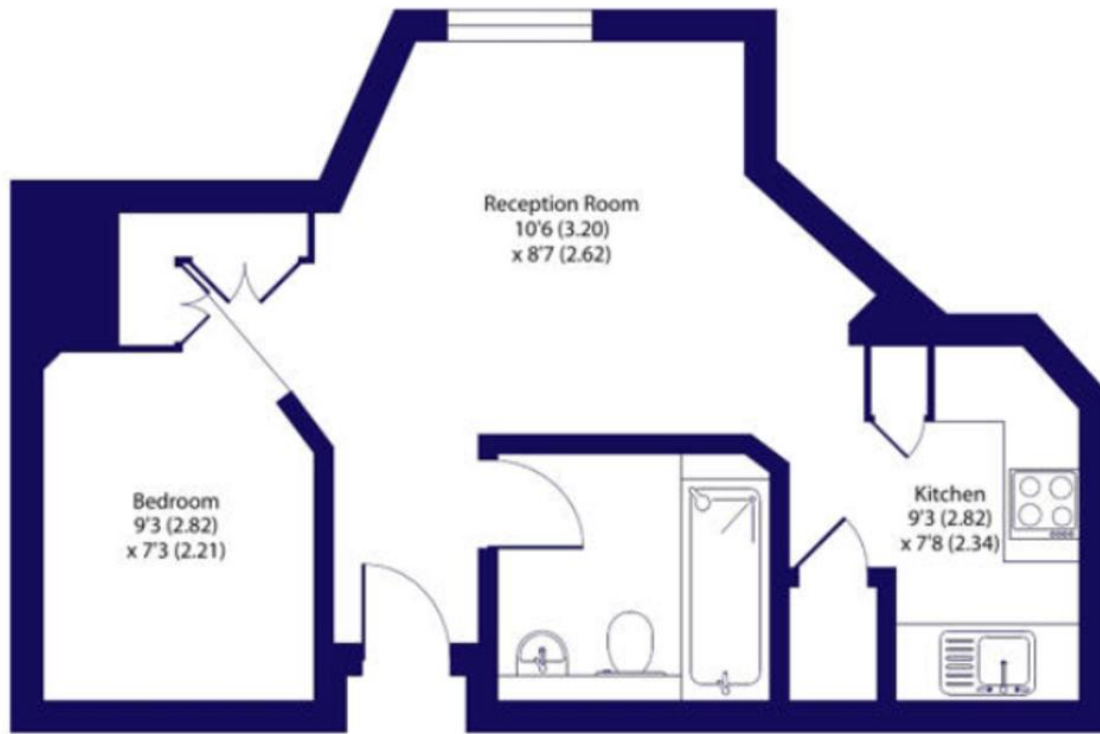

GROUND FLOOR



Score	Energy rating	Current	Potential
92+	A		
81-91	B		
69-80	C		79 C
55-68	D	63 D	
39-54	E		
21-38	F		
1-20	G		

Suite 97, 792 Wilmslow Road,
Manchester, Lancashire, M20
6UG

www.southmanchesterhomes.co.uk
0161 434 2000
info@smcrhomes.co.uk

Agents Note: Whilst every care has been taken to prepare these particulars, they are for guidance purposes only. All measurements are approximate and are for general guidance purposes only and whilst every care has been taken to ensure their accuracy, they should not be relied upon and potential buyers/tenants are advised to recheck the measurements.