



- En-suite rooms
- Good condition
- Great location
- Victorian Detached

20 Pine Road, Didsbury, Manchester, M20 6UZ

£525 pcm

South Manchester Homes are pleased to offer for rent this studio room on Pine Road in Didsbury. A self contained room in a beautiful converted Victorian detached house includes gas, water, electricity, council tax and the internet. The property is located on the ground floor of the building and has views over the front garden. There is a large communal living room, two large kitchens and access to washing machines. This property is ideal for someone who is looking for great value close to both Didsbury Village and West Didsbury. Viewing recommended. Available 31.08.21



GROUND FLOOR

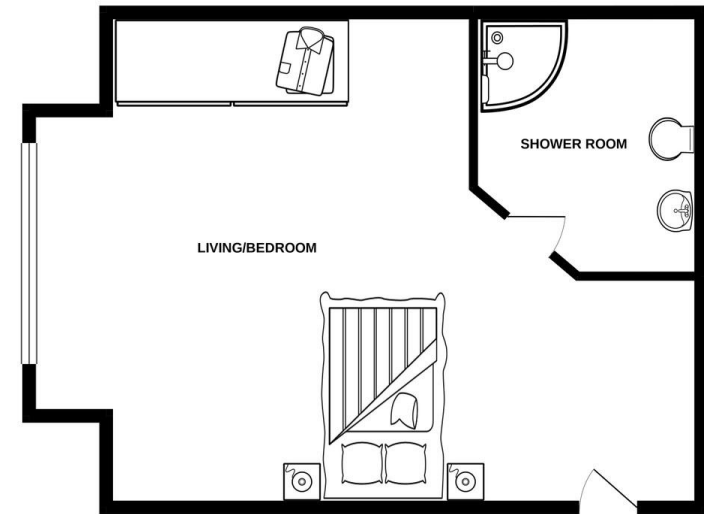

Whilst every attempt has been made to ensure the accuracy of the floorplan contained here, measurements of doors, windows, rooms and any other items are approximate and no responsibility is taken for any error, omission or mis-statement. The plan is for guidance purposes only and should be used in such by any prospective purchaser. The services, systems and appliances shown have not been tested and no guarantee is given as to their operability or efficiency can be given.
Made with Metropix (2021)



Suite 97, 792 Wilmslow Road,
Manchester, Lancashire, M20
6UG

www.southmanchesterhomes.co.uk
0161 434 2000
info@smcrhomes.co.uk

Agents Note: Whilst every care has been taken to prepare these particulars, they are for guidance purposes only. All measurements are approximate and are for general guidance purposes only and whilst every care has been taken to ensure their accuracy, they should not be relied upon and potential buyers/tenants are advised to recheck the measurements