



4 Wineva Gardens

, Liverpool, L23 9SJ

Asking price £295,000



Nestled in the tranquil cul-de-sac of Wineva Gardens, this EXTENDED three-bedroom semi-detached home presents an excellent opportunity for those looking to create their dream residence. While the property is in need of modernisation, it boasts significant potential for transformation into a stylish and comfortable family home.

Upon entering, you are welcomed into a front lounge that offers a warm and inviting space for relaxation. The extended rear dining and seating area provides ample room for entertaining guests or enjoying family meals, with convenient access to the kitchen, making it a practical layout for everyday living.

Upstairs, you will find three well-proportioned bedrooms, perfect for accommodating family members or guests. The family bathroom is also located on this level.

Externally, the property features a generous garden, ideal for outdoor activities and gardening. Additionally, there is parking available to the front, ensuring convenience for residents.

This property is a blank canvas, ready for your personal touch and vision. With its desirable location and ample space, it is an opportunity not to be missed for those looking to invest in a home with great potential in Crosby



Area Map

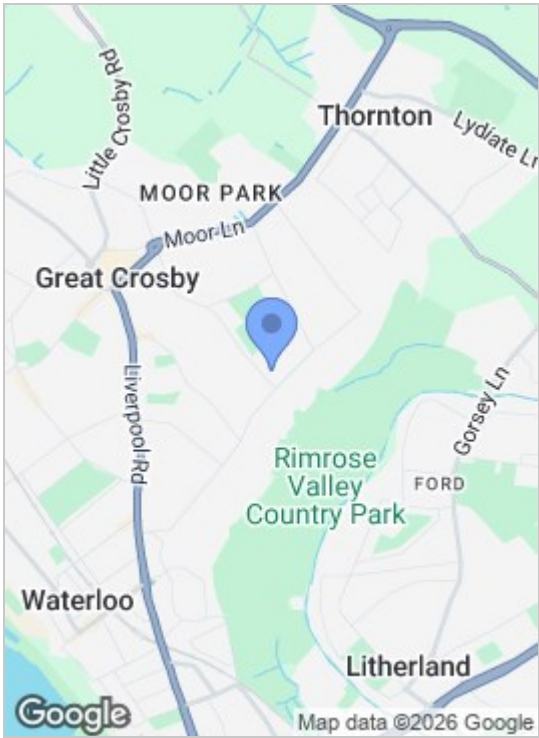

Floor Plans

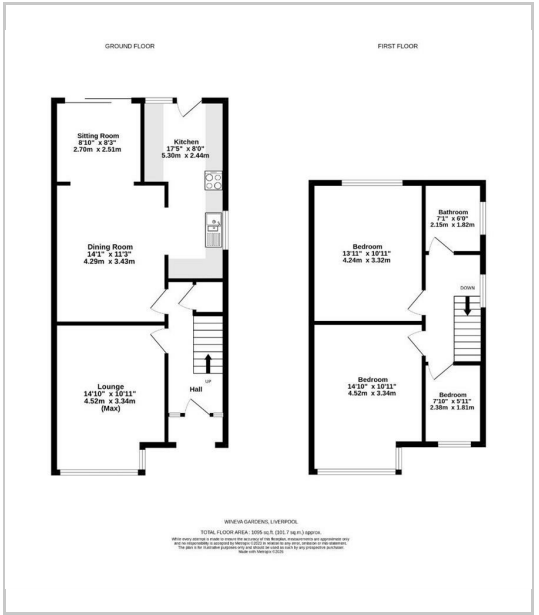

Energy Efficiency Graph

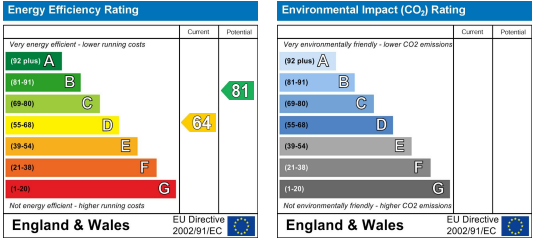

These particulars, whilst believed to be accurate are set out as a general outline only for guidance and do not constitute any part of an offer or contract. Intending purchasers should not rely on them as statements of representation of fact, but must satisfy themselves by inspection or otherwise as to their accuracy. No person in this firms employment has the authority to make or give any representation or warranty in respect of the property.

82 Coronation Road, Crosby, Liverpool L23 5RH

6 Allerton Road, Mossley Hill, Liverpool, L18 1LN

2 Chapel Lane, Formby, Liverpool, L37 4DU

Tel: 0151 909 3003

Tel: 0151 601 3003

Tel: 01704 827 402

Email: crosby@abode-group.co.uk

Email: allerton@abode-group.co.uk

Email: formby@abode-group.co.uk

Web: www.abode-group.co.uk

Web: www.abode-group.co.uk

Web: www.abode-group.co.uk