



27 Pinewood Avenue

, Formby, L37 2HY

£350,000

 3  1  1  D



27 Pinewood Avenue

, Formby, L37 2HY

£350,000



Hall

Door opening to front aspect. Opening to:

Lounge

12'1" x 18'8" (3.70 x 5.70)

Feature fireplace. Radiator. Double Glazed sliding doors opening to rear aspect.

kitchen/Diner

15'11" x 10'2" (4.86 x 3.12)

Door to side aspect. Double Glazed window to rear aspect. Radiator. A range of wall and base units. Sink and drainer unit. Breakfast bar. Space for cooker. Extractor fan.

Bedroom

11'10" x 15'2" (3.62 x 4.64)

Double Glazed window. Radiator.

2nd Bedroom

11'1" x 12'11" (3.40 x 3.94)

Double Glazed window. Radiator.

3rd Bedroom/Study

11'4" x 7'5" (3.46 x 2.27)

Double Glazed window.

Shower Room

6'1" x 6'1" (1.87 x 1.87)

Double Glazed window. Towel rail. Wash hand basin. Walk in shower unit.

w/c

Double Glazed window. Low level WC.

Garage

8'11" x 16'1" (2.74 x 4.92)

Rear Garden

Well presented and not overlooked.

Front Garden

Driveway to provide off road parking.



Road Map

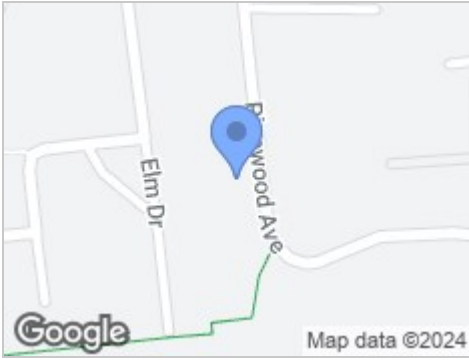

Hybrid Map



Terrain Map



Floor Plan

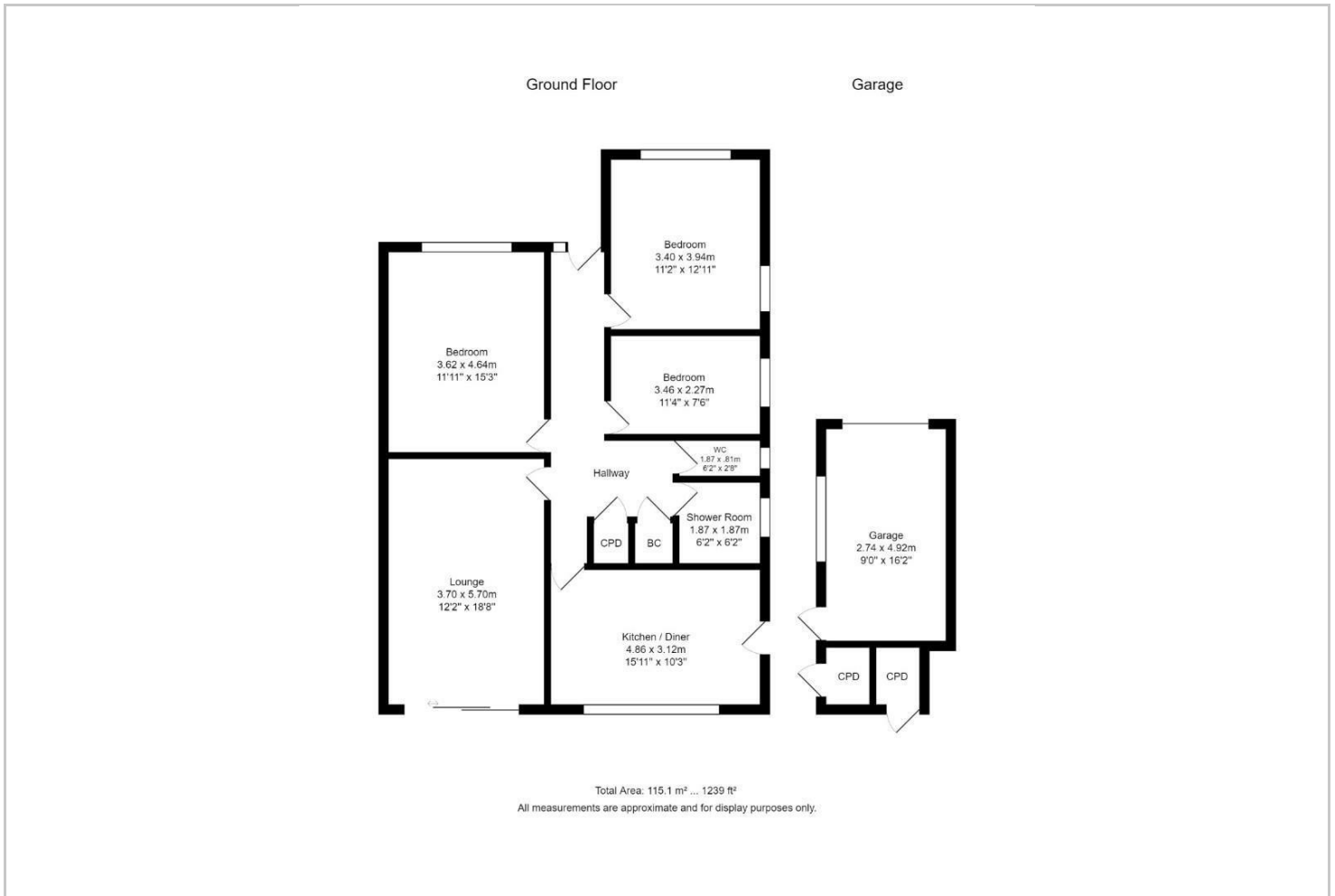

Viewing

Please contact our Formby Office on 01704827402 if you wish to arrange a viewing appointment for this property or require further information.

These particulars, whilst believed to be accurate are set out as a general outline only for guidance and do not constitute any part of an offer or contract. Intending purchasers should not rely on them as statements of representation of fact, but must satisfy themselves by inspection or otherwise as to their accuracy. No person in this firm's employment has the authority to make or give any representation or warranty in respect of the property.

Energy Efficiency Graph

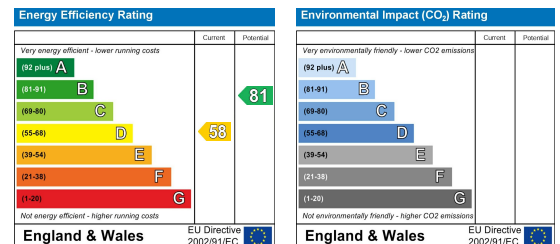

82 Coronation Road, Crosby, Liverpool L23 5RH

Tel: 0151 909 3003
Email: crosby@abode.group.co.uk
Web: www.abode-group.co.uk

6 Allerton Road, Mossley Hill, Liverpool, L18 1LN

Tel: 0151 601 3003
Email: allerton@abode-group.co.uk
Web: www.abode-group.co.uk

2 Chapel Lane, Formby, Liverpool, L37 4DU

Tel: 01704 827 402
Email: formby@abode-group.co.uk
Web: www.abode-group.co.uk